

# With Factory-Installed Grab Irons



**NEW HO Pullman Standard 10-6 Sleeper**

Walthers® Rolling Stock  
932-9381 GN  
932-9382 ATSF  
932-9383 CNW<sup>†</sup>  
932-9384 Amtrak® (Phase 1)  
932-9385 SP<sup>†</sup>

932-9386 NP  
932-9387 PRR  
932-9388 DRGW<sup>†</sup>  
932-9389 C&O  
932-9390 Rock Island  
932-9391 UP<sup>†</sup>  
932-9392 CN  
**Price: \$64.98**



**NEW HO ACF 44-Seat Streamlined Coach**

Walthers Rolling Stock  
932-6922 ATSF  
932-6923 CNW<sup>†</sup>  
932-6927 PRR

932-6928 DRGW<sup>†</sup>  
932-6929 C&O  
932-6930 Rock Island  
932-6932 NYC  
**Price: \$64.98**



**NEW HO Pullman Heavyweight 36-Seat Diner M-O-W**

Walthers Rolling Stock  
932-10170 ATSF #198629  
932-10171 BN #968018

932-10172 CP #411297  
932-10173 M-O-W #4001  
932-10174 PRR #492197  
932-10175 UP<sup>†</sup> #906206  
**Price: \$64.98**



**NEW HO ACF Heavyweight 70' Baggage Car M-O-W**

Walthers Rolling Stock  
932-10527 ATSF #190090  
932-10528 BN #976184

932-10529 CP #404910  
932-10530 M-O-W #2010  
932-10531 PRR #492457  
932-10532 UP<sup>†</sup> #903659  
**Price: \$64.98**



**HO Pullman Heavyweight 6-3 Sleeper**

Walthers Rolling Stock  
932-10414 ACL  
932-10415 Rock Island  
**Reg. Price: \$49.98 Sale: \$19.98**



**HO Budd Streamlined 46-Seat Vista Dome Coach**

Walthers Rolling Stock  
932-9094 GN (Late Cascade Green, white)  
**Reg. Price: \$54.98 Sale: \$46.98**



**HO 50' Railway Express Agency Riveted Steel Express Reefer**

Walthers Rolling Stock  
932-6241 REA (Hunter Green w/full name)  
**Reg. Price: \$31.98 Sale: \$18.98**

**More Savings!**

932-6243 REA Express  
**Reg. Price: \$31.98 Sale: \$15.98**



**HO MILW 1955 Twin Cities Hiawatha Express Car #1**

Walthers Rolling Stock  
932-9202 w/Conductor's Window #1330-36  
**Reg. Price: \$59.98 Sale: \$39.98**



**HO MILW 1955 Twin Cities Hiawatha Coach #535 Series**

Walthers Rolling Stock  
932-9208 Coach #535 Series  
**Reg. Price: \$59.98 Sale: \$39.98**



**HO Pullman-Standard Super Dome**

Walthers Rolling Stock  
932-6881 CNW<sup>†</sup>  
932-6882 CN  
932-6883 VIA Rail Canada  
932-6884 Chessie Safety Express  
**Reg. Price: \$74.98 Sale: \$63.98**



**Limited Quantity Available**

**HO Pullman Heavyweight 10-1-2 Sleeper**

Walthers Rolling Stock  
932-10563 GN  
932-10565 ACL  
932-10567 IC  
**Reg. Price: \$49.98 Sale: \$18.98**



**HO Thomas the Tank® Emily's Coach**

Bachmann  
160-76042 Emily's Coach  
**Reg. Price: \$17.50 Sale: \$12.98**

<sup>†</sup>Union Pacific licensed product

# HO SCALE | FREIGHT CARS



*Different Roadnumber Shown*

**HO 52'6" Drop End Mill Gondola w/Load - Kit**  
 PROTO 2000® w/ Walthers®  
 920-54098 WP #6799  
 w/Large Gears  
 Reg. Price: \$29.98  
 Sale: \$15.98



**Limited Quantity Available**  
**HO Wide Vision Caboose**  
 Walthers Trainline®  
 931-518 WC  
 Reg. Price: \$10.98  
 Sale: \$6.98



**HO 40' Tank Car**  
 Walthers Trainline  
 931-1613 Amoco Oil  
 931-1614 Conoco  
 Reg. Price: \$14.98  
 Sale: \$12.98



**NEW HO PS-3 Coal Hopper**  
 Walthers Trainline  
 931-1644 SP<sup>1</sup>  
 Price: \$14.98



**HO 40' Offset Quad Hopper**  
 Walthers Trainline  
 931-1650 UP<sup>1</sup>  
 931-1652 CB&Q  
 Reg. Price: \$14.98  
 Sale: \$12.98



**HO 50' Plug-Door Boxcar**  
 Walthers Trainline  
 931-1670 PRR  
 931-1673 CP  
 Price: \$14.98  
**SOO & UP on Sale!**  
 931-1671 SOO  
 931-1672 UP<sup>1</sup>  
 Reg. Price: \$14.98  
 Sale: \$12.98

<sup>1</sup>Union Pacific licensed product



**HO Track Cleaning Car**  
 Walthers Trainline  
 931-1752 CSX Transportation  
 Reg. Price: \$19.98  
 Sale: \$17.98



**HO Walthers 75th Anniversary Car**  
 Walthers Rolling Stock  
 932-95000 75th Anniversary Car  
 Reg. Price: \$24.98  
 Sale: \$11.98



**HO Greenville 7,000-Cubic Foot Wood Chip Hopper**  
 Walthers Rolling Stock  
 932-5694 NS #199483  
 932-5697 SOU #134582  
 (Boxcar Red)  
 Reg. Price: \$29.98  
 Sale: \$25.98

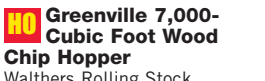

**HO Greenville 7,000-Cubic Foot Wood Chip Hopper**  
 Walthers Rolling Stock  
 932-5694 NS #199483  
 932-5697 SOU #134582  
 (Boxcar Red)  
 Reg. Price: \$29.98  
 Sale: \$25.98



**HO Hot Metal/Bottle Car**  
 Walthers Gold Line™  
**3-Pack**  
 932-3133 Painted & Numbered  
 Reg. Price: \$89.98  
 Sale: \$72.98  
**Single Car**  
 932-3134 Painted & Numbered  
 Reg. Price: \$34.98  
 Sale: \$27.98



**HO Slag Car**  
 Walthers Gold Line  
**3-Pack**  
 932-3143 Painted & Numbered  
 Reg. Price: \$89.98  
 Sale: \$76.98  
**Single Car**  
 932-3144 Painted & Numbered  
 Reg. Price: \$31.98  
 Sale: \$25.98



**NEW HO 63' Pulpwood Flatcar**  
 Walthers Gold Line  
 932-3163 CN #615247  
 932-3164 CP #304879  
 932-3165 WC #38029  
 932-3166 Georgia-Pacific  
 GPSX #456  
 932-3167 TTX #82036  
 932-3168 SOU #115588  
 Price: \$21.98



**NEW HO Greenville 100-Ton 2-Bay Hopper**  
 Walthers Gold Line  
 932-7417 Gifford Hill GIHX  
 #1540  
 932-7418 Golden West Service  
 #629125  
 932-7419 NS #150279  
 w/Conspicuity Stripes  
 932-7420 NS #150307  
 w/Conspicuity Stripes  
 932-7421 NS #150306  
 w/Conspicuity Stripes  
 932-7422 SOU #103512  
 932-7423 SOU #101220  
 932-7424 SOU #103312  
 932-7425 SP<sup>1</sup> #465031  
 932-7426 WC #34027  
 Price: \$21.98



**HO Gunderson 50' High-Cube Paper-Service Boxcar**  
 Walthers Gold Line  
 932-7122 WC #21551 (maroon)  
 932-7123 CN/GTW #406407  
 (GTW Reporting Marks, brown)  
 932-7127 Wheeling & Lake Erie  
 #30063 (brown)  
 932-7130 NOKL #570586  
 (brown)  
 932-7131 NS #473337 (brown)  
 932-7135 International Bridge  
 & Terminal #19166 (green)  
 Reg. Price: \$27.98  
 Sale: \$23.98



**HO Bethgon Coalporter Gondola 6-Pack**  
 Walthers Gold Line  
 932-40410 CN (Website)  
 Reg. Price: \$119.98  
 Sale: \$89.98



**HO 23,000-Gallon Funnel-Flow Tank Car**  
 Walthers Gold Line  
 932-7279 ADM #25704 (Leaf Logo)  
 932-7282 UTLX #67601 (black w/Conspicuity Markings)  
 932-7285 Procor/Interstate  
 Asphalt PRTX #135 (black)  
 932-7288 Procor/Chicago Board  
 of Asphalt PRTX #102 (black)  
 932-7291 Procor CGTX #23527  
 (black w/Conspicuity Markings)  
 932-7294 Procor #75565  
 (black w/Conspicuity Markings)  
 Reg. Price: \$29.98  
 Sale: \$25.98



**NEW HO USRA 46' Steel Gondola**  
 Walthers Platinum Line™  
 932-7471 PRR #315898  
 (Shadow Keystone)  
 932-7472 WM #5444 (black,  
 "Fast Freight" Logo)  
 932-7473 Erie #15519 (black,  
 white)  
 932-7474 CN #141615  
 (black, white)  
 Price: \$24.98



**HO 25' 2-Window Caboose w/Center Cupola**  
 Walthers Platinum Line  
 932-7527 C&O (red)  
 Reg. Price: \$39.98  
 Sale: \$23.98  
**More Savings!**  
 932-7529 C&O (yellow, For  
 Progress)  
 Reg. Price: \$39.98  
 Sale: \$16.98



**HO Santa Fe 1300-Series Wood Caboose (Waycar)**  
 Walthers Platinum Line  
 932-7585 A.T.S.F. Lettering;  
 1938-43  
 Reg. Price: \$39.98  
 Sale: \$23.98

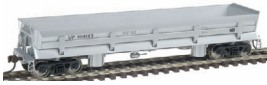

**HO Difco® Dump Car**  
Walthers® Gold Line™  
932-7901 UP<sup>1</sup>  
932-7902 DMIR  
932-7904 BNSF  
932-7905 CSX  
932-7909 DRGW<sup>1</sup>  
**Reg. Price: \$29.98**  
**Sale: \$12.98**



**HO Pullman-Standard 86' High Cube 4-Door Boxcar**  
Walthers Gold Line  
932-35021 N&W  
**Reg. Price: \$31.98**  
**Sale: \$16.98**



**HO Pullman-Standard 86' High Cube 8-Door Boxcar**  
Walthers Gold Line  
932-35314 PRR  
**Reg. Price: \$31.98**  
**Sale: \$16.98**



**NEW HO Canadian 50' Bulkhead Flatcar**  
Walthers Platinum Line™  
932-40063 IHB #18228  
932-40064 IHB #18524  
932-40065 IHB #18361  
932-40066 PGE #16138  
932-40067 Pacific Great Eastern #16004  
932-40068 PGE #16073  
932-40069 Escanaba & Lake Superior #5111  
932-40070 Escanaba & Lake Superior #5108  
932-40071 Escanaba & Lake Superior #5113  
932-40072 CN #603059  
932-40073 Duluth, Winnipeg & Pacific #605479  
932-40074 BC Rail #818455  
**Price: \$27.98**



**NEW HO 10,000-Gallon Insulated Tank Car**  
Walthers Platinum Line  
932-41753 Magnolia MPCX #1612 (black, white)  
932-41754 Magnolia MPCX #1569 (white w/black underframe & lettering)  
**Price: \$37.98**

<sup>1</sup>Union Pacific licensed product



**NEW HO Trinity 6351 4-Bay Covered Hopper**  
Walthers Platinum Line  
932-41102 North American Ethanol NAEX #20115 (green)  
932-41103 North American Ethanol NAEX #20128 (green)  
932-41104 Archer-Daniels-Midland ADMX #63234 (Leaf Logo)  
932-41105 Archer-Daniels-Midland ADMX #63349 (Leaf Logo)  
932-41106 Archer-Daniels-Midland ADMX #63496 (Leaf Logo)  
932-41107 Vera Sun Energy TILX #639817 (tan)  
932-41108 Vera Sun Energy TILX #639903 (tan)  
932-41109 Vera Sun Energy TILX #639952 (tan)  
**Price: \$37.98**



**NEW HO Thrall 89' Tri-level Enclosed Auto Carrier**  
Walthers Platinum Line  
932-41801 BNSF #303064  
932-41802 BNSF #303085  
932-41803 BNSF #303092  
932-41804 UP<sup>1</sup> Rack CNW<sup>1</sup> #2070, Flat ETTX #701557  
932-41807 TTX Rack #331007, Flat ETTX #710861  
932-41809 CP Rack #56257-23, Flat ETTX #700495  
**Price: \$37.98**



**NEW HO American Crane**  
Walthers Platinum Line  
932-41951 ATSF #199606  
932-41952 BN #975204  
932-41953 CP #414212  
932-41954 Maintenance-of-Way #X-2  
932-41955 PRR #85381  
932-41956 UP<sup>1</sup> #903056  
932-41957 Data Only (yellow)  
**Price: \$79.98**



**HO 40' Rib Side Container**  
Walthers  
933-1504 K-Line  
933-1507 Cosco  
**Reg. Price: \$8.98 Sale: \$6.98**



**HO 40' High Cube Container**  
Walthers  
933-1715 XTRA  
**Reg. Price: \$8.98 Sale: \$6.98**



**HO Bi-Level Auto Carrier**  
Walthers Gold Line  
932-40102 SP<sup>1</sup>  
932-40110 NS Rack #26072/Flat TTGX #159453 (TTX Yellow)  
932-40111 NS Rack #26248/Flat TTGX #159387 (TTX Yellow)  
932-40112 NS Rack #26053/Flat TTGX #160011 (TTX Yellow)  
932-40113 CSX Rack #B 5902/Flat TTGX #962836 (TTX Yellow, 2008 Maroon TTX Logo)  
932-40114 CSX Rack #B 3811/Flat TTGX #974164 (TTX Yellow, 2008 Maroon TTX Logo)  
932-40115 CSX Rack #B 4898/Flat TTGX #977002 (TTX Yellow, 2008 Maroon TTX Logo)  
932-40116 CP #542527 (yellow, red logo panel)

932-40117 CP #542265 (yellow, red logo panel)  
932-40118 CP #542651 (yellow, red logo panel)  
932-40119 TFM Rack #6018/Flat TTGX #987732 (TTX Yellow)  
932-40120 TFM Rack #6389/Flat TTGX #987351 (TTX Yellow)  
932-40121 TFM Rack #6734/Flat TTGX #987242 (TTX Yellow)  
932-40122 BN Rack #20011/Flat TTGX #158995 (green rack, yellow flat)  
932-40123 BN Rack #20020/Flat TTGX #159174 (green rack, yellow flat)  
932-40124 BN Rack #20892/Flat TTGX #971176 (green rack, yellow flat)  
**Reg. Price: \$44.98**  
**Sale: \$35.98**



**HO 48' Stoughton Smoothside Container**  
Walthers  
933-1811 ATSF  
**Reg. Price: \$8.98 Sale: \$5.98**



**HO 20' Corrugated Container**  
Walthers  
933-2016 Hapag-Lloyd  
933-2017 China Shipping  
933-2018 Mississippi Central  
933-2019 Hamburg Sud  
**Reg. Price: \$6.98 Sale: \$5.49**



**HO 48' Stoughton Ribside Exterior Post Container**  
Walthers  
933-1819 J.B. Hunt  
**Reg. Price: \$8.98 Sale: \$5.98**



**HO 40' Hi-Cube Fully Corrugated Box Container**  
Walthers  
933-2051 APL  
933-2052 K-Line  
933-2057 OOCL  
933-2061 Capitol  
933-2063 China Shipping  
933-2064 TEX  
933-2065 APL (No Eagle)  
933-2066 OOCL  
933-2068 Amficon  
**Reg. Price: \$8.98 Sale: \$5.98**



**HO 40' Reefer Container**  
Walthers  
933-1854 Evergreen  
933-1857 Dole  
**Reg. Price: \$8.98 Sale: \$5.98**



**HO 20' Tank Container - Kit**  
Walthers  
933-1963 Hoyer  
933-1966 Miller International Logistics  
**Reg. Price: \$8.98 Sale: \$5.98**  
**More Savings!**  
933-1953 SEACO  
**Reg. Price: \$8.98 Sale: \$6.98**



**HO 1970s-Era 40' Smooth-Side Container**  
Walthers  
933-2151 Seatrain  
933-2152 OOCL  
933-2154 United States Lines  
933-2155 Showa  
933-2156 Sea-Land  
933-2157 Maersk  
933-2158 K-Line  
**Reg. Price: \$6.98 Sale: \$5.98**

# HO SCALE | FREIGHT CARS



## HO Larry & Quench Car - Kit

Walthers® Cornerstone Series®. Kit includes a larry car for charging the ovens and a quench car for moving hot coke to the quench tower. 933-2964 Larry & Quench Cars  
**Reg. Price: \$65.98**  
**Sale: \$54.98**



## HO 50' Bi-Level Auto Carrier w/6 Cars

Life-Like from Walthers 433-8303 ATSF/Trailer Train  
**Reg. Price: \$15.98**  
**Sale: \$11.98**



## HO AAR 41' Steel Gondola - Kit

Accurail 112-3729 SLSF "Frisco" 112-3731 NH  
**Reg. Price: \$15.98**  
**Sale: \$11.98**



## HO USRA 40' Double-Sheathed Wood Boxcar - Kit

Accurail 112-4636 D&H (Boxcar Red, The D&H) 112-46241 Spokane, Portland & Seattle (Boxcar Red)  
**Reg. Price: \$13.98**  
**Sale: \$11.98**



## HO 40' Wood Stock Car - Kit

Accurail 112-4733 Virginian  
**Reg. Price: \$13.98**  
**Sale: \$11.98**



## NEW HO AAR 50' Riveted Plug-Door Boxcar - Kit

Accurail 112-5128 Monon/Fruit Growers Express RBNX #90269  
**Reg. Price: \$13.98**  
**Sale: \$11.98**



## NEW HO PS-1 40' Boxcar Door & HGC Trucks

Kadee 380-5298 SSW #35240  
**Reg. Price: \$32.95**  
**Sale: \$29.98**



## NEW HO PS-1 50' Boxcar w/10' Door & HGC Trucks

Kadee 380-6343 GN #39817  
**Reg. Price: \$35.95**  
**Sale: \$31.98**



## NEW HO PS2 2-Bay Covered Hopper

Kadee 380-8647 B&O #8647  
**Reg. Price: \$42.95**  
**Sale: \$38.98**

*Faster Check-Out Options at [www.walthers.com!](http://www.walthers.com!)*



## HO Fairmont Speeder - Kit

Durango Press 254-37 MT-14 1950s On  
**Reg. Price: \$9.95** **Sale: \$8.98**



## HO 3-in-1 Mill Gondola 3-Pack - Kit

State Tool & Die 661-775 3-in-1 Mill Gondola  
**Reg. Price: \$26.90**  
**Sale: \$21.98**

# HO SCALE | DECALS | COUPLERS | TRUCKS

## Decal Setting Solution

Walthers 904-470 Solvaset 2oz  
**Reg. Price: \$5.49**  
**Sale: \$4.98**



## HO Knuckle Couplers

PROTO 2000 from Walthers 920-21095 1 Pair  
**Reg. Price: \$4.49** **Sale: \$3.49**



## HO Barber S-2 100-Ton Freight Car Trucks

PROTO 2000 from Walthers 920-21256 w/36" Wheelsets 1 Pair  
**Reg. Price: \$7.98** **Sale: \$4.29**



## HO Metal Wheelsets w/Plastic Axles

Walthers 933-383 36" Wheels pkg(4)  
**Reg. Price: \$6.98** **Sale: \$5.49**



## HO Metal Wheelsets

PROTO 2000® from Walthers 920-21257 36" Flat Back pkg(12)  
**Reg. Price: \$11.98**  
**Sale: \$8.98**



## HO National B-1 Freight Car Trucks 1 Pair

PROTO 2000 from Walthers 920-21254 w/33" Ribbed Back Wheel Sets  
**Reg. Price: \$7.98** **Sale: \$5.98**  
 920-21255 w/33" Flat-Back Wheel Sets  
**Reg. Price: \$7.98** **Sale: \$4.29**



## HO Andrews Freight Car Trucks

PROTO 2000 from Walthers 920-23207 w/33" Flat Back Wheelsets 1 Pair  
**Reg. Price: \$7.98** **Sale: \$4.98**



## HO Rigid Plastic Freight Car Trucks

Walthers 933-1007 Roller Bearing w/Metal Wheels 1 Pair  
**Reg. Price: \$8.98** **Sale: \$6.98**



## HO E-Z Mate Mark II Couplers 12 Pair

Bachmann 160-78025 Medium Center Shank 160-78028 Medium Under Shank  
**Reg. Price: \$1.92** **Sale: \$1.41**



**HO Athearn Geared Diesel Half-Axle Nickel-Silver Wheels**  
Northwest Short Line  
53-371414 40"/110 Inside Frame pkg(12)  
Reg. Price: \$12.95  
Sale: **\$10.98**

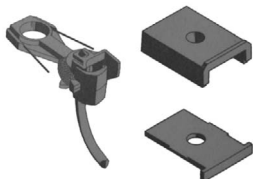

**HO Standard Head All-Metal Whisker® Self-Centering Knuckle Couplers**  
Kadee  
380-143 Short Centerset Shank 2 Pair  
Reg. Price: \$3.95 Sale: **\$3.59**



**HO Bettendorf Trucks**  
Kadee  
380-500 Standard 1 Pair  
Reg. Price: \$6.90 Sale: **\$5.98**

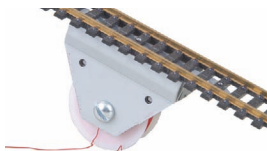

**HO Under-Track Electric Uncoupler**  
Kadee  
380-309 Under-Track Electric Uncoupler  
Reg. Price: \$16.95  
Sale: **\$14.98**



**HO Freight Car Wheelsets pkg(12)**  
Kadee  
380-523 33" Ribbed Back  
380-524 28" Smooth Back  
Reg. Price: \$8.50 Sale: **\$7.69**



**HO #5 Universal Magne-Matic® Couplers**  
Kadee  
380-3 2 Pair  
Reg. Price: \$5.80 Sale: **\$5.29**



**HO #148 Standard Head All-Metal Whisker Self-Centering Knuckle Couplers**  
Kadee  
380-14 25 Pair  
Reg. Price: \$39.95  
Sale: **\$35.98**

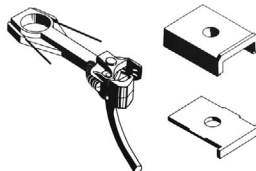

**HO Scale Head All-Metal Whisker Self-Centering Knuckle Couplers**  
Kadee  
380-156 Long 2 Pair  
Reg. Price: \$3.95 Sale: **\$3.59**



**HO Coupler Height Gauge**  
Kadee  
380-205 Coupler Height Gauge  
Reg. Price: \$5.95 Sale: **\$5.29**

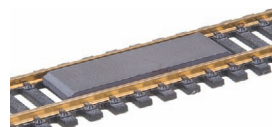

**HO Permanent Magnet Delayed Uncoupler**  
Kadee  
380-321 For Code 100 Track pkg(2)  
Reg. Price: \$5.15 Sale: **\$4.49**



**HO A3 Trucks**  
Kato  
381-31601 ASF Ride Control pkg(2)  
Reg. Price: \$5.98 Sale: **\$4.98**

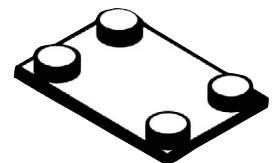

**HO Totally Hidden Uncoupler Starter Set**  
S&L Enterprises  
637-2 Totally Hidden Uncoupler Starter Set  
Reg. Price: \$6.95 Sale: **\$5.98**



**Always Connected**

**WALTHERS**

**Flyer Alert**

**Walters Flyer Alert**  
Immediate email when the latest issue goes online!

**E-Update**

**Walters E-Update™**  
New arrivals, previews, special sale items & modeling tips!

**N-thusiast**

**N-Thusiast E-Flyer**  
N Scale items for every railroad!

**LARGE SCALER**

**Large Scaler E-Flyer**  
Great O, S and G Scale items!

**The Bargain Depot**

**The Bargain Depot**  
Savings that can't be beat!

**Find us on Facebook**

**Facebook**  
Join Walters online modeling community!



**Walters.com**

New products, special offers, technical resources, hobby shop locator, videos and much more.

With our Web site, E-alerts and Facebook page you'll always be connected to your number one resource for model railroad product information.

Check out all our E-features at **walters.com/signup**

## HO Operating Ground Throw

Caboose Industries  
97-204 High Level Switch Stand  
Reg. Price: \$7.25  
Sale: **\$6.29**  
97-5202 5-Pack  
Reg. Price: \$15.50  
Sale: **\$13.98**



## HO Transition Rail Joiners

Atlas  
150-551 Code 83 to Code 100 pkg(12)  
Reg. Price: \$3.95 Sale: **\$3.24**



## HO Code 83 #6 Turnout

Atlas  
150-505 Left Hand  
150-506 Right Hand  
Reg. Price: \$21.95  
Sale: **\$17.98**



## HO E-Z Track® Expander Set

Bachmann. Add to your train set track or create new configurations of turnouts, branchlines, and double-track mainlines on your existing railroad. Features 12 pieces of snap-fit E-Z Track. 160-44594 E-Z Track Expander Set  
Reg. Price: \$95.00  
Sale: **\$68.98**



## HO Straight E-Z Track w/Nickel Silver Rail & Gray Roadbed

Bachmann  
160-44510 9" Terminal Rerailer  
Reg. Price: \$10.25  
Sale: **\$7.29**  
160-44511 9" Straight pkg(4)  
Reg. Price: \$13.50  
Sale: **\$9.98**



## HO Curved E-Z Track w/Nickel Silver Rail & Gray Roadbed

Bachmann  
160-44501 18" Radius Curve pkg(4)  
Reg. Price: \$13.50  
Sale: **\$9.98**  
160-44502 18" Radius Curve w/Terminal & Rerailer  
Reg. Price: \$10.25  
Sale: **\$6.98**  
160-44503 22" Radius Curve pkg(4)  
Reg. Price: \$18.50  
Sale: **\$12.98**  
160-44504 33-1/4" Radius 18 Degree Curve pkg(5)  
Reg. Price: \$20.00  
Sale: **\$14.98**  
160-44505 15" Radius Curve pkg(4)  
Reg. Price: \$14.50  
Sale: **\$10.98**

## HO Switch Stand

Central Valley  
210-1604 Switch Stand pkg(6)  
Reg. Price: \$6.25  
Sale: **\$5.49**



## HO Standard Gauge Flex-Track™

Micro Engineering  
**Nonweathered**  
255-10106 Code 70 Rail 3' Section pkg(6)  
Reg. Price: \$32.95  
Sale: **\$29.98**  
**Weathered**  
255-12106 Code 70 Rail 3' Section pkg(6)  
Reg. Price: \$34.55  
Sale: **\$31.49**

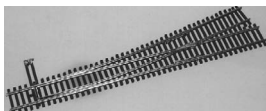

## HO Code 83 Nickel Silver Rail Flex-Track Turnout

Micro Engineering  
255-14705 #6 Left-Hand  
Reg. Price: \$20.95  
Sale: **\$18.98**

## HO Cork Roadbed

Midwest Products  
472-3015 3' Section pkg(5)  
Reg. Price: \$9.95  
Sale: **\$7.98**

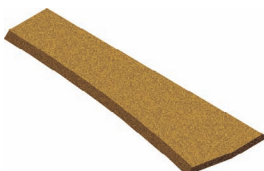
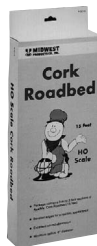

## HO Beveled Switch Pad 1 Pair

Midwest Products  
472-3022 #4/#6 Right Hand Turnout  
472-3023 #4/#6 Left Hand Turnout  
Reg. Price: \$6.98 Sale: **\$5.49**  
472-3024 #4/#6 Wye Turnout  
Reg. Price: \$5.19 Sale: **\$4.29**



## HO Operating Switch Stand

NJ International  
525-1914 Low Rampo Type  
Reg. Price: \$8.99 Sale: **\$7.98**



## HO Blue Point™ Turnout Controller

New Rail Models. Includes two sets of electrical contacts for frog, signals or other electronics dependent on the turnout position. 501-4001810 Blue Point Turnout Controller pkg(10)  
Reg. Price: \$109.95  
Sale: **\$99.98**



## HO Code 100 Turnout

Peco  
552-90 Insulfrog Double Slip  
Reg. Price: \$74.99  
Sale: **\$67.98**



## HO Code 100 Streamline Curved Double Radius Turnout

Peco  
552-1910 Right Hand Electrofrog  
552-1911 Left Hand Electrofrog  
Reg. Price: \$26.99  
Sale: **\$23.98**



## HO Code 100 Streamline Small Radius Turnout

Peco  
552-1903 Right Hand Electrofrog  
552-1904 Left Hand Electrofrog  
Reg. Price: \$19.99  
Sale: **\$15.98**



## HO Code 100 Streamline Medium Radius Turnout

Peco  
552-1051 Right Hand Insulfrog  
Reg. Price: \$21.99  
Sale: **\$17.98**

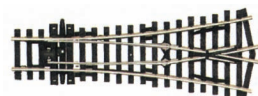

## HO Code 100 Streamline Wye Turnout

Peco  
552-1053 Small Radius Insulfrog  
Reg. Price: \$19.99  
Sale: **\$17.98**



## HO North American-Style Code 83 Hayes Bumper

Peco  
552-SL8340 Hayes Bumper pkg(2)  
Reg. Price: \$4.99 Sale: **\$3.98**



## HO Streamline Code 83 Track Pins

Peco  
552-SL8314 Nails 1/4oz 7g  
Reg. Price: \$3.75 Sale: **\$3.08**

**HO Streamline Code 83 No.6 Nickel Silver Turnout**  
Peco  
552-SL8361 Right Hand Insulfrog  
552-SL8362 Left Hand Insulfrog  
**Reg. Price: \$31.99**  
**Sale: \$25.98**



**HO Streamline Code 83 No.5 Nickel Silver Turnout**  
Peco  
552-SL8351 Right Hand Insulfrog  
552-SL8352 Left Hand Insulfrog  
**Reg. Price: \$31.99**  
**Sale: \$25.98**



**HO Streamline Code 83 #6 Nickel Silver Turnout**  
Peco  
552-SLE8361 Right Hand Electrofrog  
552-SLE8362 Left Hand Electrofrog  
**Reg. Price: \$31.99** **Sale: \$25.98**



**HO Rail-It Rix 628-2 Rail-It**  
**Reg. Price: \$3.49** **Sale: \$2.98**



**Turnout Control Switch**  
Kato  
381-24840 Turnout Control Switch  
**Reg. Price: \$8.50** **Sale: \$6.98**



**Nickel Silver Rail Joiners**  
Micro Engineering  
255-26083 Code 83 pkg(50)  
**Reg. Price: \$7.95** **Sale: \$6.98**

**ANY IN STOCK PRODUCT FROM OUR 2011 HO REFERENCE BOOK IS JUST A PHONE CALL AWAY!**  
**To Order Call 1-800-4TRAINS**

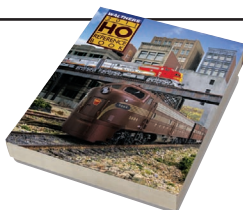

## HO SCALE | SIGNALS | SIGNS

**HO Single Sided Traffic Light**  
Walthers®  
Cornerstone Series®  
933-2300 Single Sided Traffic Light  
**Reg. Price: \$14.98**  
**Sale: \$11.98**



**HO Double-Sided Traffic Light**  
Walthers  
Cornerstone Series  
933-2301 Double-Sided Traffic Light  
**Reg. Price: \$18.98**  
**Sale: \$14.98**



**HO Hanging Single-Sided Traffic Light**  
Walthers Cornerstone Series  
933-2302 Hanging Single-Sided Traffic Light  
**Reg. Price: \$12.98**  
**Sale: \$7.98**



**HO Pneumatic Crossing Gate**  
Walthers Cornerstone Series  
933-2312 Pneumatic Crossing Gate pkg(2)  
**Reg. Price: \$29.98**  
**Sale: \$19.98**



**HO Cantilever Style Grade Crossing Signal**  
Walthers Cornerstone Series  
933-2303 Modern Two-Lane  
**Reg. Price: \$43.98**  
**Sale: \$31.98**



**HO Post-60s Grade Crossing Signal**  
Walthers Cornerstone Series  
933-2314 Cantilever Style  
**Reg. Price: \$32.98**  
**Sale: \$27.98**



**HO Traffic Light Controller**  
Walthers Cornerstone Series  
933-2306 Traffic Light Controller  
**Reg. Price: \$39.98**  
**Sale: \$29.98**

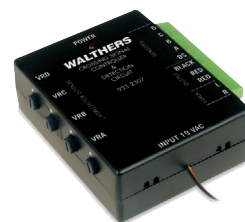

**HO Crossing Signal Controller**  
Walthers Cornerstone Series  
933-2307 Crossing Signal Controller  
**Reg. Price: \$39.98**  
**Sale: \$29.98**



**HO Street & Highway Signs**  
SceneMaster™ from Walthers  
433-1602 Street & Highway Signs  
**Reg. Price: \$8.98** **Sale: \$6.98**



**HO Switchman w/Lighted Building**  
Life-Like from Walthers  
433-8203 Compatible w/Conventional Track  
433-8310 Compatible w/Power-Loc™ Track  
**Reg. Price: \$21.98**  
**Sale: \$16.98**

**HO Vertical Signal**  
Tomar  
81-856 Three-Light w/LEDs  
**Reg. Price: \$23.90**  
**Sale: \$20.98**



**HO Vertical Signal**  
Tomar  
81-857 Two-Light  
**Reg. Price: \$20.90**  
**Sale: \$17.98**

**HO Dwarf Signal**  
Tomar  
81-847 Two Light (Yellow Over Red)  
**Reg. Price: \$10.30**  
**Sale: \$8.98**



**HO Type "G" 3-Light Signal**  
Atlas. Includes control board and two-rail analog block detector.  
150-236 Single Target  
**Reg. Price: \$68.95**  
**Sale: \$56.98**  
150-237 Single Target 4-Pack  
**Reg. Price: \$137.50**  
**Sale: \$109.98**  
150-239 Single Target Bi-Directional  
**Reg. Price: \$54.95**  
**Sale: \$44.98**



**HO Crossing Signal & Gate**  
 Bachmann  
 160-42200 Crossing Signal & Gate pkg(12)  
 Reg. Price: \$8.50 Sale: **\$5.98**



**HO Signal Bridge**  
 Bachmann  
 160-45134 Signal Bridge  
 Reg. Price: \$14.00  
 Sale: **\$9.98**

**HO Modern Single Pole Block Signal**  
 BLMA  
 176-4035  
 Dual Head  
 Reg. Price: \$44.95  
 Sale: **\$39.98**



**HO Modern Hooded Signal Head**  
 BLMA  
 176-4039 Modern Hooded Signal Head pkg(2)  
 Reg. Price: \$19.95  
 Sale: **\$17.98**



**NEW HO Vintage Feed & Seed Signs**  
 Blair Line  
 184-135 Vintage Feed & Seed Signs  
 Reg. Price: \$5.00 Sale: **\$4.49**

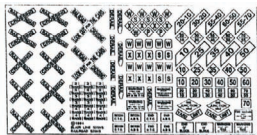

**HO Railroad Signs**  
 Blair Line  
 184-101 1900-Present  
 Reg. Price: \$5.00 Sale: **\$4.49**

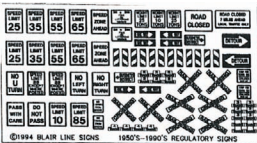

**HO Regulatory Highway Signs #1**  
 Blair Line  
 184-102 1949-Present  
 Reg. Price: \$5.00 Sale: **\$4.49**



**HO Main Street Storefront Signs III**  
 Blair Line  
 184-158 Main Street Storefront Signs III  
 Reg. Price: \$5.00 Sale: **\$4.49**



**HO Food Advertising Signs**  
 City Classics  
 195-5015 For Window Interiors  
 Reg. Price: \$3.00 Sale: **\$2.69**

**HO Men At Work Sign**  
 Details West  
 235-451 Men At Work Sign  
 Reg. Price: \$1.95  
 Sale: **\$1.69**

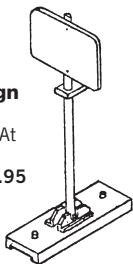

**HO Concrete Mile Post Markers #1**  
 Tichy  
 293-8184 Concrete Mile Post Markers #1 pkg(50)  
 Reg. Price: \$7.95 Sale: **\$6.98**

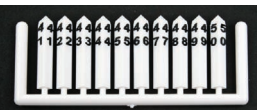

**HO Sidewalk Lattice Billboards**  
 JL Innovative Design  
 361-277 Sidewalk Lattice Billboards  
 Reg. Price: \$8.29 Sale: **\$7.49**



**HO 1940s-50s Industrial Signs**  
 JL Innovative Design  
 361-292 1940s-50s Industrial Signs pkg(39)  
 Reg. Price: \$3.99 Sale: **\$3.49**



**HO Turn of the Century Signs**  
 JL Innovative Design  
 361-295 Set #4 1890s-1920s  
 Reg. Price: \$3.99 Sale: **\$3.49**



**HO 1940s-50s Farm & Tractor Signs**  
 JL Innovative Design  
 361-296 1940s-50s Farm & Tractor Signs pkg(31)  
 Reg. Price: \$3.99 Sale: **\$3.49**



**HO Vintage Soft Drink Posters & Signs**  
 JL Innovative Design  
 361-197 1930s-1960s pkg(72)  
 Reg. Price: \$3.99 Sale: **\$3.49**



**HO Gas Station Posters & Signs**  
 JL Innovative Design  
 361-284 1940s-1960s Series II pkg(55)  
 Reg. Price: \$3.99 Sale: **\$3.49**



**HO Vintage Motor Oil Signs**  
 JL Innovative Design  
 361-294 1930-50s pkg(38)  
 Reg. Price: \$3.99 Sale: **\$3.49**



**HO Yard Limit Sign**  
 JL Innovative Design  
 361-848 Yard Limit pkg(2)  
 Reg. Price: \$5.98 Sale: **\$4.98**

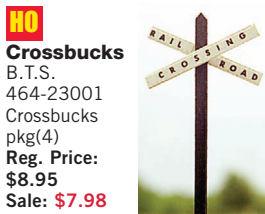

**HO Crossbucks**  
 B.T.S.  
 464-23001  
 Crossbucks pkg(4)  
 Reg. Price: \$8.95  
 Sale: **\$7.98**



**HO Mobile Highway Sign**  
 Miniaturics. With 3V DC transformer.  
 475-8500101 Caution Construction Ahead  
 Reg. Price: \$31.95  
 Sale: **\$28.98**



**HO Stop Sign Set - Kit**  
 S & S Hobby  
 643-300 Stop Sign Set pkg(12)  
 Reg. Price: \$8.99 Sale: **\$7.98**



**HO Roof Top Animated Neon Billboard**

Micro Structures  
502-5681 Bus Station  
Reg. Price: \$38.95  
Sale: **\$34.98**



**HO N&W Animated Neon Billboard**

Micro Structures  
502-3281 Norfolk & Western  
Roanoke Shops  
Reg. Price: \$42.95  
Sale: **\$39.98**



**HO Pabst Animated Neon Billboard**

Micro Structures  
502-4081 Pabst Blue Ribbon  
Reg. Price: \$55.95  
Sale: **\$49.98**



**HO Texaco Animated Neon Billboard**

Micro Structures  
502-5181 Texaco  
Reg. Price: \$52.95  
Sale: **\$46.98**



**HO UP Animated Neon Billboard**

Micro Structures  
502-3781 Union Pacific Railroad  
Reg. Price: \$49.95  
Sale: **\$44.98**



**HO Reddy Kilowatt Animated Neon Billboard**

Micro Structures  
502-3681 Reddy Kilowatt  
Reg. Price: \$49.95  
Sale: **\$44.98**



**HO The Milwaukee Road Animated Neon Billboard**

Micro Structures  
502-1071 Large 4-5/32 x 4-1/2"  
Reg. Price: \$45.95  
Sale: **\$39.98**  
502-1072 Small 2-7/64 x 2-1/4"  
Reg. Price: \$29.95  
Sale: **\$26.98**



**HO Budweiser Animated Neon Billboard**

Micro Structures  
502-4981 Budweiser Beer  
Reg. Price: \$49.95  
Sale: **\$44.98**



**HO Bethlehem Steel Animated Neon Billboard**

Micro Structures  
502-5281 Bethlehem Steel  
Reg. Price: \$36.95  
Sale: **\$32.98**

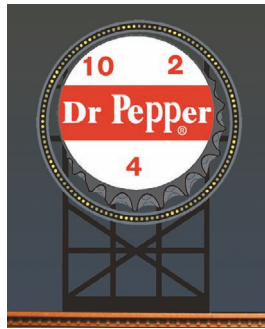

**Dr. Pepper Animated Neon Billboard**

Micro Structures  
502-2681 Dr. Pepper  
Reg. Price: \$32.95  
Sale: **\$29.98**

**NEW HO**

**B&O Style Signal**

NJ International  
525-1216  
6 LED Disc Head Only  
Reg. Price: \$19.99  
Sale: **\$17.98**



**HO GRS SC Type Dwarf Signal**

NJ International  
525-1297 Red & Green LEDs (black)  
Reg. Price: \$24.99  
Sale: **\$21.98**



**HO Crossing Flashers - Kit**

Oregon Rail Supply  
538-113 Crossing Flashers pkg(2)  
Reg. Price: \$17.95  
Sale: **\$14.98**



**HO PRR Position Light Signal - Kit**

Oregon Rail Supply  
538-117 Intermediate  
Reg. Price: \$17.95  
Sale: **\$14.98**

**HO Searchlight Signal Light Target**

Oregon Rail Supply  
538-102 Single pkg(3)  
Reg. Price: \$4.50  
Sale: **\$3.98**  
538-103 Double pkg(3)  
Reg. Price: \$4.95  
Sale: **\$3.98**



**HO Single Signal - Kit**  
Oregon Rail Supply  
538-125 Single Signal  
Reg. Price: \$10.95  
Sale: **\$8.98**



**HO Two-Target Single Signal - Kit**  
Oregon Rail Supply  
538-127 Two-Target Single Signal  
Reg. Price: \$16.95  
Sale: **\$13.98**



**HO Double Light Dwarf Signal - Kit**  
Oregon Rail Supply  
538-123 Double Light Dwarf Signal pkg(2)  
Reg. Price: \$7.50  
Sale: **\$6.29**

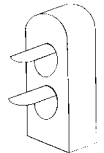

**Tortoise™ Gate/Semaphore Actuator**  
Circuitron. Mounting bracket and mechanism utilize the Tortoise (not included) and a special drive wire cable assembly to remotely actuate any crossing gate, train order or semaphore signal having a vertical control wire extending below the layout. Adjustable for all scales. 800-8100 Gate/Semaphore Actuator  
Reg. Price: \$12.95  
Sale: **\$10.98**

# HO SCALE | SIGNALS | SIGNS

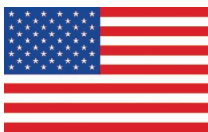

**HO US Flag, Pole & Base - Kit**  
Stewart Products  
683-950 50 Star pkg(3)  
Reg. Price: \$7.65 Sale: **\$6.98**

**HO Tortoise Extra Cable & Actuator**  
Circuitron  
800-8101 Tortoise  
Extra Cable &  
Actuator  
Reg. Price: \$6.95  
Sale: **\$5.98**

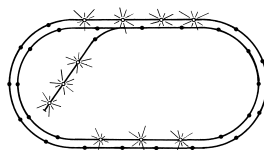
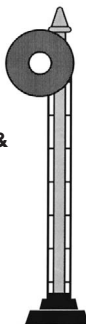

**DT-4 Rolling Stock Detection Unit**  
Circuitron  
800-5204 DT-4 Rolling Stock  
Detection Unit  
Reg. Price: \$44.95  
Sale: **\$39.98**

**DT-2 Grade Crossing Detection Unit**

Circuitron  
800-5202  
DT-2 Grade  
Crossing  
Detection Unit  
Reg. Price:  
**\$46.95**  
Sale: **\$39.98**

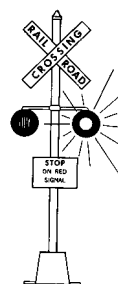

# HO SCALE | STRUCTURES



**HO Bridge & Trestle Set - Kit**  
Walthers® Trainline®  
931-802 Bridge & Trestle Set  
Reg. Price: \$14.98  
Sale: **\$9.98**



**HO Wood Coaling Tower - Kit**  
Walthers Cornerstone Series.  
7-1/2 x 6-1/2 x 10-5/8"  
19.5 x 16.5 x 26.9cm  
933-2922 Wood Coaling Tower  
Reg. Price: \$60.98  
Sale: **\$46.98**



**HO Farmers Cooperative Rural Grain Elevator - Kit**  
Walthers Cornerstone Series.  
Elevator: 8-7/8 x 7-1/4 x 10"  
22 x 18.1 x 4cm, Shed:  
7 x 4-1/2" 17.5 x 11.2cm  
933-3036 Farmers Cooperative  
Rural Grain Elevator  
Reg. Price: \$35.98  
Sale: **\$31.98**

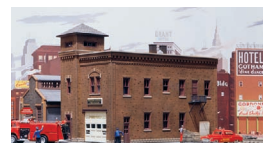

**HO Western Avenue Fire Station - Kit**  
Walthers Cornerstone Series  
933-3037 Western Avenue Fire  
Station  
Reg. Price: \$24.98  
Sale: **\$18.98**



**HO Wallschlagler Motors - Assembled**  
Walthers Trainline. 5-1/4 x 5 x  
3-1/2" 13.3 x 12.7 x 8.8cm  
931-805 Wallschlagler Motors  
Reg. Price: \$29.98  
Sale: **\$19.98**



**HO Whitehall Station - Kit**  
Walthers Cornerstone  
Series. 18-1/2 x 5-1/2 x 3-3/16"  
46.9 x 13.9 x 8cm  
933-2932 Whitehall Station  
Reg. Price: \$54.98  
Sale: **\$29.98**



**HO Sunrise Feed Mill - Kit**  
Walthers Cornerstone  
Series. 4 x 15-1/8 x 7-3/4"  
10 x 37.8 x 19.3cm  
933-3061 Sunrise Feed Mill  
Reg. Price: \$32.98  
Sale: **\$24.98**



**HO 3- Stall Roundhouse - Kit**  
Walthers Cornerstone Series.  
14 x 14-1/4 x 4-11/16"  
35.5 x 36.1 x 11.9cm;  
10 Degree Stall Spacing  
933-3041 3- Stall Roundhouse  
Reg. Price: \$49.98  
Sale: **\$39.98**



**HO Mission-Style Freight House - Kit**  
Walthers Cornerstone Series®.  
9-1/2 x 6-1/2 x 2-1/2"  
933-2921 Mission-Style  
Freight House  
Reg. Price: \$38.98  
Sale: **\$14.98**



**HO Silver Springs Bus Terminal - Kit**  
Walthers Cornerstone Series  
933-2934 Silver Springs Bus  
Terminal  
Reg. Price: \$49.98  
Sale: **\$32.98**



**HO New River Mining Company - Kit**  
Walthers Cornerstone Series.  
Main Building: 12-1/2 x 9 x  
9-3/8" 31.2 x 22.5 x 23.2cm  
933-3017 New River Mining  
Company  
Reg. Price: \$43.98  
Sale: **\$37.98**



**HO Stock Yard - Kit**  
Walthers Cornerstone Series.  
9 x 7" 22.8 x 17.7cm  
933-3047 Parts for Two Pens  
Reg. Price: \$32.98  
Sale: **\$24.98**



**HO Interstate Fuel & Oil - Kit**  
Walthers Cornerstone Series  
933-3006 Interstate Fuel & Oil  
Reg. Price: \$41.98  
Sale: **\$29.98**



**HO Bridge Pier - Kit**  
Walthers Cornerstone  
Series. 5-3/8 x 1-1/8 x 3-3/8"  
13.7 x 2.9 x 8.6cm  
933-1041 For Double-Track  
Truss Bridge  
Reg. Price: \$16.98  
Sale: **\$12.98**



**HO Double-Track Truss Bridge - Kit**  
Walthers Cornerstone Series.  
15 x 5 x 4-1/4"  
37.5 x 12.5 x 10.6cm  
933-3012 Double-Track Truss  
Bridge  
Price: **\$30.98**



**HO Big Grain Storage Bin - Kit**

Walthers® Cornerstone Series®.  
Base: 5-1/2" 13.9cm Diameter  
933-3123 Big Grain Storage Bin  
Price: **\$21.98**



**HO Sawmill Outbuildings - Kit**

Walthers Cornerstone Series  
933-3144 Sawmill Outbuildings  
Price: **\$49.98**



**HO Trestle w/Deck Girder Bridge - Kit**

Walthers Cornerstone Series.  
15-1/2 x 4 x 4"  
933-3147 Trestle w/Deck Girder Bridge  
Reg. Price: **\$29.98**  
Sale: **\$22.98**



**HO Single Track Truss Bridge - Kit**

Walthers Cornerstone Series.  
20 x 3-1/4 x 5"  
50 x 8.1 x 12.5cm  
933-3185 Single Track Truss Bridge  
Reg. Price: **\$32.98**  
Sale: **\$25.98**



**HO Don's Mower & Saw Service - Kit**

Walthers Cornerstone Series  
Lasercut. 4-1/2 x 2 x 2-1/2"  
11 x 5.4 x 6.5cm  
933-3320 Don's Mower & Saw Service  
Reg. Price: **\$41.98**  
Sale: **\$36.98**



**HO Macon's - Kit**

Walthers Cornerstone Series  
Lasercut. 3-1/2 x 2-1/2 x 2-1/2"  
8.9 x 6.6 x 6.5  
933-3321 Macon's  
Reg. Price: **\$27.98**  
Sale: **\$24.98**



**HO Midtown Oil - Kit**

Walthers Cornerstone Series  
Lasercut. 5 x 3-1/2 x 2-1/2"  
12.7 x 8.7 x 6.2cm  
933-3322 Midtown Oil  
Reg. Price: **\$54.98**  
Sale: **\$47.98**



**HO Lakeshore Coal & Ice - Kit**

Walthers Cornerstone Series  
Lasercut. 4-3/4 x 3 x 2-3/4"  
12 x 7.1 x 7cm  
933-3323 Lakeshore Coal & Ice  
Reg. Price: **\$32.98**  
Sale: **\$28.98**



**HO Redlon Welding - Kit**

Walthers Cornerstone Series  
Lasercut. 6-3/4 x 3-1/2 x 3"  
17.3 x 9.2 x 7.3cm  
933-3324 Redlon Welding  
Reg. Price: **\$54.98**  
Sale: **\$47.98**



**HO Quality Woodwork - Kit**

Walthers Cornerstone Series  
Lasercut. 6 x 2-3/4 x 3"  
14.9 x 7 x 7.9cm  
933-3325 Quality Woodwork  
Reg. Price: **\$43.98**  
Sale: **\$38.98**



**NEW HO Station Platforms - Kit**

Walthers Cornerstone Series.  
11-3/4 x 2-1/4 x 2/5/8"  
29.8 x 5.7 x 6.6cm  
933-3391 Four Sections  
Price: **\$39.98**

**HO Modern Water Tower - Kit**

Walthers Cornerstone Series.  
9-1/2" Tall x  
3-1/8" Diameter  
23.7 x 7.8cm  
933-3528 Modern Water Tower  
Price: **\$24.98**



**HO Golden Valley Depot - Assembled**

Walthers Cornerstone Series  
Built-ups. 6-1/2 x 3-3/8"  
16.2 x 8.4cm  
933-2806 Golden Valley Depot  
Reg. Price: **\$38.98**  
Sale: **\$29.98**



**HO Modern 3-Stall Roundhouse - Kit**

Walthers Cornerstone Series.  
Features compact 10-degree spacing, floor inspection pits and holds engines up to 125 scale feet long. Modular design is easily expanded.  
933-2900 Modern 3-Stall Roundhouse  
Reg. Price: **\$76.98**  
Sale: **\$59.98**



**HO Clayton County Lumber - Kit**

Walthers Cornerstone Series  
933-2911 Clayton County Lumber  
Reg. Price: **\$43.98**  
Sale: **\$33.98**



**HO McGraw Oil Co. - Kit**

Walthers Cornerstone Series  
933-2913 McGraw Oil Co.  
Price: **\$43.98**

**HO Conveyor ("Leg") - Kit**

Walthers Cornerstone Series. 1-1/2 x 1-1/2 x 15-3/4" (Max Height)  
3.8 x 3.8 x 40cm  
933-2936 Conveyor ("Leg")  
Reg. Price: **\$49.98**  
Sale: **\$28.98**



**HO Wet/Dry Storage Bins - Kit**

Walthers Cornerstone Series.  
3-5/8 x 3-5/8 x 12"  
933-2937 Wet/Dry Storage Bins pkg(2)  
Reg. Price: **\$54.98**  
Sale: **\$37.98**



**HO Train Shed - Kit**

Walthers Cornerstone Series. Classic American design is used in many cities. Easy to combine kits for a larger facility.  
22-3/8 x 11-9/16 x 6-1/4"  
56.8 x 29.3 x 15.8cm  
933-2949 Train Shed  
Reg. Price: **\$109.98**  
Sale: **\$76.98**



**HO Freight Office - Kit**

Walthers Cornerstone Series. 8-13/16 x 9 x 6-1/8"  
933-2953 Freight Office  
Reg. Price: **\$38.98**  
Sale: **\$29.98**

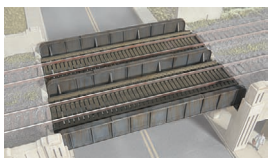

## HO Through Plate-Girder Bridge - Kit

Walthers® Cornerstone Series®  
933-2948 Through Plate-Girder Bridge  
Reg. Price: \$25.98  
Sale: **\$17.98**



## HO Blower Engine House - Kit

Walthers Cornerstone Series.  
Houses enormous air compressors, along with boilers and steam turbines to power them, which literally put the blast in the blast furnaces.  
933-2957 Blower Engine House  
Reg. Price: \$164.98  
Sale: **\$125.98**



## HO Rolling Mill - Kit

Walthers Cornerstone Series. Similar to buildings used for vehicle and railcar assembly, metal smelting and fabrication, refractories and more.  
32 x 11-1/8 x 10"  
81.3 x 28.26 x 25.4cm  
933-2971 Rolling Mill  
Reg. Price: \$175.98  
Sale: **\$119.98**



## HO Coke Oven & Quench Tower - Kit

Walthers Cornerstone Series. Features detailed doors, walkways, large concrete smokestack, governor house and many other parts.  
933-2972 w/Larry & Quench Cars  
Reg. Price: \$142.98  
Sale: **\$99.98**



## HO Blast Furnace - Kit

Walthers Cornerstone Series. Includes furnace, stoves, dust collectors and cleaning system, piping, cast house, hearth, skip hoist, high line supports.  
28 x 14 x 21-1/2"  
70 x 35 x 53.7cm  
933-2973 Blast Furnace  
Reg. Price: \$263.98  
Sale: **\$179.98**



## HO Armstrong Electric Motors - Kit

Walthers Cornerstone Series Background Buildings  
933-3172 Armstrong Electric Motors  
Reg. Price: \$39.98  
Sale: **\$32.98**



## HO Arched Road Bridge - Kit

Walthers Cornerstone Series.  
7-3/4 x 10-3/8 x 3-7/8",  
Opening: 4-5/8"  
933-3196 Arched Road Bridge  
Reg. Price: \$30.98  
Sale: **\$16.98**



## NEW HO Machine Shed - Kit

Walthers Cornerstone Series Lasercut.  
2-7/8 x 3-7/8 x 2-7/8"  
7.3 x 9.8 x 7.3cm  
933-3334 Machine Shed  
Price: **\$27.98**



## HO Hulett Unloader - Kit

Walthers Cornerstone Series. Builds a complete unit with lower gantry and upper carriage with walking beam, digging arm and bucket. Major parts are positionable.  
17-1/2 x 8-3/4 x 12-1/2"  
44.5 x 22.2 x 31.8cm  
933-2966 Hulett Unloader  
Price: **\$186.98**



## NEW HO Hen House - Kit

Walthers Cornerstone Series Lasercut.  
2-1/8 x 1-1/4 x 1-3/8"  
5.3 x 3.1 x 3.4cm  
933-3335 Hen House  
Price: **\$18.98**



## NEW HO Corn Crib - Kit

Walthers Cornerstone Series Lasercut.  
2-3/4 x 3-3/4 x 3-1/8"  
6.9 x 9.5 x 7.9cm  
933-3336 Corn Crib  
Price: **\$29.98**



## NEW HO Cristie's Pet Supply - Kit

Walthers Cornerstone Series.  
3-1/2 x 6-1/8 x 6-1/8"  
8.8 x 15.5 x 15.5cm  
933-3463 Cristie's Pet Supply  
Price: **\$34.98**



## NEW HO Glover Park Hardware - Kit

Walthers Cornerstone Series.  
7-1/8 x 5-1/2 x 2-7/8"  
18 x 13.9 x 7.3cm  
933-3465 Glover Park Hardware  
Price: **\$29.98**



## NEW HO Argosy Booksellers - Kit

Walthers Cornerstone Series.  
4-3/4 x 8-1/2 x 7-1/4"  
12 x 21.5 x 18cm  
933-3466 Argosy Booksellers  
Price: **\$39.98**



## NEW HO Derry's Pub - Kit

Walthers Cornerstone Series.  
3-1/2 x 6-1/8 x 6"  
8.8 x 15.5 x 15.2cm  
933-3467 Derry's Pub  
Price: **\$34.98**

**NEW SUPPLIER**

**LUNDE STUDIOS**

Want an impressive building for your city? Big, beautiful building kits from Lunde Studios are now available at Walthers. Each is handcrafted in the USA from an original pattern. These highly detailed resin models are hand-poured in appropriate colors so no painting is needed. They're fun to build and are sure to make a great impact on your layout.

**NEW HO**

**Falcon Tower - Kit**

5 x 4-1/4 x 16"  
12.7 x 10.8 x 40.6cm  
396-23 Falcon Tower  
Reg. Price: \$74.95  
Sale: **\$65.98**



**NEW HO McAdam Building - Kit**

4 x 5 x 9-3/16"  
10.2 x 12.7 x 23.4cm  
396-26 McAdam Building  
Reg. Price: \$59.95  
Sale: **\$52.98**



**NEW HO Peacock Building - Kit**

4-5/8 x 3-3/8 x 8"  
11.7 x 8.6 x 20.3cm  
396-25 Peacock Building  
Reg. Price: \$39.95  
Sale: **\$34.98**



**NEW HO Magnuson International - Kit**

5 x 3-3/4 x 10-1/2"  
12.7 x 9.5 x 26.6cm  
396-28 Magnuson International  
Reg. Price: \$59.95  
Sale: **\$52.98**



**NEW HO Heron Ltd. - Kit**

5 x 4-1/4 x 9-1/4"  
12.7 x 10.8 x 23.5cm  
396-24 Heron Ltd.  
Reg. Price: \$59.95  
Sale: **\$52.98**



**NEW HO The Bon Ton - Kit**

5-1/2 x 5-1/2 x 8"  
14 x 14 x 20.3cm  
396-27 The Bon Ton  
Reg. Price: \$64.95  
Sale: **\$56.98**



**NEW HO Chadwick Tower - Kit**

3-1/4 x 4-1/2 x 12"  
8.3 x 11.4 x 30.5cm  
396-5 Chadwick Tower  
Reg. Price: \$69.95  
Sale: **\$61.98**



**NEW HO Perfect Perk Cafe - Kit**

Walthers® Cornerstone Series®.  
3-1/8 x 5-1/2 x 4-1/2"  
7.9 x 13.9 x 11.4cm  
933-3468 Perfect Perk Cafe  
Price: **\$34.98**



**NEW HO Ferrous Shear - Kit**

Walthers Cornerstone Series. 7-1/4 x 3 x 3"  
18.4 x 7.6 x 7.6cm  
933-3630 Ferrous Shear  
Price: **\$24.98**

*Faster Check-Out Options at [www.walthers.com/](http://www.walthers.com/)!*



**NEW HO Scrap Yard Conveyor - Kit**

Walthers Cornerstone Series.  
9-1/4 x 1-3/4 x 3-3/8"  
23.4 x 4.4 x 8.5cm  
933-3645 Scrap Yard Conveyor  
Price: **\$14.98**

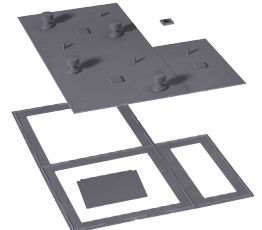

**HO Flat Roof & Base - Kit**

Walthers Cornerstone Modulares  
933-3721 Flat Roof & Base  
Reg. Price: \$6.98 Sale: **\$3.98**



**NEW HO Village Pizza - Kit**

Walthers Cornerstone Series. 3-1/8 x 5-1/2 x 4-3/4"  
7.9 x 13.9 x 12cm  
933-3469 Village Pizza  
Price: **\$34.98**



**NEW HO Baler/Logger - Kit**

Walthers Cornerstone Series. 4-5/8 x 1-3/8 x 1-1/4"  
11.7 x 3.4 x 3.1cm  
933-3631 Baler/Logger  
Price: **\$24.98**

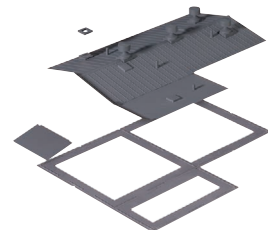

**HO Peaked Roof & Base - Kit**

Walthers Cornerstone Modulares™  
933-3720 Peaked Roof & Base  
Reg. Price: \$6.98 Sale: **\$3.98**



**HO Small Walls, Windows & Doors - Kit**

Walthers Cornerstone Modulares  
933-3722 Small Walls, Windows & Doors  
Reg. Price: \$6.98 Sale: **\$3.98**



**HO Large Walls & Windows - Kit**  
Walthers® Cornerstone Modulares™  
933-3723 Large Walls & Windows  
Reg. Price: \$6.98 Sale: **\$3.98**

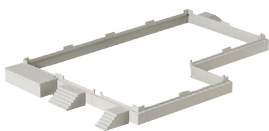

**HO Foundation & Loading Docks - Kit**  
Walthers Cornerstone Modulares  
933-3724 Foundation & Loading Docks  
Reg. Price: \$6.98 Sale: **\$3.98**



**HO Wall Columns & Caps - Kit**  
Walthers Cornerstone Modulares  
933-3725 Wall Columns & Caps  
Reg. Price: \$6.98 Sale: **\$3.98**

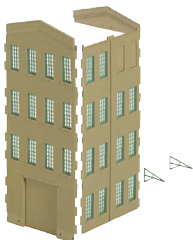

**HO Large-Door Wall Section - Kit**  
Walthers Cornerstone Modulares  
933-3727 Large-Door Wall Section  
Reg. Price: \$6.98 Sale: **\$3.98**

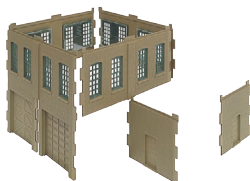

**HO Walls w/Vehicle Doors - Kit**  
Walthers Cornerstone Modulares  
933-3730 Walls w/Vehicle Doors  
Reg. Price: \$6.98 Sale: **\$3.98**

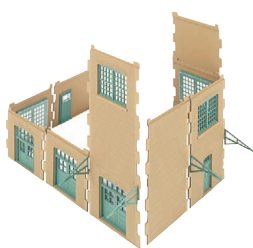

**HO Small Walls w/Single Large Arched Window - Kit**  
Walthers Cornerstone Modulares  
933-3731 Small Walls w/Single Large Arched Window  
Reg. Price: \$6.98 Sale: **\$3.98**

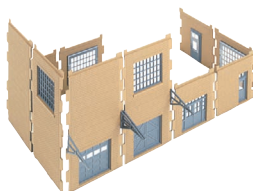

**HO Small Walls w/Large Metal Sash Window - Kit**  
Walthers Cornerstone Modulares  
933-3732 Small Walls w/Large Metal Sash Window  
Reg. Price: \$6.98 Sale: **\$3.98**



**HO Large Walls w/Single Large Arched Window - Kit**  
Walthers Cornerstone Modulares  
933-3734 Large Walls w/Single Large Arched Window  
Reg. Price: \$6.98 Sale: **\$3.98**

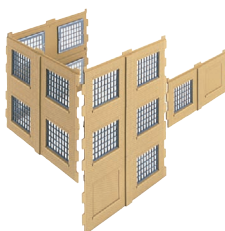

**HO Large Walls w/Large Metal Sash Window - Kit**  
Walthers Cornerstone Modulares  
933-3735 Large Walls w/Large Metal Sash Window  
Reg. Price: \$6.98 Sale: **\$3.98**



**HO Quality Investment Casting - Kit**  
Walthers Cornerstone Modulares.  
4-3/8 x 8-1/2 x 4-3/4"  
933-3751 Quality Investment Casting  
Reg. Price: \$21.98  
Sale: **\$12.98**



**HO National Oil Co. - Kit**  
Life-Like from Walthers  
433-1331 National Oil Co.  
Reg. Price: \$12.98  
Sale: **\$9.98**



**HO Belvedere Downtown Hotel - Kit**  
Life-Like from Walthers.  
5-1/2 x 2-1/2" 14 x 6.4cm  
433-1339 Belvedere Downtown Hotel  
Reg. Price: \$14.98  
Sale: **\$8.98**

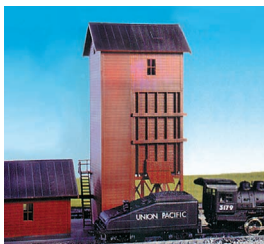

**HO Coaling Tower - Kit**  
Life-Like from Walthers  
433-1377 Coaling Tower  
Reg. Price: \$11.98  
Sale: **\$7.29**

**HO Trackside Shanty - Kit**  
AM Models.  
5/8 x 3/4"  
1.5 x 2cm  
129-101 Trackside Shanty  
Reg. Price: \$2.30 Sale: **\$1.98**



**HO Shanty - Kit**  
AM Models. 1 x 1"  
2.5 x 2.5cm  
129-102 Shanty  
Reg. Price: \$4.60 Sale: **\$3.98**



**HO Freight Platform - Kit**  
AM Models. 2-1/4 x 5-1/2"  
5.6 x 13.9cm  
129-107 Freight Platform  
Reg. Price: \$4.60 Sale: **\$3.98**



**HO Freight Station - Kit**  
AM Models. 2-1/2 x 2-1/4"  
6.2 x 5.6cm  
129-108 Freight Station  
Reg. Price: \$9.25 Sale: **\$7.98**



**HO Bunkhouse - Kit**  
AM Models. 2-1/4 x 2-1/4"  
5.6 x 5.6 cm  
129-109 Bunkhouse  
Reg. Price: \$5.35 Sale: **\$4.59**



**HO Garage - Kit**  
AM Models. 2-1/2 x 2-1/4"  
6.2 x 5.6cm  
129-114 Garage  
Reg. Price: \$6.10 Sale: **\$5.49**



**HO 3-Stall Roundhouse - Kit**  
Atlas. 14-3/8 x 15 x 4-5/8"  
35.9 x 37.5 x 11.5cm  
150-709 3-Stall Roundhouse  
Reg. Price: \$38.50  
Sale: **\$31.98**



**NEW HO Transformer - Kit**  
Atlas. 4-9/16 x 3-3/4"  
11.6 x 9.5cm  
150-780 Transformer pkg(2)  
Reg. Price: \$26.50  
Sale: \$21.98

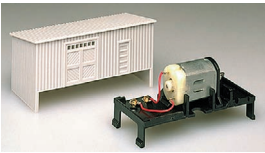

**HO Turntable Drive Unit**  
Atlas  
150-304 Turntable Drive Unit  
Reg. Price: \$35.95  
Sale: \$29.98

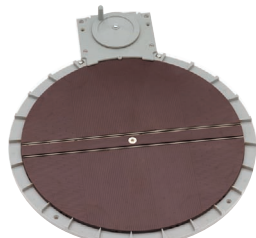

**HO 21 Stall Turntable - Kit**  
Atlas. 9" 22.8cm Diameter  
150-305 21 Stall Turntable  
Reg. Price: \$35.95  
Sale: \$29.98



**HO 18" Through-Truss Bridge - Kit**  
Atlas  
150-593 Code 83 Track (black)  
Reg. Price: \$32.95  
Sale: \$26.98



**HO Station Platform - Kit**  
Atlas. 2-1/8 x 6-1/2"  
5.4 x 16.3cm  
150-707 Station Platform  
pkg(2)  
Reg. Price: \$7.75 Sale: \$6.29



**HO 18" Through Truss Bridge - Kit**  
Atlas  
150-888 Code 100 Track  
(black)  
Reg. Price: \$32.95  
Sale: \$26.98



**HO Garner's Market - Kit**  
American Model Builders.  
Features detailed outside  
stairway, interior floors and wall  
partitions, free standing  
billboard, signs, sidewalk and  
numerous detail parts.  
7-1/4 x 3-3/4 x 3-1/4"  
152-189 Garner's Market  
Reg. Price: \$62.95  
Sale: \$55.98



**HO All American Service Station - Kit**  
American Model Builders  
LaserKit®. 5-1/2 x 6 x 2-1/4"  
152-723 All American Service  
Station  
Reg. Price: \$42.95  
Sale: \$37.98



**HO The Loft Barn - Kit**  
American Model Builders  
LASERkit Xpress. 3 x 2-1/2 x  
3-1/4" 7.5 x 6.2 x 8.1cm  
152-794 The Loft Barn  
Reg. Price: \$14.95  
Sale: \$12.98



**HO ATSF Standard Section Tool House - Kit**  
American Model Builders  
LaserKit. 2 x 1-3/4 x 1-3/4"  
152-169 ATSF Standard Section  
Tool House  
Reg. Price: \$11.95  
Sale: \$10.98



**HO Crossroads Church - Kit**  
American Model Builders  
LASERkit Xpress. 4 x 2 x 3-1/2"  
152-791 Crossroads Church  
Reg. Price: \$15.95  
Sale: \$13.98



**HO Barn - Kit**  
Bachmann. 2-1/2 x 3-1/2"  
6.4 x 9cm  
160-45151 Barn  
Reg. Price: \$15.50  
Sale: \$10.98



**HO Gas Station - Kit**  
Bachmann  
160-45174 Gas Station  
Reg. Price: \$20.00  
Sale: \$14.98



**HO Industrial Water Tower - Kit**  
Bar Mills.  
Scale 80" Tall  
171-132  
Industrial Water  
Tower  
Reg. Price: \$29.95  
Sale: \$25.98



**HO Twin Utility Sheds - Kit**  
Bar Mills  
171-702 Twin Utility Sheds  
Reg. Price: \$23.95  
Sale: \$20.98



**HO Revelia Shipping & Storage - Kit**  
Bar Mills  
171-722 Revelia Shipping &  
Storage  
Reg. Price: \$22.95  
Sale: \$19.98



**HO Whistle Stop Junction - Kit**  
Bar Mills. 4 x 6" 10 x 15cm  
171-911 Whistle Stop Junction  
Reg. Price: \$49.95  
Sale: \$43.98



**HO Horizontal Fuel Tank - Kit**  
Bar Mills  
171-2003 Horizontal Fuel Tank  
pkg(2)  
Reg. Price: \$14.95  
Sale: \$12.98



**HO Sweaty Betty's Diner - Kit**  
Bar Mills. 7 x 2-1/2"  
17.8 x 6.4cm  
171-302 Sweaty Betty's Diner  
Reg. Price: \$47.95  
Sale: \$41.98



**HO The Fishing Shack At Cozy Cove - Kit**  
Bar Mills  
171-662 The Fishing Shack  
At Cozy Cove  
Reg. Price: \$22.95  
Sale: \$19.98



**HO Trackside Equipment Shed - Assembled**  
BLMA  
176-4305 Trackside Equipment  
Shed  
Reg. Price: \$9.45 Sale: \$7.98



**HO Modern Electrical Boxes - Assembled**  
BLMA  
176-4310 Small Modern  
Electrical Box  
Reg. Price: \$9.95 Sale: \$8.98  
176-4311 Medium Modern  
Electrical Box  
Reg. Price: \$10.45  
Sale: \$8.98

# Here are some of the Retailers Participating in this Sale!

You can visit these hobby shops for the products in this sale flyer. You can also order products from these hobby shops over the Walthers® website at [www.walthers.com](http://www.walthers.com).

## **ALABAMA**

Norman's Trains, *Latent*  
Ed's Box Car, *Seale*

## **ARIZONA**

Roy's Train World, *Mesa*  
An Affair With Trains, *Phoenix*  
The Hobby Depot, *Tempe*

## **ARKANSAS**

One Track Mind, *Mabelvale*

## **CALIFORNIA**

Milepost 38 Model Trains, *Anaheim Hills*  
Tom's Trackside Trains, *Burlingame*  
Hobbytown USA, *Corona*  
Bulldog, *Fresno*  
R Hobbies, *La Miranda*  
The Roundhouse, *North Hollywood*  
Railroad Hobbies, *Roseville*  
J&M Hobby House, *San Carlos*  
Feather River Train Shop, *San Rafael*  
Poggie's, *Santa Rosa*

## **COLORADO**

Custom Railway Supply, *Colorado Springs*  
Caboose Hobbies, *Denver*  
The Hobby Hut, *Grand Junction*

## **CONNECTICUT**

Ann's Hobby Center, *Cos Cob*  
Time Machine Hobbies, *Manchester*  
Tom's Trains, *Rock Hill*  
Railroad Model & Hobby Supply, *Winsted*  
RC Hobbies and More, *Winsted*  
The Hobby Gallery, *Wolcott*

## **FLORIDA**

The Depot Hobby Shop, *Lantana*  
Orange Park Hobby World, *Jacksonville*  
Ready To Roll, *Miami*  
Rob's Hobby World, *Ocala*  
Space Coast Hobbies, *Palm Bay*  
Roundhouse South, *Port Orange*

## **GEORGIA**

Trainmaster, *Duluth*  
Hobby Town USA, *Kennesaw*  
Riverdale Station, *Riverdale*  
Bull Street Station, *Savannah*

## **ILLINOIS**

Antioch Trains, *Antioch*  
Hobbyland Inc, *Bloomington*  
Hobbies R4U, *Bradley*  
Grayland Station, *Chicago*  
Walt's Hobby & Model Shop, *Crest Hill*  
First Hobby, *Decatur*  
Des Plaines Hobbies, *Des Plaines*  
Al's Hobby Shop, *Elmhurst*  
Lombard Hobbies, *Lombard*  
Chuck's Depot, *Marion*  
Ron's Mundelein Hobby, *Mundelein*  
Train Sets Only, *New Lenox*  
Pat's Hobbies & Crafts, *Oak Lawn*  
Mike's Scale Rails, *Peoria*

Hammer's Springfield Hobbies, *Springfield*  
Hobbytown USA, *St. Charles*  
Accu-Lites, *Wauconda*

## **INDIANA**

CP Trains Stop, *Crown Point*  
Park Lane Hobbies, *Dyer*  
Rupel Toy Trains, *Elkhart*  
Phil's Hobby Shop, *Fort Wayne*  
Hobbytown USA, *Indianapolis*  
Hawkins Rail Services, *Lafayette*

## **IOWA**

The Hobbycraft Shop, *Burlington*  
Caboose Stop Hobbies, *Cedar Falls*  
Box Kar Hobbies, *Cedar Rapids*  
Major Art & Hobby Center, *Davenport*  
Hobby Haven, *Urbandale*

## **KANSAS**

To To Trains, *Lawrence*  
End of the Line, *Stockton*  
Engine House Hobbies, *Wichita*

## **KENTUCKY**

Johnny's Toys, *Covington*  
Century Jet, *Louisville*  
Round House, *Louisville*  
Scale Reproductions, *Louisville*

## **MAINE**

Maine Trains, *Kezar Falls*  
Rainy Day Trains, *Saco*

## **MARYLAND**

Hobby Works, *Bel Air*  
MB Klein, Inc., *Cockeysville*  
Pro Custom Hobbies, *Eldersburg*  
Mail Bag Hobbies, *Hampstead*  
Hobby Works, *Laurel*  
Peach Creek Shops, *Laurel*  
Hobby Works, *Rockville*  
The Moose Caboose, *Sykesville*

## **MASSACHUSETTS**

Maine Trains, *Chelmsford*  
Hobby Quarters, *Foxboro*  
Charles Ro Supply, *Malden*  
H. H. Snow & Sons, Inc., *Orleans*  
Ken's Trains, *Sudbury*  
Hobby Emporium, *Tyngsboro*  
Tucker's Hobbies, *Warren*

## **MICHIGAN**

Nankin Hobby, *Farmington*  
Sidetrax Hobbies, *Grandville*  
Mountain Town Hobby's, Inc., *Mt. Pleasant*  
Funny Pages Hobbies, *Owosso*  
Brasseur Electric Trains, *Saginaw*  
Trains & Things Hobbies, *Traverse City*  
Nankin Hardware, *Westland*

## **MINNESOTA**

Hobby Hut of Moorhead, *Moorhead*  
Becker's, *New Brighton*  
Everything Hobby, *Rochester*  
Iron Horse Hobby, *Waite Park*  
Teskeys Trains, *Waseca*

## **MISSOURI**

Mark Twain Hobbies, *Saint Charles*

## **MONTANA**

Jim's Junction, *Billings*

## **NEBRASKA**

House of Trains, *Omaha*

## **NEVADA**

Hobbytown USA, *Las Vegas*  
Westside Trains, *Las Vegas*  
Trains Emporium, *Sparks*

## **NEW JERSEY**

Tony's Train Town, *Cedar Grove*  
Model Railroad Supply, *Little Silver*  
The Model Railroad Shop, *Piscataway*  
Railroad Warehouse, *Point Pleasant*  
The Train Room, *Point Pleasant Beach*  
H&R Railroad Supply, *Vineland*  
Sattler's Hobby Shop, *Westmont*

## **NEW MEXICO**

Fifer Hobby Supply, *Las Cruces*

## **NEW HAMPSHIRE**

Toy City, *Keane*  
Hobbytown USA, *Nashua*  
Route 106 Race Park, *Pembroke*

## **NEW YORK**

Bayshore Hobby, *Bayshore*  
VCS Hobbies, *Brooklyn*  
Despatch Junction, *East Rochester*  
Borodino Scale Lines, *Elbridge*  
Lake City Hobbies, *Geneva*  
Lantz Woodcraft & Train Shop, *Horseheads*  
J&J Hobbies, *Kingston*  
JP's Trains & Hobbies, *Latham*  
Willis Hobbies & Craft, *Mineola*  
Dan's Crafts & Things, *Rochester*  
Mohawk Valley RR Co., *Schenectady*

## **NORTH CAROLINA**

Dad's Cats, *Hendersonville*  
King RC, *King*  
Chuck's Trains, *Landis*  
Brunswick Modellbahn, *Southport*  
Little Choo Choo, *Spencer*  
Train Buddy Products, *Wake Forest*  
The Antique Barn, *Wilson*

## **OHIO**

Rob's Trains, *Alliance*  
Uncle Ray's Trains, *Avon Lake*  
Depot Train & Hobby, *Cleveland*  
The Train Station, *Columbus*  
Robbies Hobbies, *Columbus*  
Hobbyland-Graceland, *Delaware*  
Hobbytown USA, *Holland*  
Wings Hobby Shop, *Lakewood*  
John's Hobby Shop, *Mansfield*  
Hobbytown USA, *Mentor*  
Nick's Sales & Service, *North Canton*  
Market Street Hardware & Toytown, *Portsmouth*  
DLH Locomotive Works, *Springfield*  
The Whistle Stop, *Troy*  
Andrew's Shopping Center, *Warren*

Waverly Hobby Shop, *Waverly*  
Stewart's Hobbies & Collectors, *Willoughby*  
Amers Hobbies, *Youngstown*  
Ed's Hobby Shop, *Zanesville*

## **OREGON**

Tammie's Hobbies, *Beaverton*  
Mainline Trains, *Forest Grove*  
The Hobby Smith, *Portland*  
Whistlestop, *Portland*  
Leisure Hobbies, *Salem*

## **PENNSYLVANIA**

Mainline Hobby Supply, *Blue Ridge Summit*  
Train Shed Hobbies, *Chambersburg*  
Tommy Gilbert's, *Gettysburg*  
Niedzalkoski's Train Shop, *Jeannette*  
Lin's Junction, *Lansdale*  
Draude's Derailment, *Lebanon*  
Forsythe Train Repair, *Lewistown*  
Internet Hobbies, *Mayfield*  
English's Model RR Supply, *Montoursville*

AB Charles & Son, *Pittsburgh*  
Hobbytown USA, *Reading*  
Iron Horse Hobby House, *Reading*  
Cool Trains, *Salunga*  
Nolan & Rogers, *Scranton*  
Choo Choo Barn, *Strasburg*  
Hobbytown USA, *Whitehall*

## **SOUTH CAROLINA**

Blue Ridge Hobbies, *Greenville*

## **SOUTH DAKOTA**

Who's Hobby House, *Rapid City*  
Donovan's Hobby, *Sioux Falls*

## **TENNESSEE**

The Tennessee Central Railway, *Nashville*

## **TEXAS**

Discount Model Trains, *Addison*  
Angelohobbies.com, *Halton City*  
Groves Train Repair, *Odessa*  
Dibbles Hobbies, *San Antonio*  
Spring Crossing, *Spring*  
Annie Jewel & Charlie's Kids, *Wichita Falls*

## **UTAH**

Almosta Junction, *Clearfield*  
Warren's Train Shop, *Ogden*  
Wonderful World of Trains, *Ogden*  
Model RR Station Hobby Shop, *Sandy*

## **VIRGINIA**

Whistle Stop, *Alexandria*  
Hobby Works, *Fairfax*  
Dale's Train Station, *Norfolk*  
Staunton Trains & Hobbies, *Staunton*  
Benny's Train Shop, *Winchester*

## **WASHINGTON**

N.W.S., *Camas*  
Pacific Western Rail Systems, *Ferndale*  
Parkade Hobbies, *Kennnewick*  
The Train Center, *Seattle*  
Sunset Junction, *Spokane*

## **WEST VIRGINIA**

Nitro Hobby & Craft Center, *Nitro*

## **WISCONSIN**

South Side Trains, *Bay View*  
Sommerfeld's Trains & Hobbies, *Butler*

Chippewa RC Hobby LLC, *Chippewa Falls*  
Engine House Services, *Green Bay*

Greenfield News and Hobby, *Greenfield*  
Madison Hobby Shop, *Madison*

The Last Square, *Madison*  
Silver Square Hobby, *Milwaukee*  
The Hobby Depot, *Monroe*

Hobby Connection, *Rothschild*  
Jetco's Hiawatha Hobbies, *Waukesha*  
Pope's Hobby Land, *Wausau*

## **WYOMING**

Cherry Creek Hobbies, *Torrington*

## **CANADA**

Eastridge Hobbies, *Calgary, Alberta*

Interior Crafts, *Kamloops, British Columbia*  
On Track Hobbies, *Port Moody, British Columbia*

Interior Hobbies, *Prince George, British Columbia*  
Elmwood Hobby Works, *Winnipeg, Manitoba*

Don's HO Service, *Moncton, New Brunswick*

Broughdale Hobby & Photo, *London, Ontario*  
Lark Spur Line, Ltd., *Merrickville, Ontario*

Paris Junction, *Paris, Ontario*  
Credit Valley, *Streetsville, Ontario*

## **GERMANY**

Modellbahn-Atelier-Berlin, *Berlin*  
Menzels Lokschnuppen, *Dusseldorf*

Modellbaushop, *Gross-Rohrheim*  
All American Trains, *Kaarst*

Haupt & Trains, *Owschlag*  
Sammeler-Service, *Scheyern (Muenchen)*

## **NETHERLANDS**

Hobbyworld, *Barendrecht*

## **JAPAN**

Trainwave, *Tokyo*

## **HONG KONG**

Concorde Models, *Kowloon*

\* Participating dealers may be temporarily out of stock on some items in this flyer. Your dealer can immediately check the Walthers warehouse for availability and order any item shown in this flyer or in Walthers Reference Books using EXPRESS™ III, our Web site ([www.walthers.com](http://www.walthers.com)) or by calling Walthers toll-free number. All items, unless otherwise stated, were expected to be in stock prior to this publication being mailed. However, some items may be out of stock due to sales demand.

# WALTHERS®

## HOW TO ORDER

For fastest service, place your order on-line at **walthers.com**. You can also call **1-800-4TRAINs (1-800-487-2467)\*** at any time — our regular business hours are Monday through Friday, 8:00 AM to 5:00 PM Central Time. After hours, you can place an automated order or leave a message. Phone orders must be charged to a credit card or sent C.O.D.

*\*If ordering from outside Canada, Mexico or the USA, please call (414) 527-0770 or fax this order form to (414) 527-4423, Attn: Consumer Sales.*

## ORDER PAYMENT

For fastest service, order by credit card; we accept Visa, MasterCard, American Express and Discover. We also accept C.O.D. orders, personal checks or money orders (sorry, no Euro Checks). Unless certified, checks over \$200.00 will be cleared before the order ships, which can take up to 10 business days.

[www.walthers.com](http://www.walthers.com)

1-800-4TRAINs (1-800-487-2467) 1-800-807-2467 FAX  
P.O. Box 3039, Milwaukee, WI 53201-3039

## Back Order Instructions (Credit Card Only)

Your credit card account will NOT be charged until your merchandise is available for shipment. On items that are back ordered, we will guarantee the price for at least six months from the date of order.

X	Domestic	International
<input type="checkbox"/>	Hold backorders until value exceeds \$20.00. Shipping & handling charges are 10% of total value (\$3.00 to \$5.50 maximum).	Hold backorders until value exceeds \$20.00. Standard international shipping fees apply; no handling fees are charged.
<input type="checkbox"/>	Yes, Backorder and Hold	
<input type="checkbox"/>	Ship backordered items as available. Shipping & handling charges are 10% of total value (\$3.00 to \$5.50 maximum).	Ship backordered items as available. Standard international shipping fees apply. An additional \$5.00 handling fee is added to orders under \$20.00.
<input type="checkbox"/>	Yes, Sent as Available	
<input type="checkbox"/>	No Backorders	Dont backorder out-of-stock merchandise.

## BILL TO

**CUSTOMER NUMBER** \_\_\_\_\_

**KEYCODE FROM BACK OF FLYER** \_\_\_\_\_

Name \_\_\_\_\_

Address \_\_\_\_\_

City, State, Zip \_\_\_\_\_

Country (WI and CA Residents Only) \_\_\_\_\_

Country (If Outside U.S.A.) \_\_\_\_\_

Daytime Phone (\_\_\_\_\_) \_\_\_\_\_

Date of Order \_\_\_\_\_

Email \_\_\_\_\_

## SHIP TO

Same as Billing Address

Name \_\_\_\_\_

Address \_\_\_\_\_

City, State, Zip \_\_\_\_\_

Country (WI and CA Residents Only) \_\_\_\_\_

Country (If Outside U.S.A.) \_\_\_\_\_

Daytime Phone (\_\_\_\_\_) \_\_\_\_\_

Check this box and list your old address if you have moved since your last order

Always give MANUFACTURER'S NAME and NUMBER when ordering. Please, ONLY ONE ITEM PER LINE.

QTY ORDERED	MANUFACTURER NAME	MANUFACTURER PART NUMBER	DESCRIPTION	UNIT PRICE	TOTAL
1			NOTE: Orders are filled by NUMBER, not description.		
2					
3					
4					
5					
6					
7					

## Need to return an item?

For a return authorization, please call us at **1-800-487-2467**, e-mail [custserv@walthers.com](mailto:custserv@walthers.com) or go to our website to view our return policy at [www.walthers.com/returns](http://www.walthers.com/returns).

## Most standard shipping orders are delivered by the US Postal Service.

**DOMESTIC HANDLING CHARGES** ————— see below,  
\$8.95 for Standard Shipping. Expedited delivery is available — see below,  
FREE STANDARD SHIPPING applies to orders with \$150.00 or more of **IN-STOCK** merchandise.

**UPGRADED DOMESTIC SHIPPING CHARGES** ————— see below,  
Charges listed below are in addition to the \$8.95 standard delivery charge that is required on all upgraded orders. **Priority delivery, please add \$5.00. Second-day delivery, please add \$9.99. Next-day delivery, please add \$27.99.** Note: Upgraded orders placed after 12:00 PM Central Time may not ship until the next business day.

## INTERNATIONAL SHIPPING CHARGES

Please note that taxes, customs duties and brokerage fees may apply and will be added once your order reaches its destination. These additional charges are the sole responsibility of the buyer. Canadian orders add \$6.25 handling plus 15% of the merchandise total on orders \$150.00 and under or 10% of the merchandise total on orders \$150.01 or more. All other international orders add \$6.25 handling plus 20% of the merchandise total on orders \$150.00 and under or 15% of the merchandise total on orders \$150.01 or more.



( ) VISA ( ) MasterCard  
( ) Discover ( ) American Express

Credit Card Number \_\_\_\_\_

Expiration Date \_\_\_\_\_

Signature \_\_\_\_\_

Merchandise Total

Handling Charge

Upgraded Shipping Charge

Subtotal

International Shipping

WI, CA, & MD Residents  
Add Applicable State,  
County and Local Sales  
Tax to Subtotal

**TOTAL**



## HO Canaan Union Station - Kit

Branchline Trains. Depicts the Connecticut station circa 1940 modified slightly to accommodate a 90° crossing. Includes wood, resin and photo-etched parts, Grandt Line baggage carts, appropriate signs and posters and more. 22 x 20 x 7" 55.9 x 50.8 x 17.8cm  
181-659 Canaan Union Station  
Reg. Price: \$299.99  
Sale: **\$269.98**



## HO The Albion Catalog House - Kit

Branchline Trains. 4 x 6 x 4-1/2" 181-621 The Albion Catalog House  
Reg. Price: \$54.98  
Sale: **\$48.98**



## HO The Drayton House - Kit

Branchline Trains  
181-624 The Drayton House  
Reg. Price: \$19.98  
Sale: **\$17.98**



## HO Buick Garage - Kit

Branchline Trains  
181-630 Buick Garage  
Reg. Price: \$17.99  
Sale: **\$15.98**



## HO Hudson Garage - Kit

Branchline Trains  
181-632 Hudson Garage  
Reg. Price: \$17.99  
Sale: **\$15.98**



## HO Common Pile Trestle - Kit

Blair Line. 6 x 2" 15 x 5cm  
184-167 Build Straight or Curved  
Reg. Price: \$23.95  
Sale: **\$19.98**



## HO Drive-In Theatre - Kit

Blair Line  
184-168 Drive-In Theatre  
Reg. Price: \$26.95  
Sale: **\$23.98**



## HO Dari-King Drive In Restaurant - Kit

Blair Line. 4 x 5" 10 x 12.5cm  
184-182 Dari-King Drive In Restaurant  
Reg. Price: \$34.95  
Sale: **\$29.98**



## HO Cash Mine Works Ore House - Kit

Blair Line. 7-1/2 x 8-1/2" 184-186 Cash Mine Works Ore House  
Reg. Price: \$139.95  
Sale: **\$119.98**



## HO A-to-Z Used Car Lot - Kit

Blair Line  
184-197 A-to-Z Used Car Lot  
Reg. Price: \$47.95  
Sale: **\$41.98**



## HO Joe's Cabin w/Outhouse - Kit

Blair Line. Cabin: 4-1/4 x 2-5/16",  
Outhouse: 5/8 x 5/8"  
184-2000 Joe's Cabin w/Outhouse  
Reg. Price: \$37.95  
Sale: **\$33.98**



## HO Flower Stand - Kit

Busch  
189-1072 Flower Stand  
Reg. Price: \$27.99  
Sale: **\$22.98**

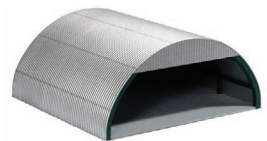

## HO Airplane Hangar - Kit

Busch. 5-15/16 x 5-3/4 x 2-1/2" 15 x 14.5 x 6.5cm  
189-1408 Airplane Hangar  
Reg. Price: \$34.99  
Sale: **\$28.98**

## HO Transmitter Tower - Kit

Busch. Features three red LEDs at the top of the tower that blink in sequence.  
14-3/4" 37cm  
189-5965  
Transmitter Tower  
Reg. Price: \$62.99  
Sale: **\$51.98**



## HO Townhouse #3 - Kit

Woodland Scenics® DPM  
Landmark Structures™.  
2-1/2 x 4-1/4" 6.4 x 11cm  
243-11100 Townhouse #3  
Reg. Price: \$18.99  
Sale: **\$16.98**



## HO Carr's Parts - Kit

Woodland Scenics DPM  
Landmark Structures.  
4-3/4 x 3-3/4" 12 x 9.5cm  
243-11600 Carr's Parts  
Reg. Price: \$19.99  
Sale: **\$17.98**



## HO Pam's Pet Shop - Kit

Woodland Scenics DPM  
Landmark Structures.  
2-1/8 x 3" 5.4 x 7.7cm  
243-20200 Pam's Pet Shop  
Reg. Price: \$18.99  
Sale: **\$16.98**



## HO Walker Building - Kit

Woodland Scenics DPM  
Landmark Structures.  
3 x 4-1/4" 7.7 x 10.7cm  
243-20400 Walker Building  
Reg. Price: \$18.99  
Sale: **\$16.98**



## HO Victorian Style Storefront Building - Kit

Woodland Scenics DPM  
Landmark Structures. Modular design contains plans for three buildings and all parts needed to finish one of the three.  
243-36300 Victorian Style Storefront Building  
Reg. Price: \$65.99  
Sale: **\$58.98**



**HO Modular Learning Kit**  
Woodland Scenics® DPM  
Landmark Structures™  
5-3/4 x 3" 14.8 x 7.7cm  
243-36000 Modular Learning  
Kit  
Reg. Price: \$14.29  
Sale: **\$12.98**



**HO 20th Century Storefront Building - Kit**  
Woodland Scenics DPM  
Landmark Structures. Modular design contains plans for three buildings and all parts needed to finish one of the three.  
243-36400 20th Century Storefront Building  
Reg. Price: \$65.99  
Sale: **\$58.98**



**HO Steel Sash Industrial Building - Kit**  
Woodland Scenics DPM  
Landmark Structures. Modular design contains plans for three buildings and all parts needed to finish one of the three.  
243-36500 Steel Sash Industrial Building  
Reg. Price: \$65.99  
Sale: **\$58.98**

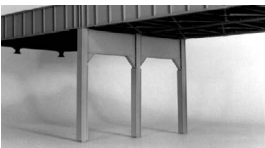

**HO Bridge Support - Kit**  
Micro Engineering.  
3-3/8 x 9-1/2" 8.4 x 24cm  
255-80175 Bridge Support  
Reg. Price: \$9.70 Sale: **\$8.49**

**HO Tall Steel Viaduct Tower - Kit**

Micro Engineering.  
4-1/2 x 4-1/2"  
Base x 10" High  
255-75169 Two  
3-Story Bents  
Reg. Price: \$13.15  
Sale: **\$11.98**

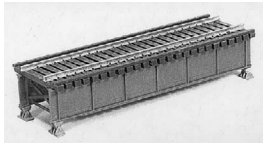

**HO 30' Deck-Girder Bridge - Kit**  
Micro Engineering. 4-1/8 x 1-3/8"  
10.5 x 3.5cm  
255-75502 w/Open Deck  
Reg. Price: \$9.95 Sale: **\$8.98**



**NEW HO Strawberry Stand - Kit**  
Faller. 2 x 2 x 2-3/8" 5 x 5 x 6cm  
272-130260 Strawberry Stand  
Reg. Price: \$26.99  
Sale: **\$22.98**



**NEW HO Commercial Feed Supplier - Kit**  
Faller. Includes silos and features prototypically colored plastic parts with great details.  
7-1/2 x 4-5/8 x 10-5/8"  
19 x 12.4 x 27cm,  
6 x 5-1/8 x 7-7/8"  
15 x 13 x 20cm  
272-130465 Commercial Feed Supplier  
Reg. Price: \$87.99  
Sale: **\$73.98**



**HO Hornum Lighthouse - Kit**  
Faller. Equipped with a beacon that flashes at regular intervals and powered by a 12-16V AC unit.  
2-11/16 x 2-11/16 x 13-1/4" 6.8 x 6.8 x 33.6cm  
272-131010 Hornum Lighthouse w/Beacon  
Reg. Price: \$119.99  
Sale: **\$99.98**



**HO Railroad Radio Transmitter Station - Kit**  
Faller. 4-3/8 x 1-5/8 x 1-1/2"  
11 x 4.2 x 3.6, 1 x 1 x 23.4cm  
272-120215 Transmitter Station (red brick)  
Reg. Price: \$29.99  
Sale: **\$24.98**



**HO Yard Office - Kit**  
GCLaser.  
3-1/4 x 2-1/2 x 2-1/8"  
292-1255 Yard Office  
Reg. Price: \$12.99  
Sale: **\$11.49**



**HO Open Storage Shed - Kit**  
GCLaser. 2-15/16 x 2-7/8 x 1-9/16"  
292-1296 Open Storage Shed  
Reg. Price: \$20.99  
Sale: **\$18.98**



**HO Tool House - Kit**  
GCLaser. 4-13/16 x 2-1/8 x 2-1/4"  
292-1298 Tool House  
Reg. Price: \$17.99  
Sale: **\$15.98**

**HO Flat-Top Silo - Kit**  
GCLaser.  
3-9/16 x 3-3/8 x 7-3/4"  
292-13122  
Flat-Top Silo  
Reg. Price: \$29.99  
Sale: **\$26.98**



**HO Oil Tank - Kit**  
Tichy  
293-7013  
Oil Tank  
Reg. Price: \$15.00  
Sale: **\$12.98**

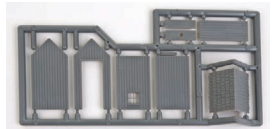

**HO Outhouse - Kit**  
Tichy  
293-8166 Outhouse pkg(3)  
Reg. Price: \$5.95 Sale: **\$4.98**



**HO Wood Trestle Bents - Assembled**  
Grand Central Gems. 5" Tall  
295-TB2 Medium pkg(5)  
Reg. Price: \$20.00  
Sale: **\$17.98**

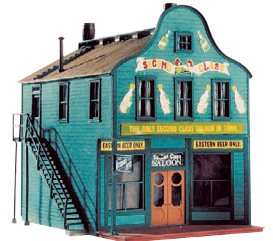

**HO Second Class Saloon - Kit**  
Grandt Line. 4-3/4 x 3-1/8"  
12 x 8cm  
300-5900 Second Class Saloon  
Reg. Price: \$29.95  
Sale: **\$25.98**



**HO Corrugated Iron Warehouse - Kit**  
Grandt Line. 4-3/4 x 6-1/4"  
11.9 x 15.7cm  
300-5908 Corrugated Iron Warehouse  
Reg. Price: \$26.95  
Sale: **\$23.98**



**HO Relay House - Kit**  
Grandt Line  
300-5910 Relay House  
Reg. Price: \$6.00 Sale: **\$5.29**



## HO Valley Feed & Seed - Kit

Grandt Line  
300-5911 Valley Feed & Seed  
Reg. Price: \$27.50  
Sale: **\$23.98**



HO Suburban House - Kit  
Heljan. 4 x 3-5/8 x 2-3/8"  
10 x 9 x 6cm  
322-1773 Suburban House  
Reg. Price: \$15.98  
Sale: **\$13.98**



HO Farm House - Kit  
Heljan. 7-1/16 x 4-7/8"  
18 x 12.5cm  
322-1791 Farm House  
Reg. Price: \$19.98  
Sale: **\$16.98**



HO House Against City Wall - Kit  
Heljan. 4-1/2 x 3-3/8"  
11.5 x 8.5cm  
322-1797 House Against City Wall  
Reg. Price: \$24.98  
Sale: **\$21.98**



HO Museum - Kit  
Heljan  
322-1799 Museum  
Reg. Price: \$24.98  
Sale: **\$21.98**



HO Customs House - Kit  
Heljan. 11-1/2 x 9-13/64  
x 4-13/32" 28.7 x 23 x 11cm  
322-2019 Customs House  
Reg. Price: \$31.98  
Sale: **\$27.98**



HO High Rise Building - Kit  
Heljan. 7-5/64 x 5-1/8 x  
11-1/32" 18 x 13 x 28cm  
322-1713 High Rise Building  
Reg. Price: \$32.98  
Sale: **\$28.98**



HO Schmiege's Little Dutch Store - Kit  
JL Innovative Design  
361-411 Schmiege's Little Dutch Store  
Reg. Price: \$49.95  
Sale: **\$43.98**



HO Farm House - Kit  
Model Power. 3 x 7"  
7.7 x 17.7cm  
490-433 Farm House  
Reg. Price: \$24.98  
Sale: **\$18.98**



HO Brewery - Kit  
Model Power  
490-451 Brewery  
Reg. Price: \$29.98  
Sale: **\$22.98**



HO Citibank - Assembled  
Model Power  
490-675 Citibank  
Reg. Price: \$35.98  
Sale: **\$27.98**



HO Chester Station - Assembled  
Model Power  
490-676 Chester Station  
Reg. Price: \$31.98  
Sale: **\$24.98**



HO Railroad Signal Building - Kit  
Model Power  
490-403 Railroad Signal Building  
Reg. Price: \$20.98  
Sale: **\$15.98**



HO Ranger Lookout - Kit  
Model Power  
490-438 Ranger Lookout  
Reg. Price: \$19.98  
Sale: **\$15.98**



HO Jurgens Junk Yard - Kit  
Monroe Models. Includes laser-cut wood Quonset hut, corrugated metal roofing material, white-metal castings, resin scrap metal junk pile, fencing and signs.  
493-2204 Jurgens Junk Yard  
Reg. Price: \$59.95  
Sale: **\$52.98**



HO Dairy Barn - Kit  
Northeastern Scale Models  
520-40009 Dairy Barn  
Reg. Price: \$25.35  
Sale: **\$21.98**



HO Curved Steel Bridge - Kit  
Noch. 7 x 15/16" 18 x 2.4cm  
528-21350 Curved Steel Bridge  
Reg. Price: \$13.99  
Sale: **\$11.98**



HO The Warehouse - Kit  
Pikestuff. 4-1/8 x 8-1/4"  
10.8 x 21cm  
541-4 The Warehouse  
Reg. Price: \$17.95  
Sale: **\$14.98**



HO Auto Repair Shop - Kit  
Pikestuff. 3-1/2 x 8-1/4"  
9 x 21cm  
541-9 Auto Repair Shop  
Reg. Price: \$19.95  
Sale: **\$16.98**



HO Distribution Center - Kit  
Pikestuff. 9-5/8 x 5-1/2"  
24.5 x 14cm  
541-10 Distribution Center  
Reg. Price: \$17.95  
Sale: **\$15.98**



HO Piping & Mechanical Contractors - Kit  
Pikestuff  
541-103 Piping & Mechanical Contractors  
Reg. Price: \$24.95  
Sale: **\$21.98**