

Building #1 w/2-Story Office

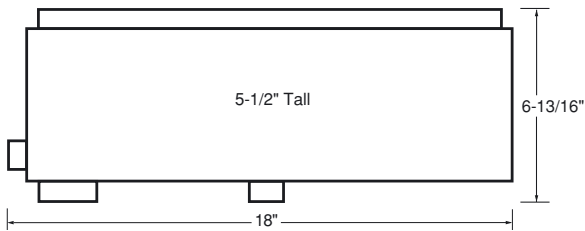

Tools Needed:

- Sprue Cutter
- Hobby Knife with New Blade
- Liquid Cement for Styrene Plastic
- Small Applicator Brush
- Fine Sandpaper

*Find a complete selection of tools in the
Walthers Reference Books or at walthers.com*

Getting Started:

Gather Modulars packages as listed on the Bill of Materials (www.walthers.com/exec/page/modular_transfers) and make sure you have the necessary tools as listed above. Lay out the parts as shown in the instructions for each building. Each Modulars part has a unique number embossed on the back of the part or the sprue. Refer to these numbers when building your structure. All walls assemble using flat pilasters in the center and V-shaped pilasters at outside corners. For best alignment, use liquid plastic cement. Gels and CA glues will add thickness between parts causing misalignment. Painting is easier to do before assembly however, if you plan to paint the parts first be sure to use a thin layer of paint. A thick paint application will affect the alignment of parts during assembly.

1. Carefully remove pieces from sprue and arrange as shown (figs. a, b, c).

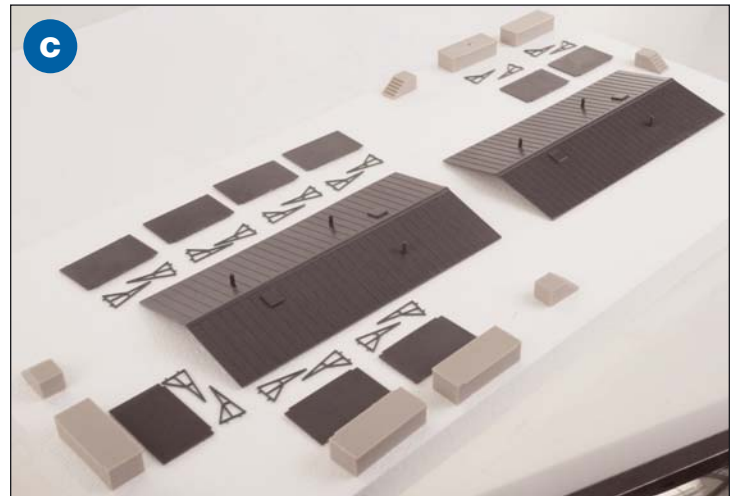
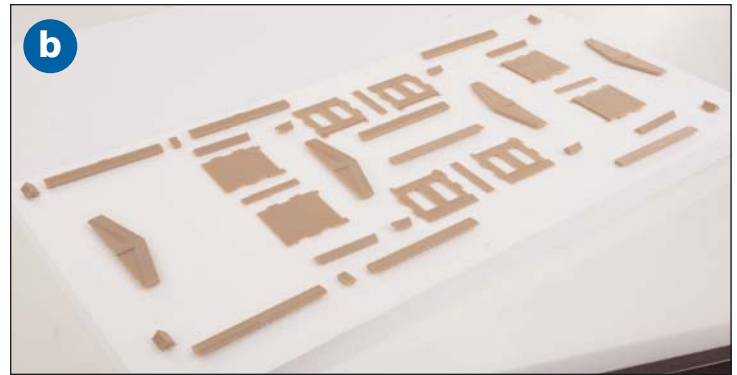
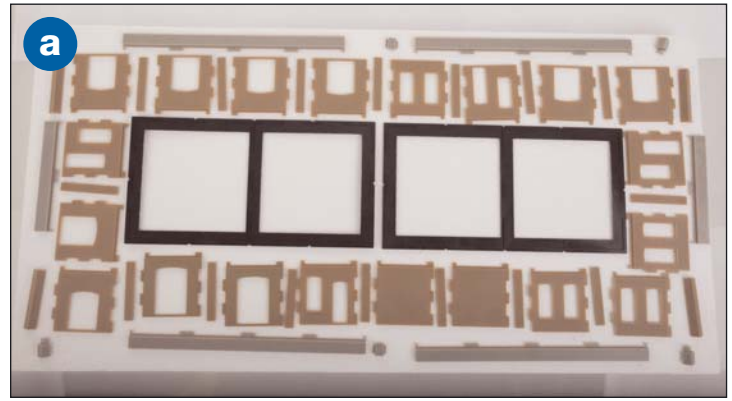

From 933-3720 Peaked Roof & Base:

- #1 Base x 2. Remove parts from inside the bases and make sure the tabs are facing up.
- #32 Peaked Roof x 2. Cut one roof section in half by continuing to score the middle of the roof. File off any rough edges.
- #36 Roof Canopy x 9 (Note: One canopy will come from 933-3721)

From 933-3721 Flat Roof & Base:

- #36 Roof Canopy x 1

From 933-3722 Small Walls, Windows & Doors:

- #16 Small Wall w/No Opening x 6
- #17 Small Wall w/Window Opening x 8
- #18 Small Wall w/Door & Window Opening x 4
- #19 Small Wall w/Double-Wide Door Opening x 8
- #37 Canopy Support x 18

From 933-3724 Foundation & Loading Docks:

- #5 Large Foundation x 4
- #6 Medium Foundation x 2
- #8 Corner Connector x 4
- #9 Flat Connector x 2
- #12 Steps x 3
- #14 Dock Section x 9

From 933-3725 Wall Columns & Caps:

- #23 Corner Pilaster x 8
- #25 Side Pilaster x 20
- #24 Outside Corner Connector x 8
- #26 Cornice Connector x 2
- #27 Flat Cornice x 8
- #29 Peaked Roof Cornice x 4

From 933-3731 Small Walls w/Single Arched Window:

- #59 Wall w/Dock Door x 2

2. To ease assembly, build each wall as a flat section complete with foundations and cornices.

3. Glue long and short wall sections for first and second stories to side pilasters (#25), aligning tabs on walls and pilasters. *Note:* Aligning tabs do not interlock – they remain spaced apart to allow the glue to evaporate.

4. Before attaching walls to first floor, remove a piece of the horizontal alignment tab at the top corner of each first-story wall adjacent to the two-story section as shown (**figs. d, e**). A hobby knife or sprue cutter works best.

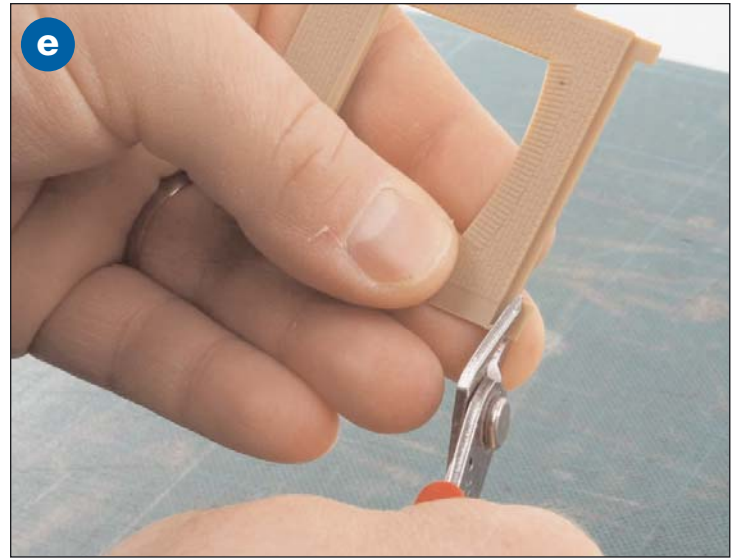

5. Using horizontal alignment tabs glue the small walls with windows (#17) to the first floor.

6. Attach foundation pieces (#5 & #6) to bottom of first-floor walls using flat connectors (#9).

7. Attach flat and peaked cornices (#27 & #29) using cornice connectors (#26).

8. Attach corner pilasters (#23), outside cornice connectors (#24) and foundation corner connectors (#8) to opposite corners on one side of each wall, keeping all pieces flat (**fig. f**).

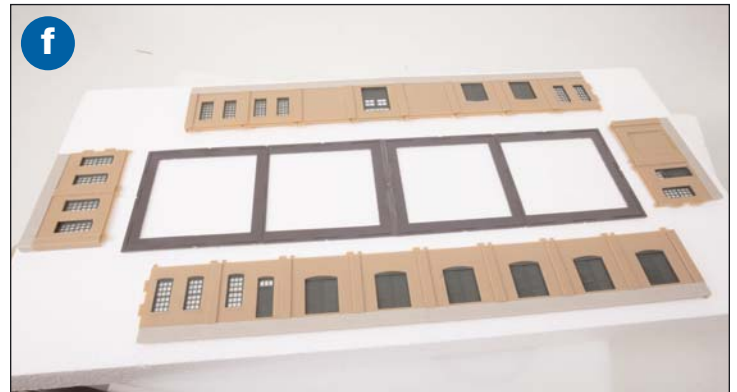

9. Fit and glue doors #43 & #45 and windows #47 to all wall sections making sure raised half of windows is at the bottom. Allow glue to dry then, using a white glue that dries clear, attach “glass” #52 to windows and doors with the raised half at the top and the smooth side on the back.

10. Assemble the first story corners holding walls at a 90 degree angle and gluing from the inside (figs. g, h, i, j).

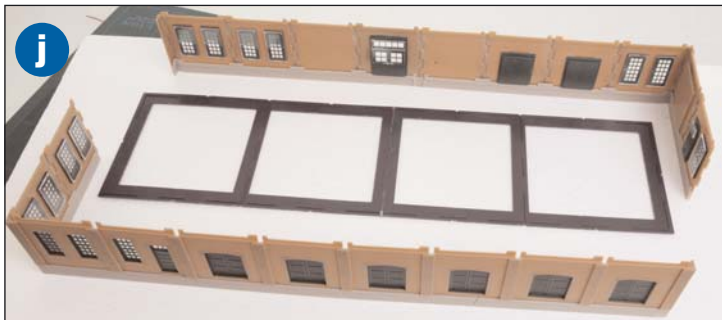
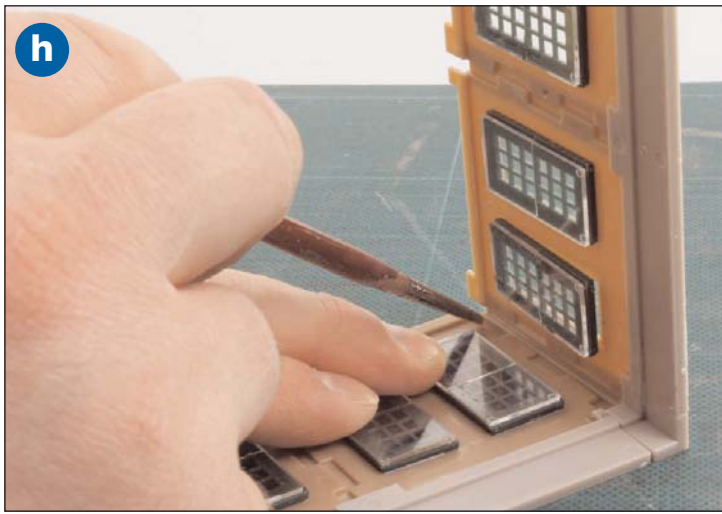

11. Attach the second story side walls (#16) keeping walls at a 90 degree angle and gluing from the inside (fig. k).



12. Trim bases at scribe and glue together as shown (fig. l). Glue base to bottom of first-story walls.



13. Place building on a flat level surface and attach steps and docks.

14. Attach canopy supports to canopies (fig. m).



15. Glue canopies to walls. For better fit on the four-canopy section, file down the corner notches on the inside sections and prefit the entire section before gluing the canopies individually to the walls.

16. Cut one peaked roof section in half for the second story roof. Trim the other half on the scribe line. Cut a notch at each corner and in the center to fit the roof over the second-story pilasters. Trim the full roof section at the scribe line and cut notches at the corners and center to the second-story pilasters (**figs. n, o, p**).

