

**HO Scale  
Detail Kit  
933-2964**

## COKE OVEN DETAILS

### Larry & Quench Cars

Thanks for purchasing this Cornerstone Series® kit. All parts are made of styrene, so use only compatible paints and glues. Please read the instructions and study the drawings before starting.

This kit includes parts for the larry and quench cars that match those

supplied with the Ashland Iron & Steel Coke Ovens & Quench Tower kit 933-2972, sold separately.

#### **Please Note:**

If you plan to use these cars with the previous Cornerstone Series Coke Oven & Quencher kit (933-3053, discontinued), the overhead

coal storage bunker must be raised to clear the larry car. This will require your own modified or scratchbuilt spacers or supports.

### Larry Car

1. Glue the bogie beams (1, 33) to the platform bottom (9) as shown.

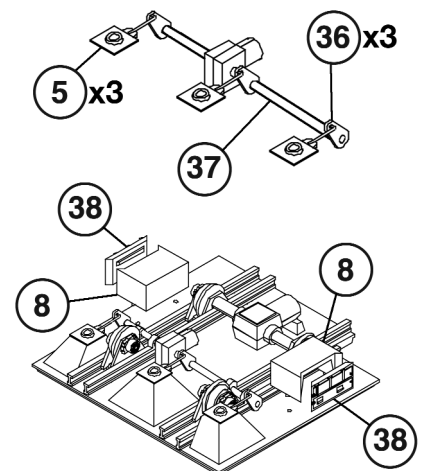
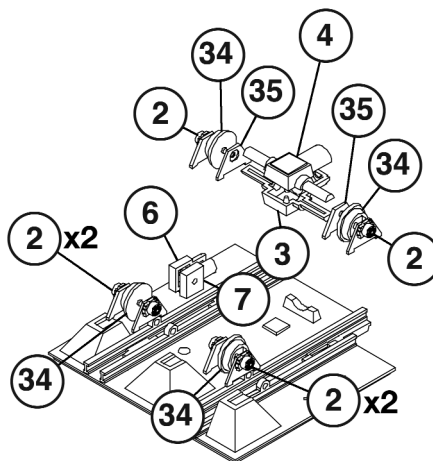
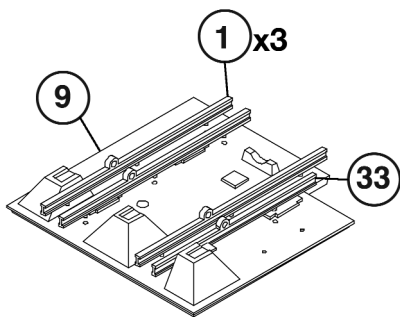

2. Place the pins of the wheels (34) into the holes of both of the bogie details (2) and glue that assembly to the platform bottom, near the hoppers, in between the bogie beams. Note: Make sure that the wheel flanges face towards the inside and that you do not get any glue on the wheel pins. There are slots engraved on the platform bottom where the flanges go over.

3. First glue the gearbox (3, 4) together, and then glue the plates (35) onto the ends of the axles. Place the pins of the wheels (34) into the holes of the end plate and the bogie detail (2) and glue this assembly in position on the platform bottom. Note: Again, the wheel flanges will sit over the slots in the bottom.

4. Glue the hopper gate motor (6, 7) together and in place on the platform bottom.

5. Slide the drive shaft (37), first through the rings of the bogie beams on the right side, then slide a hopper gate (36) onto the shaft. Continue sliding the shaft through the hopper gate motor. Add hopper gates (36) at each end and position all the covers (5) so that they will cover the hoppers and then glue them in place.

6. Glue the battery boxes (8, 38) together and to the platform bottom.

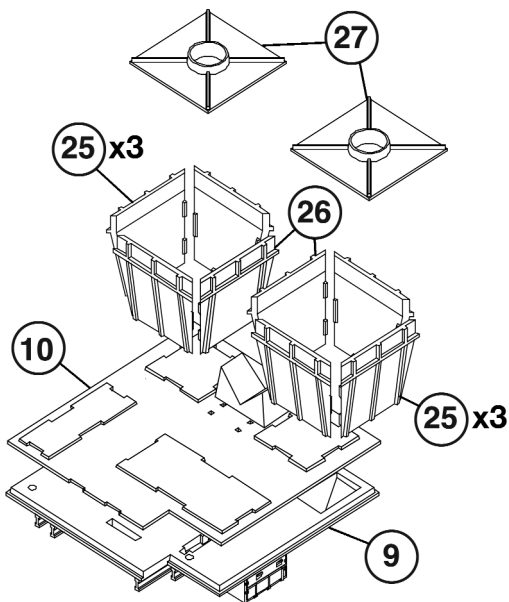

7. Glue the platform top (10) onto the platform bottom (9).

8. Glue the bunkers (25, 26, 27) together, as illustrated, and to the platform top.

9. Glue the ladders (28) in place to the sides of the bunkers.

10. Glue the operator's cab (16, 17, 18, 19, 20) together and in place on the platform top.

11. Glue the electrical cabinet (11, 12, 13, 14, 15) together and in place on the platform top.

13. Glue the short conduits (31) into the holes at the bottom of wall #12 and into the holes at the top of wall #17. Glue the long conduit (32) into the hole at the bottom of wall #12 and also the hole at the top of wall #16.

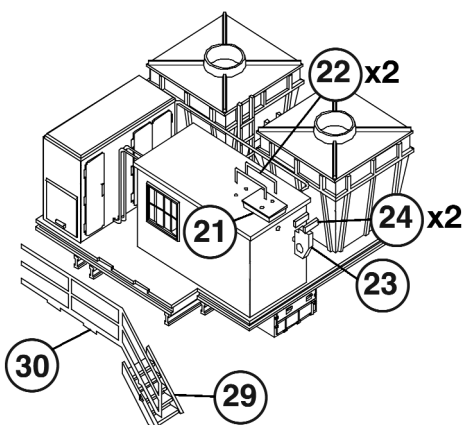
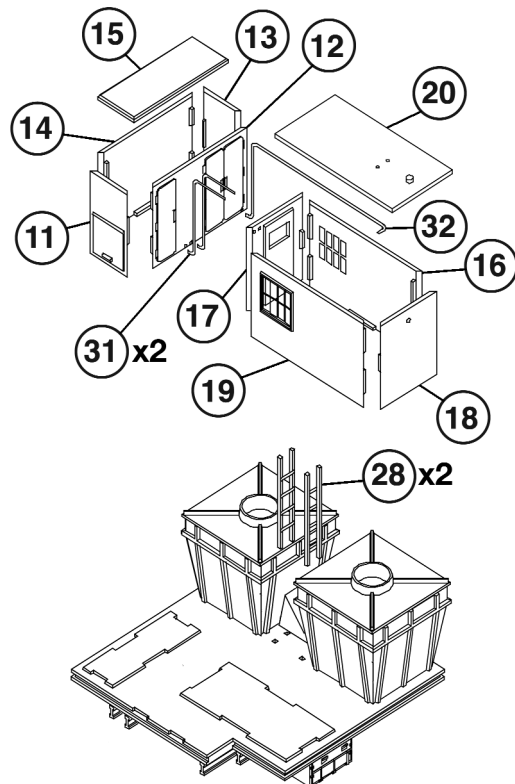

13. First glue the electrical box (21) on top of the operator's cab. Then glue the small conduits (22) into the holes in both the box and the roof.

14. Glue the pick up shoes (24) to the top of the trolley bracket (23). Then glue the bracket into the hole on the side of wall #18.

15. Glue the railing (30) to the edge of the platform. Note: The tabs on the bottom of the railing fit into the slots on the edge of the platform. Glue the ladder (29) in place.

# Quench Car

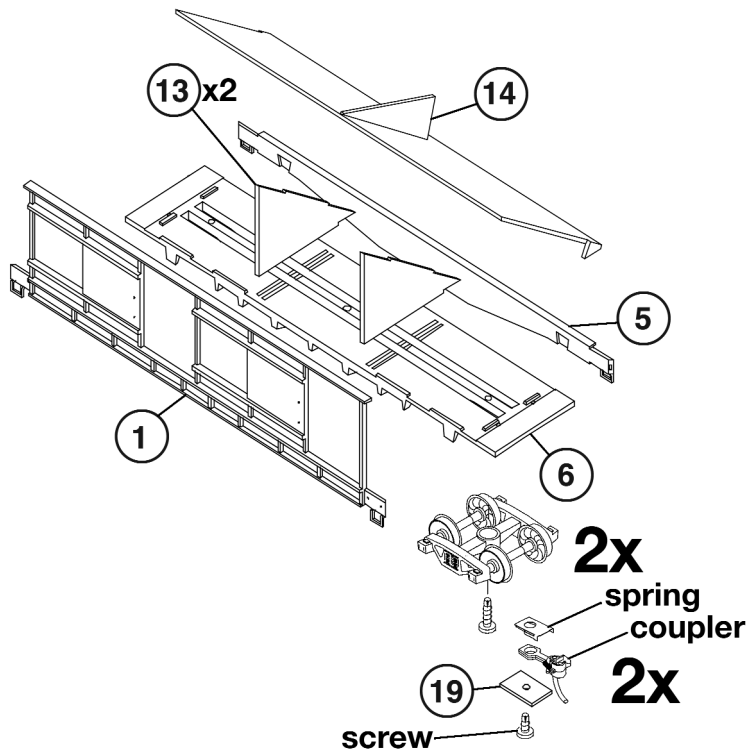

1. Insert spring and coupler into coupler pocket and screw on the coupler pocket cover.
2. Screw trucks in place on the bottom of the floor (6).
3. Glue the low side (1) to the floor (6). Then glue the supports (13) to the floor and side.
4. Glue the side frame (5) to the side of the floor (6).
5. Glue the slope sheet (14) in place on top of the supports.

6. Glue the ends (2, 3) in place. Then glue the high side (4) to the ends and the slope sheet.

7. Glue the end supports (17, 18) to the backs of the end slope sheets (15, 16) as illustrated. Glue the end slope sheets onto the ends of the car, underneath the horizontal brace on the ends. Glue the ladder (21) to #15.

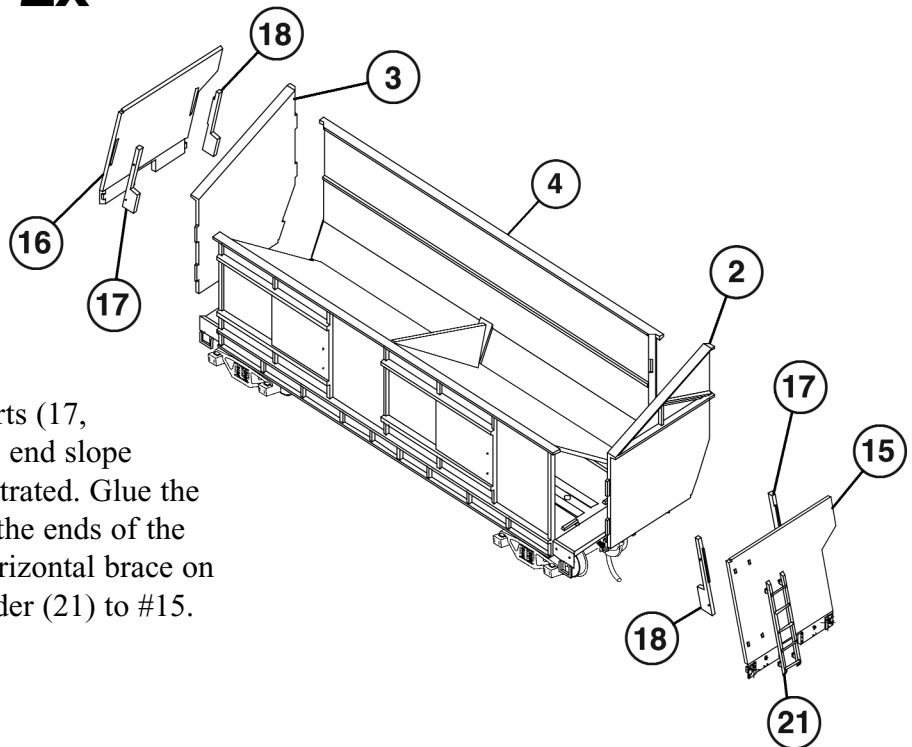

8. Using a #80 drill bit, drill holes at all dimples where the metal hand grabs will be inserted. Note: The smallest grabs are for the ends and sides of the frame. The middle size grabs are for the doors on the side. The longest grabs go on the sides of the end slope plates. After drilling, insert the grabs into the holes. Use a small drop of glue or paint to hold them in place.

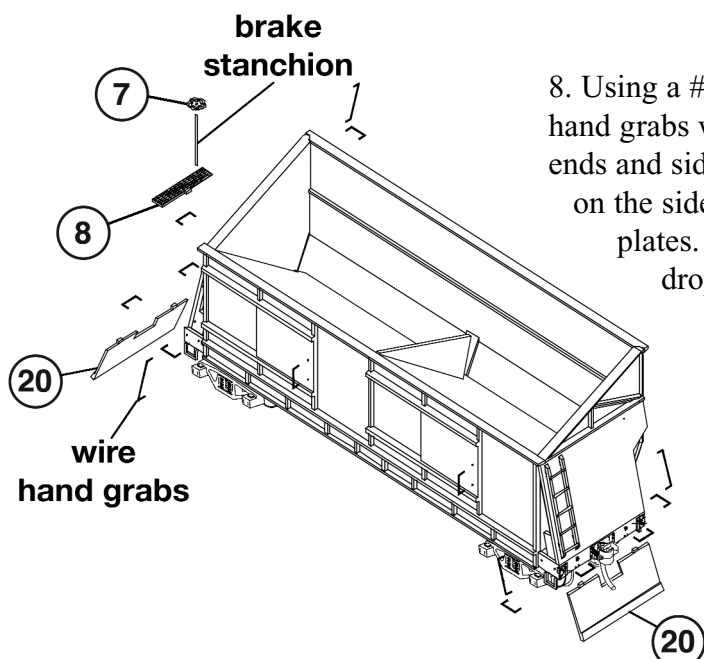

9. Glue the end truck shields (20) to the bottom of the floor. Note: There are holes in the bottom of the floor that accommodate the notches on the top edge of the shields.

10. Glue the brake platform (8) into the notch in #3, above the supports. Glue the brake wheel (7) to the top of the metal brake stanchion. Then insert the stanchion through the hole in the platform and glue in place.

## Conveyor

1. Assemble the conveyor by gluing the sides (69, 70) to the floors (68) and then to each other, using the tabs to position correctly. Then glue the roofs (71) on top.
2. Glue the pads (66) onto the bottom of the support (67).

