

**HO Scale  
Detail Kit  
933-2965**

## BLAST FURNACE DETAILS

### Stairways & Railings

Thanks for purchasing this Cornerstone Series® kit. All parts are made of styrene, so use only compatible paints and glues. Please read the instructions and study the drawings before starting.

This kit includes parts for the skip hoist stairways, walkway details and railings for one side of the high line.

#### Please Note:

If you plan to use these details with the previous Cornerstone Series Blast Furnace kit (933-3054, discontinued), you will have to do the following:

1. An angled stairway platform must be scratchbuilt to connect the top of the stairway and the bell platform.

2. Remove the outside alignment pegs on the #279 stairway pieces.

3. The stove platform on the old blast furnace will have to be extended with your own scratchbuilt walkway to accommodate the new railings (parts 224 and 225).

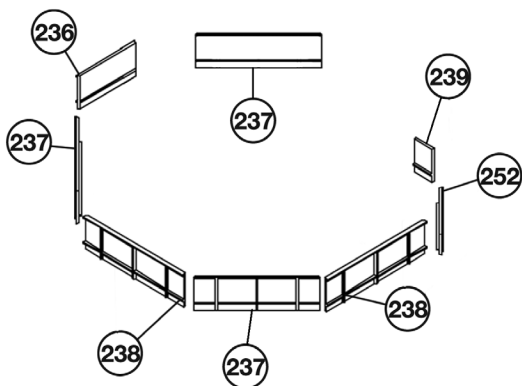

1. Glue the furnace platform railings (236, 237, 238, 239, 252) in place around the edge of the platform (not included).

2. Glue the side (224, 225) and end (223) railings around the stove platform (not included).

3. Glue the cage ladders (234, 235) together and then to railing #225 at the openings. Glue the platforms (226, 227, 228, 229, 230, 231, 232, 233) together. Then glue these to the sides of the stoves (not included), below the ladders.

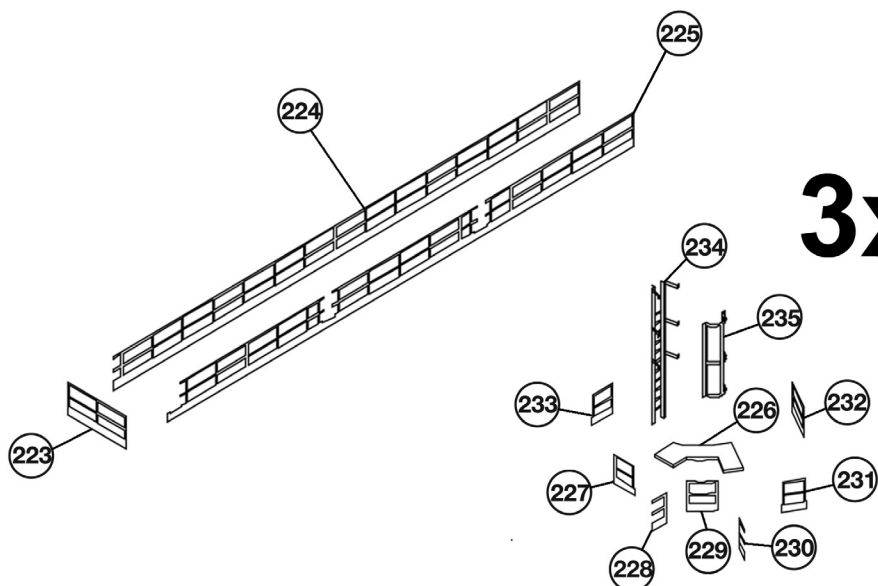

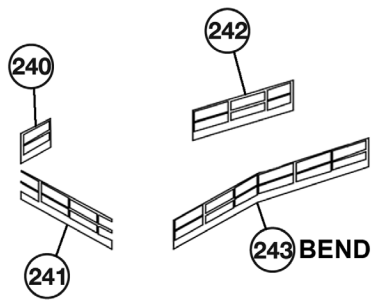

4. Glue the railings (240, 241, 242, 243) around the edge of the upper elevator walkway (not included).  
Note: Bend railing #243 at the groove on the back to follow the edge of the walkway.

5. Glue the railings (255, 256, 257, 258, 259, 260, 261, 262) in place around the trolley support walkway (254).

6. Glue the side stairway (214, 215, 216, 217, 218, 219, 220) together as shown. This can then be glued to #210 in step 11.

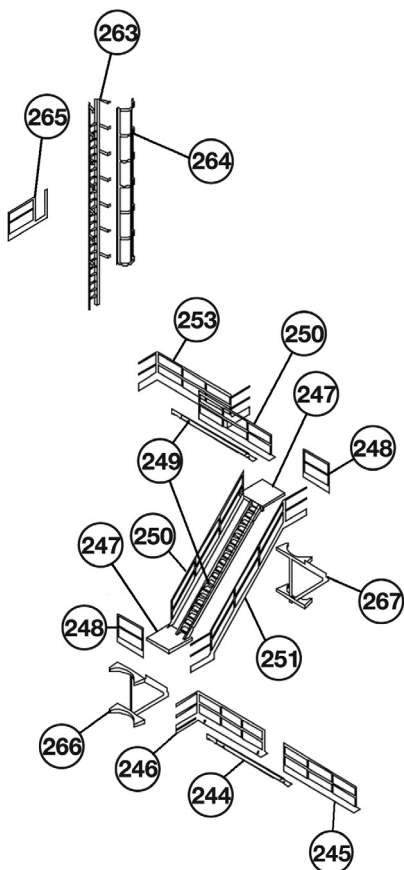
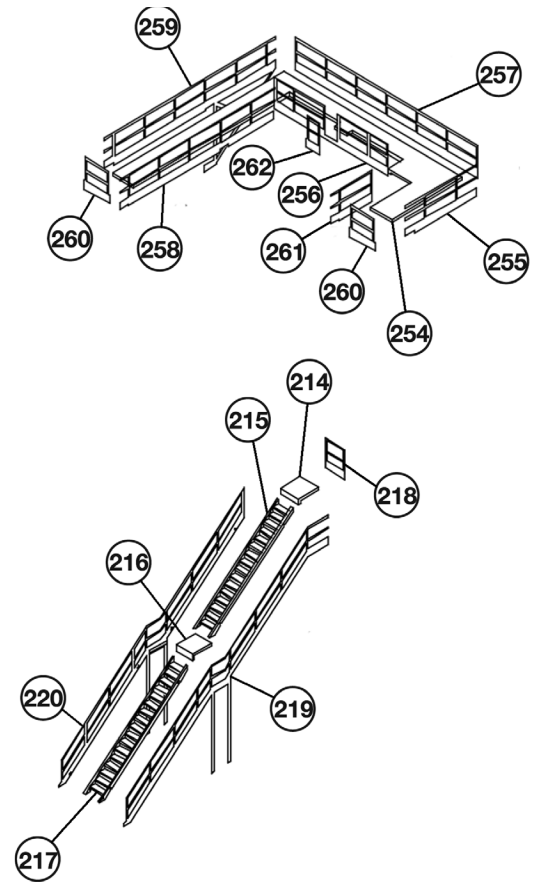

7. Glue the end railing (265) in place on the end of the offtake platform (not included).

8. Glue the cage ladder (263, 264) together. Then glue the ladder in front of the opening on #265 and in front of railing #262 shown in step #5.

9. Glue the bell platform stairway (244, 245, 246, 247, 248, 249, 250, 251, 253) together. Start from the bottom and work up. When completed, glue the stair platform braces (266, 267) underneath the two platforms (247). The top of this stairway can be glued to walkway #254 in step 5.

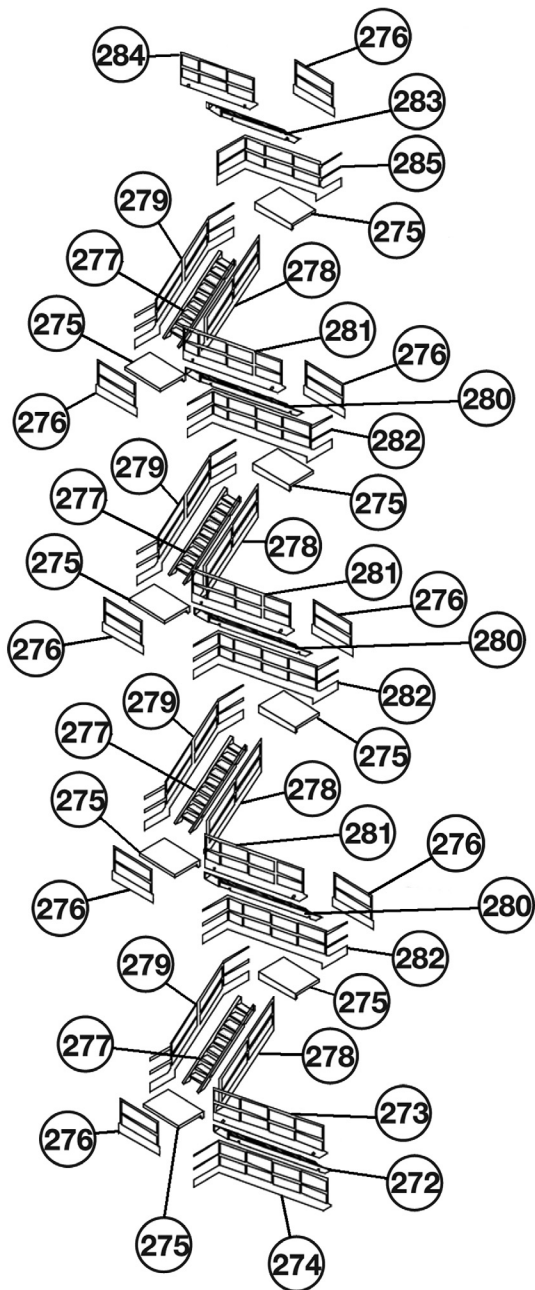

completed stairway

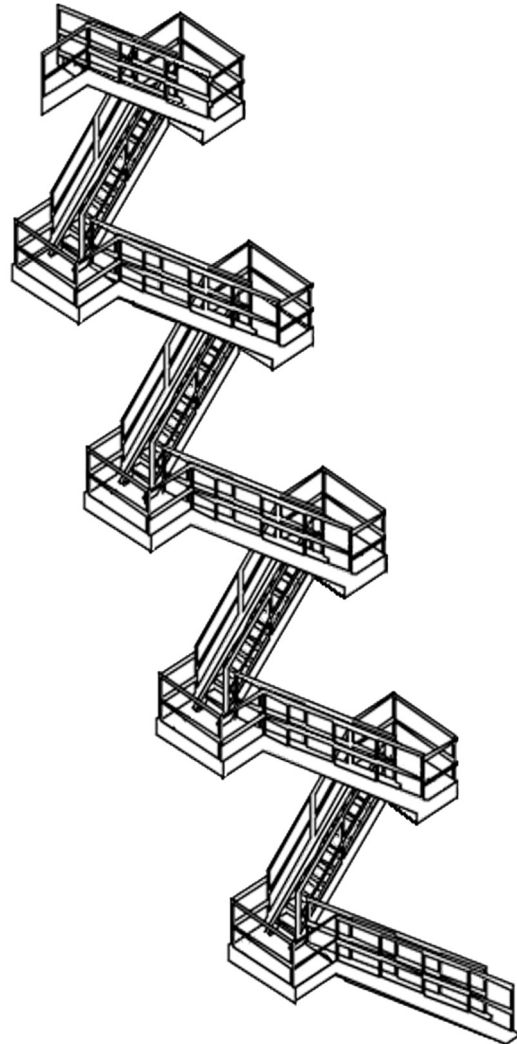

10. Starting at the bottom, glue the skip hoist stairway together. The parts breakdown is as follows: platforms (275); end railings (276); inside railings (273, 278, 281, 284); outside railings (274, 279, 282, 285); stairs (272, 277, 280, 283). Once completed, glue in place along the side of the skip hoist and to the right end of the bell platform.

Note: Remove the pegs on the sides of parts #279 if adding to Blast Furnace Kit (933-3054 discontinued).

11. Glue the railings (201, 202, 203, 204, 205, 206, 207, 208, 209, 210, 211, 212, 213) around the side of the casting house floor (not included) in the arrangement shown. Note: Railing #205 must be bent at the groove in the back to fit on the side of the floor.

