



N Structure Kit CLARKESVILLE DEPOT 933-3240

Thanks for purchasing this Cornerstone Series® kit. Please read these instructions and study the drawings before starting. All parts are styrene, so use compatible glue and paint to assemble your model.

With its classic lines, your new depot is typical of small town stations built throughout the US and fits well in steam- or diesel-era scenes. Standard features, like the bay window, freight doors, large windows and "wood" siding were common elements of depots built by virtually all American railroads. The kit also includes two styles of roof trusses (a prominent form of decoration) which can be used to give your finished model a different appearance. Although the parts are molded in colors, the model can be painted in a standard scheme to match your favorite prototype. Nearby railroad buildings should be painted to match.

While the depot was located trackside, it was often part of, or within a block or so of the business district Merchant's Row II (933-3224), State Street Stores (933-3209) and the University Avenue Shops (933-3208) can be used together or separately to model a typical downtown scene. Industries like the Farmer's Cooperative Rural Elevator (933-3238), Sunrise Feed Mill (933-3239), Interstate Fuel & Oil (933-3200) or O.L. King & Sons Coal Yard (933-3216) would also be found near a small town depot.

For more ideas to detail your scene, ask your dealer, visit our Web-site waltherscornerstone.com or see the latest Walthers N&Z Scale Model Railroad Reference Book.

1. Refer to the illustrations for part locations.

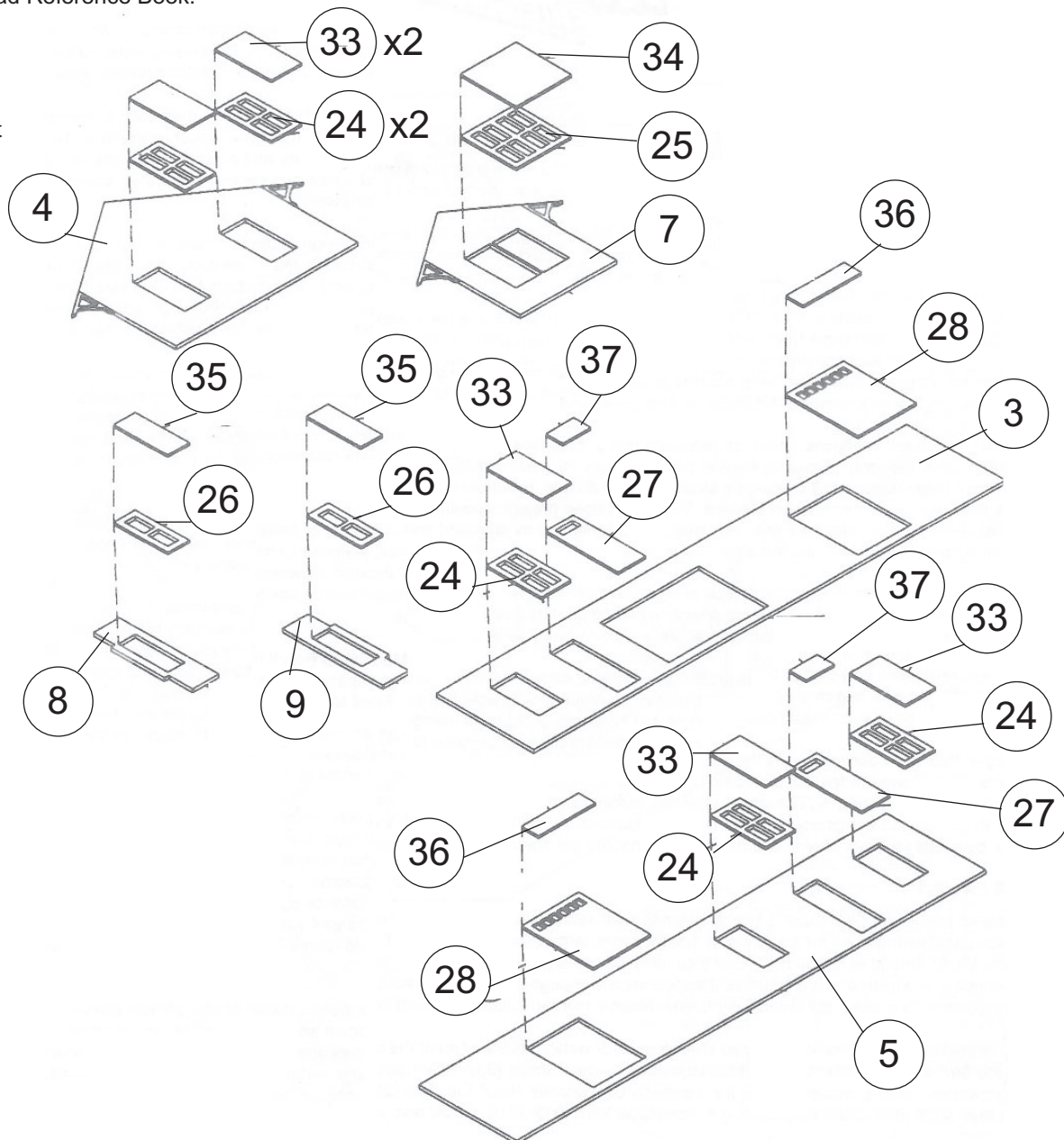

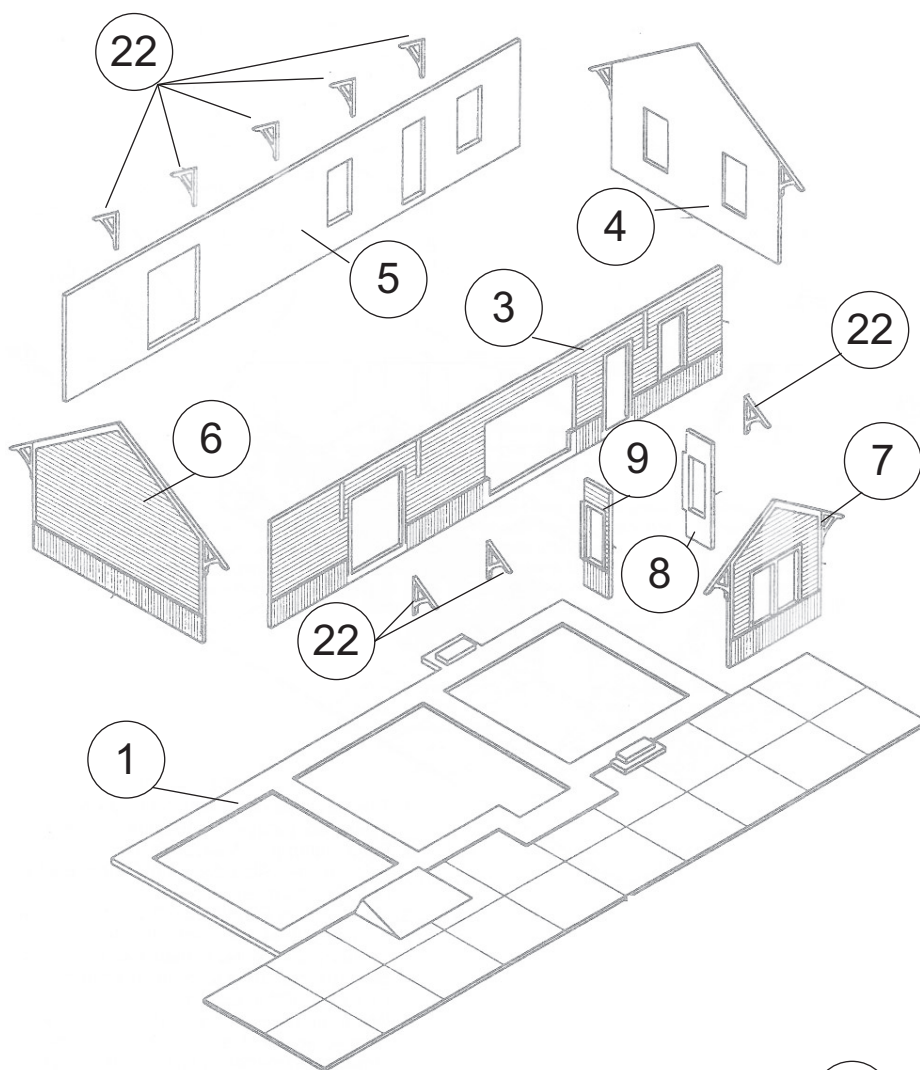

2. Glue wall (#6) to base piece (#1), making sure that the vertical locating lines on wall #6 line up with the lengthwise locating lines on the base. Then glue front wall #3 and back wall #5 to the base and to wall #6. Finally, glue wall #4 in place.

3. Glue the bay side walls (#8 and 9) to wall #3, with the tabs fitting into the notches in wall #3. Then glue the bay front wall (#7) to #8 and 9 and to the base.

4. If you have not already done so, glue the doors and windows into place as indicated in the illustrations. Make sure that the overhanging sash on the windows is on top. Then glue the clear window glazing pieces in place behind the windows, including the transom lights over the doors.

5. Glue the brackets to walls #3 and 5 in the indicated spots, making sure they do not stick up above the top edges of the walls.

6. Glue the main roof pieces (#29 and 30) to the walls. Then glue the bay roof pieces (#17 and 18) to roof #29 and to wall #7.

7. Two different styles of gable trim are provided. Parts #37 and 38 are based on Chesapeake and Ohio practice and have an "eastern road" flavor. Parts #20 and 21 are based on a Union Pacific prototype and are typical of western and Midwestern locations. Choose which style appeals to you, or omit them altogether as was sometimes the case.

8. Finish assembly by gluing chimney (#19) on roof.

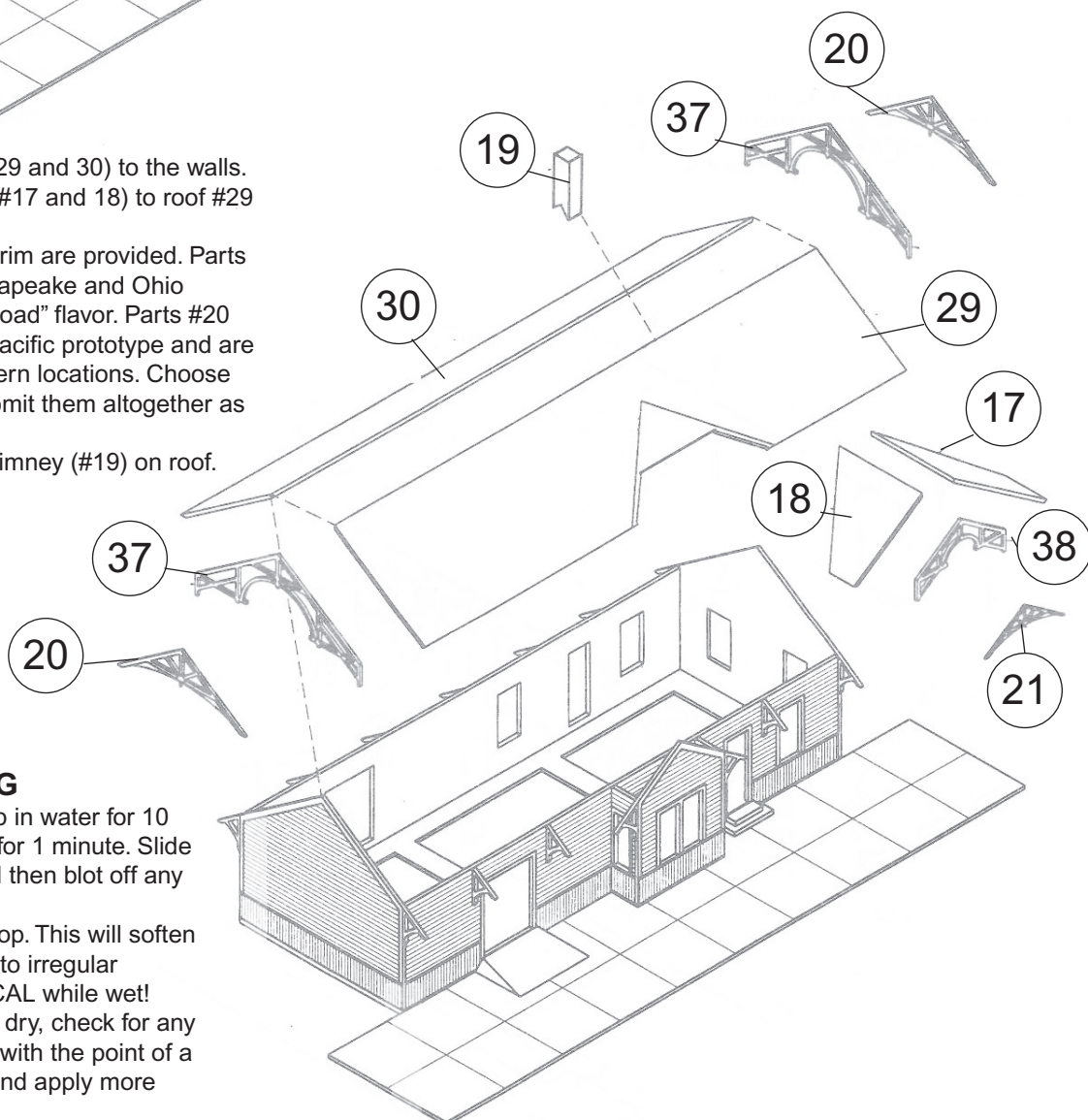

DECALING

1. After cutting out the decal, dip in water for 10 seconds, remove and let stand for 1 minute. Slide decal onto surface, position and then blot off any excess water.

2. Lightly brush Micro Sol® on top. This will soften the decal allowing it to conform to irregular surfaces. DO NOT TOUCH DECAL while wet!

3. When the decal is thoroughly dry, check for any trapped air bubbles. Prick them with the point of a small pin or hobby knife blade and apply more Micro Sol®.