



# HO Structure Kit CENTRAL GAS & SUPPLY 933-3011

Thanks for purchasing this Cornerstone Series® kit. Please read all instructions and study the drawings before starting. All parts are styrene plastic, so use compatible glue. If you wish to decorate your model, use paints for plastic models. With appropriate details and signs, your finished model fits almost any era.

Many homes and industries are heated with propane gas, and it is also used as fuel for trucks, buses and industrial vehicles. Since it can be converted to a liquid under pressure and low temperatures, it is easily shipped by rail. Propane distributors can be found throughout the country and are very common in areas with cold winter weather.

Most dealerships are fairly small since the large storage tanks are expensive to build, so most distributors have only one or two tanks. Each usually holds about one tank car load of propane, so bulk deliveries can be made weekly, especially during the busy season. A fleet of tank trucks is used for local deliveries. Due to the small size of the facility, they can be found on small or oddly shaped lots next to the right-of-way, making them an ideal business for any size layout.

Central Gas and Supply is typical of propane distributors who receive bulk shipments by rail. The finished model fits any region of the country and is adaptable to many time periods. Like the prototype, the tanks, office and other details can be arranged to fit a small or unusually shaped space.

See your local hobby dealer, Walther's Latest HO Scale Reference book or visit our Web site at [www.waltherscornerstone.com](http://www.waltherscornerstone.com) for additional accessories to complete your new scene.

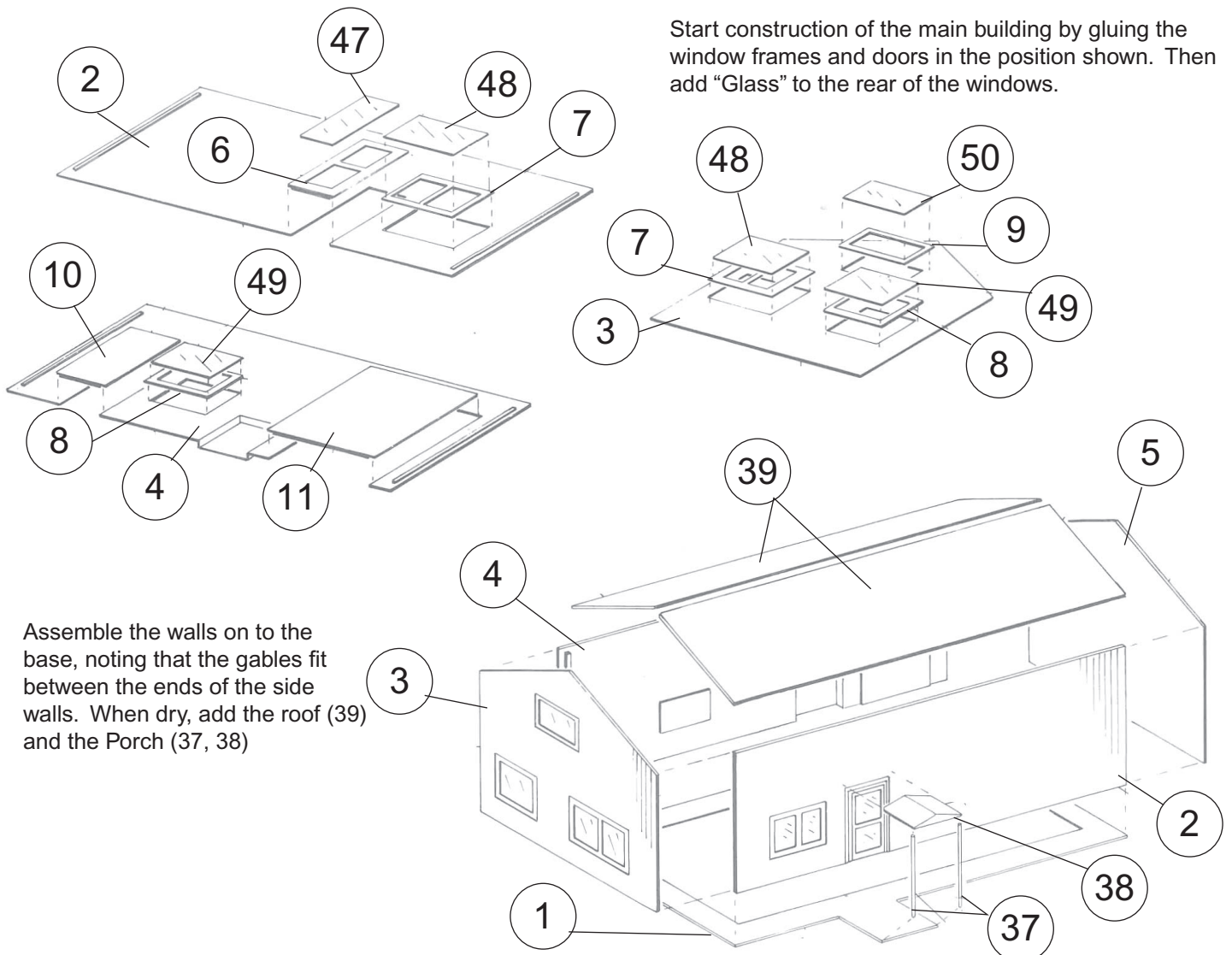

For use as anhydrous ammonia facility cut two vent pipes to approx 3/8" long.

33

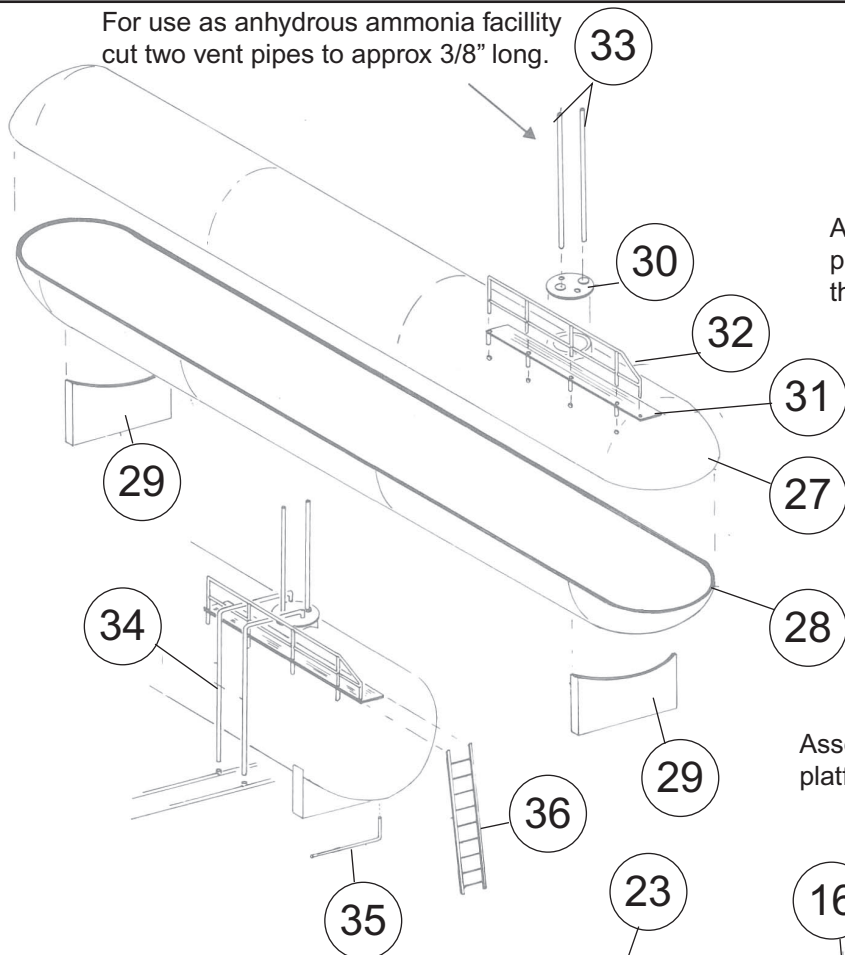

Assemble the two tanks halves (27 & 28). Add the pipes and fittings. Note that parts #34 go between the rails on Part #32

Assemble the two small buildings and platform as shown below.

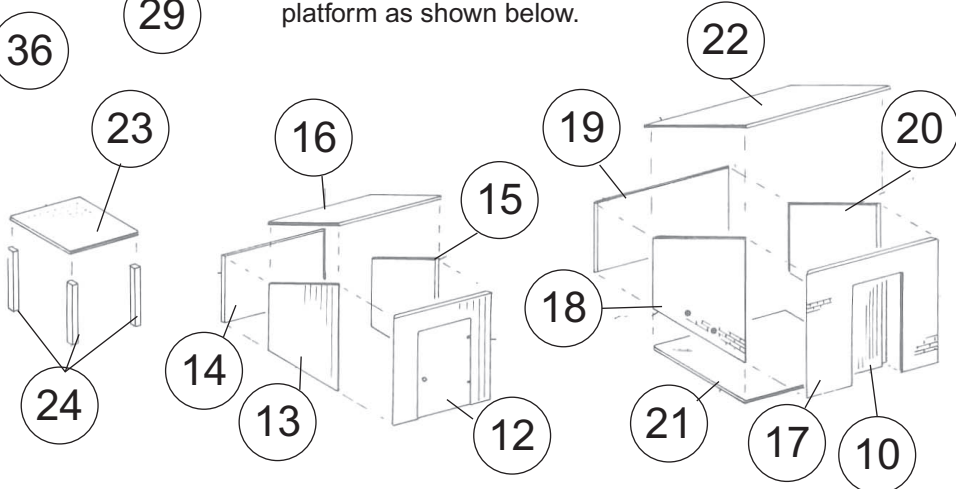

Assemble the pipe runs as shown after positioning the various components as shown in this diagram.

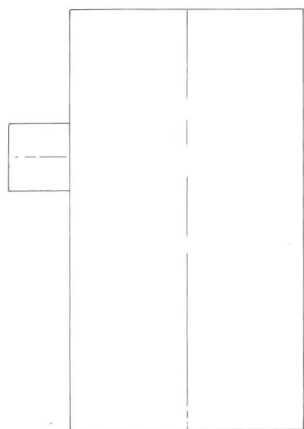

The accessories are assembled as shown and can be placed as needed around the model

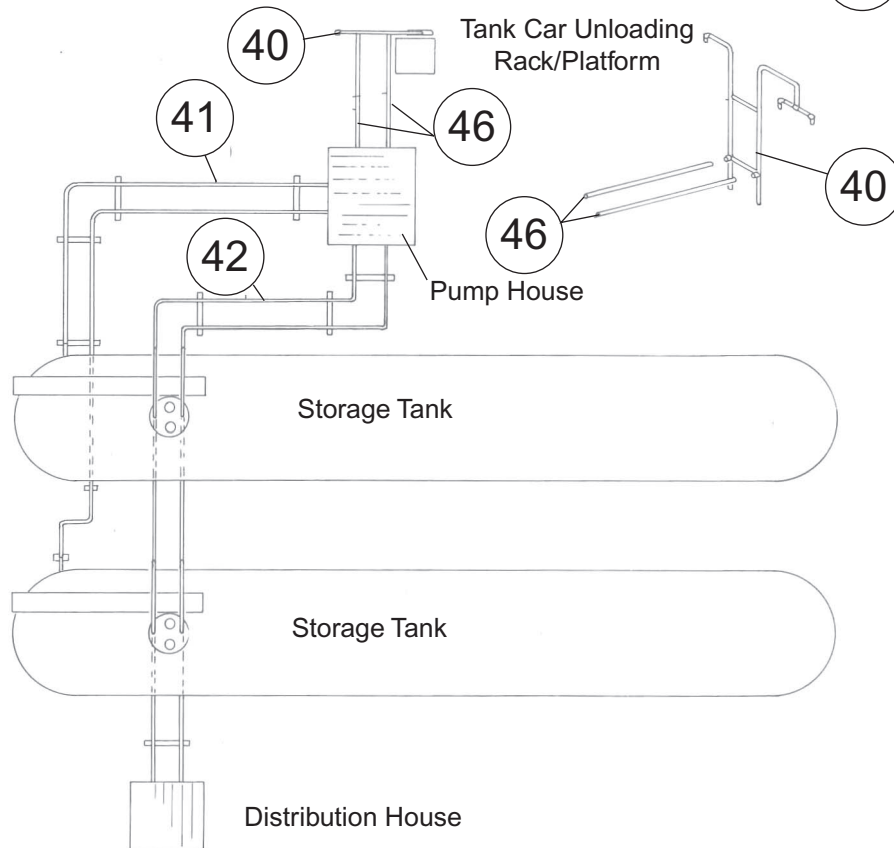
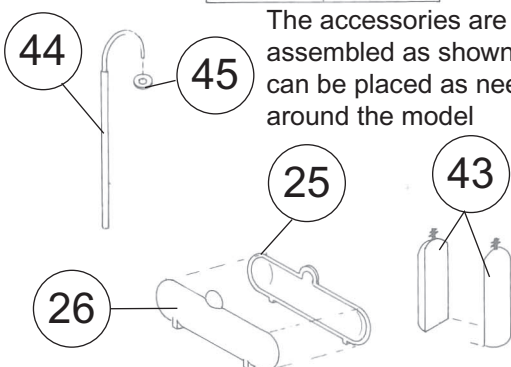

Distribution House