



HO Scale INDUSTRIAL STORAGE TANKS 933-3514

Thanks for purchasing this Cornerstone® kit. Please read these instructions and study the drawings before starting. All parts are styrene so use compatible glue and paint. We recommend assembling parts first, then painting the completed unit before final installation.

Wall-Mounted Tank

Glue Lower (W198) to Upper (W199) Tank Body half as shown. Glue Tank Ends (2x W197) to Body. Glue Braces (2x W200) to underside of Tank Body. Glue Relief Valve (W201) to left opening, and Piping (W203) to right opening in top of Body. Glue this pipe to Connecting Pipe (W204); the end fitting can be glued to any convenient point on a structure.

Small Horizontal Tank (Figure 1)

Glue Tank Body (W207) to Tank End (W208) and glue Pipe (W209) to End. Glue Relief Valve (W210) to top of Body.

Vertical Tanks (Figure 1)

Glue Large Tank Base (W195) to bottom of Large Tank (W193) and Small Tank Base (W196) to bottom of Small Tank (W194). Glue Manways (2xW197) to opening in each Tank. Glue Large Pipe (W205) to openings in top of both Tanks. Glue this pipe to Connecting Pipe (W206); the fitting at the end can be glued to any convenient point on a structure. Glue Valve Handles (2xW202) to fittings on Large Pipe as shown.

Horizontal Tank (Figure 2)

Please Note: This kit includes multiples of Tank Mid-Sections (#10), which can be combined to build a tank from 4 -7" (10 to 17.5cm) long as desired. Begin by building two end sections; the vent can be placed at the left or right as desired. Glue Upper Horizontal Tank Ends (12, 13) to Lower Tank Pedestal Sections (2x 11; one at each end). Glue Ends (2x 14; one at each end) to completed end sections. Determine the length of your finished tank and glue Tank Mid-Sections (#10) between end sections. Glue Manway (H308) to top of Upper Horizontal Tank End (12). Glue Large Vent (H306) and Small Vents (2x H309) to Manway.

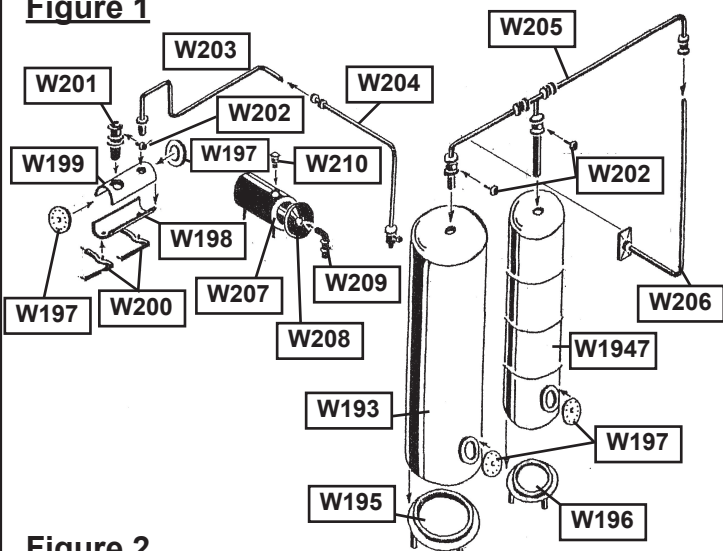
Figure 1**Figure 2**