

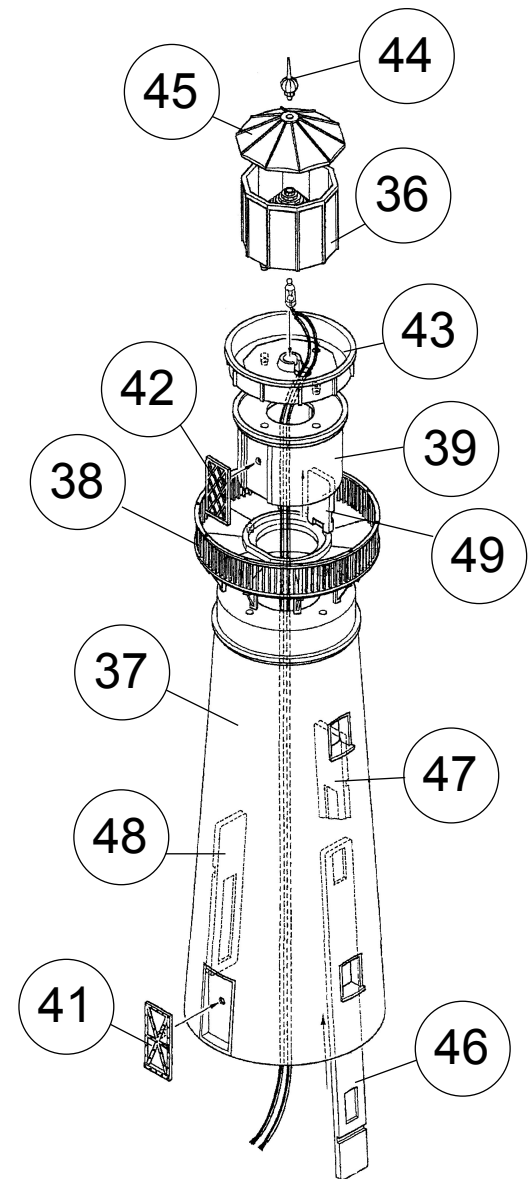

NOTE: Before connecting the lighting circuit, check that the output voltage of the ACCESSORY terminals on your power pack or other power source does not exceed 14V AC.

Carefully wrap the bare wire at the end of the brown lead around one of the ACCESSORY terminals on your power pack and tighten; repeat for the yellow wire on the other terminal. Be sure the wires do not touch each other or more than one terminal.

Note that the longer lead on the LED is the positive (anode) lead; insert the LED to the black (negative/ground) and red (positive/power) lead as shown.



**Lighthouse Tower Assembly**  
1) Note the correct placement and glue Window Glass (46, 47, 48) inside Tower (37). Insert Lower Door (41) to Tower.  
2) Insert Gallery Deck (38) to top of Tower.  
3) Insert Door (42) to Service Room (39). Insert Service Room assembly to top of Tower.  
4) Insert Lantern Room Base (43) to top of Service Room. Insert Lens (36) to top of Lantern Room Base. Insert Roof (45) to top of Lens. Insert Vent Ball (44) to opening in top of Roof.

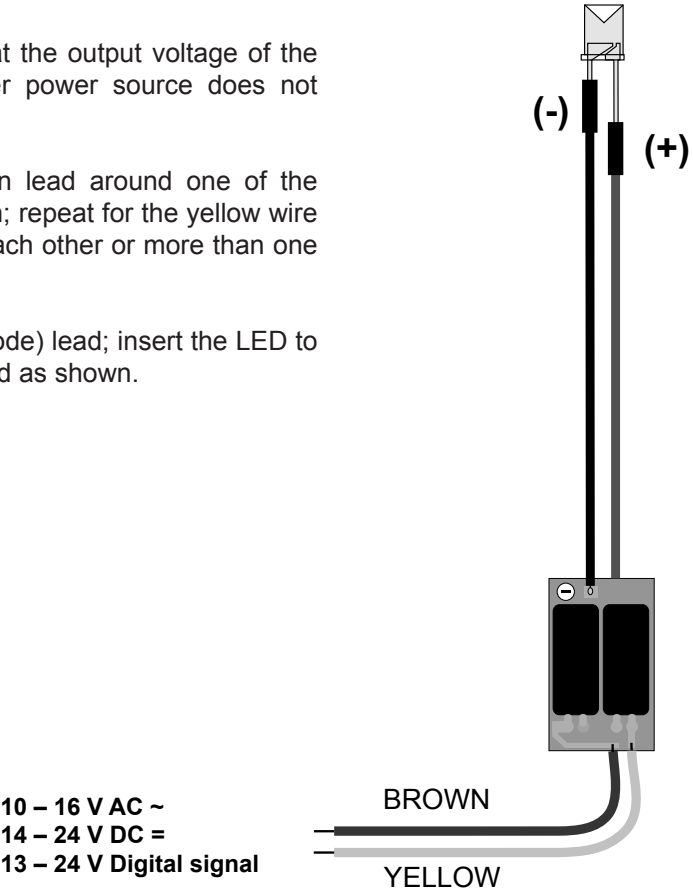

**Attaching to Base**  
1) Insert completed Tower to opening at rear of Base (1)  
  
2) Insert Front Wall (3) to Base (1). Insert Side Walls (2x 2) to Base and inside corners of Front Wall. Insert Rear Wall (4) to Base and inside corners of Side Walls.

