



HO Structure Kit CENTRAL BEVERAGE DIST 933-4042

Thanks for purchasing this Cornerstone kit. All parts are styrene plastic, so use compatible glue and paint to finish your model. Please take a few minutes to read these instructions and study the drawings before starting, as the kit can be assembled in different ways. If you wish to paint your model, you may find it easier to do so before starting construction. PLEASE NOTE: The Office area may be installed along any wall without overhead doors. The Warehouse can be built stock, or customized using the molded cut lines in each wall panel and arranging as desired. Some parts will not be used in construction of this kit; keep them for detailing future projects.

Before 1920, American breweries not only made beer, but controlled distribution and sales with an iron fist. As the number of saloons skyrocketed, and problems of excess consumption drew more public attention, conservative groups began calling for a total ban on production, consumption and sale of all alcoholic beverages. The first steps toward such a ban came in 1918, when the government stepped in to conserve much-needed grain for wartime food production. Support for an all-out ban gained momentum quickly, and by October 1919 the National Prohibition Act was passed. Ratified a few weeks later, "Prohibition" became the law of the land as the 18th amendment to the constitution and went in effect at Midnight January 17, 1920. While it prohibited the production, sale or transportation of what were loosely defined as "intoxicating liquors," it also attempted to regulate manufacturing and sales. Despite its good intentions, Prohibition opened a floodgate of criminal activity and coupled with rapidly changing social values, most people soon admitted the "noble experiment" was a colossal failure. Prohibition was officially repealed in late 1933 following ratification of the 21st amendment, which made it illegal to transport or import alcohol into any state if it violated local laws, in essence allowing states to set their own policies. New state laws were quickly passed to require licensing and collection of so-called "sin taxes" designed to increase prices and supposedly reduce demand. States also sought to level the playing field between producers and sellers, by creating the beverage distributor. Breweries, wineries and importers could no longer sell direct to retail outlets, but only to licensed distributors. They in turn were free to stock any brand or product they chose, and offer them for resale to licensed retailers. At the same time national brands began dominating the market, and distributors played an increasingly important role in transporting alcoholic beverages. With producers often several states away now, distributors relied on rail service to receive products. Distributors also provided secure storage in bonded warehouses, while the sales and support staff were housed in an attached office. Distributors also handled local deliveries, making a fleet of suitable trucks and service facilities a part of many operations. Today, the same safeguards are still in place, and the beverage distributor is a common sight in many industrial areas with easy access to both road and rail service. Modern distributors also handle a much larger number of products, on average 656 different items in 2013, thanks to the rising popularity of microbreweries, craft beers and the introduction of specialty products such as flavored beers and spirits. Your new model will be right at home in suburban industrial districts, and similar buildings have been used for various light manufacturing and warehouse operations since the 1970s. Like the prototypes, the warehouse has been designed so the wall sections can be rearranged if desired. Decals are provided for a typical beer distributor (the actual names of these firms tend to be very generic so as not to show preference for a particular brand), as well as various types of delivery trucks. See your local hobby dealer, check out the current Walther's Model Railroad Reference Book or visit us online at walthers.com for additional figures, scenery materials, railcars and other details to complete your new industry.

OFFICE

Please Note: the completed Office will be installed against the Warehouse Front Wall (102) in a later step.

1) Begin construction by gluing Windows and Doors to Walls as shown:

Front Office Wall (26): Office Entry Door (29) & Glass (28), Windows (4x 30) & Glass (4x 31).

Left Office Wall (25): Entry Door (32), Windows (3x 30) and Glass (3x 31).

Right Office Wall (27): Entry Door (32), Windows (3x 30) and Glass (3x 31).

2) Using raised ridges on Base (24) as a guide, glue completed Walls to Base and to each other.

3) If desired, add the Printed Office Interior; this can be secured with white glue or double-sided tape for adjustments.

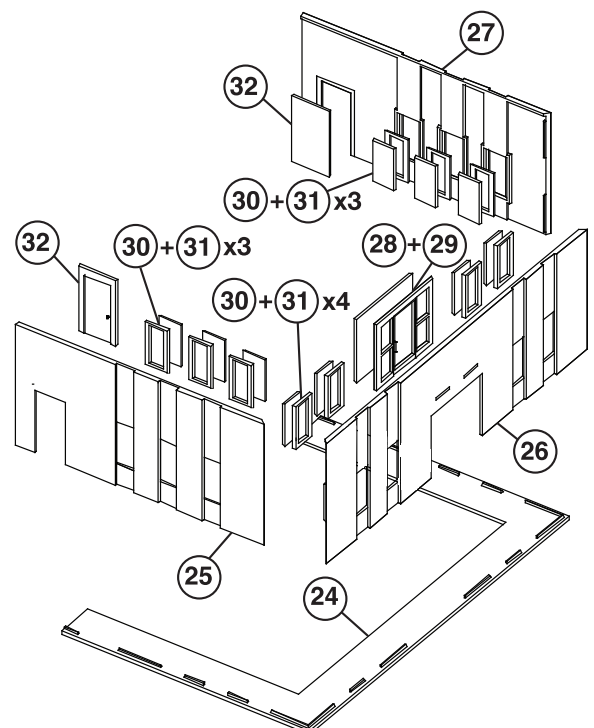

4) Be sure the flat edge of Office Roof (34) faces the rear: Roof can be set in place if you wish to add interior lighting or interior details (sold separately) or glued in place. Glue Office Roof Vent (78) to Roof. Glue Office Canopy (33) to openings in Front Wall as shown.

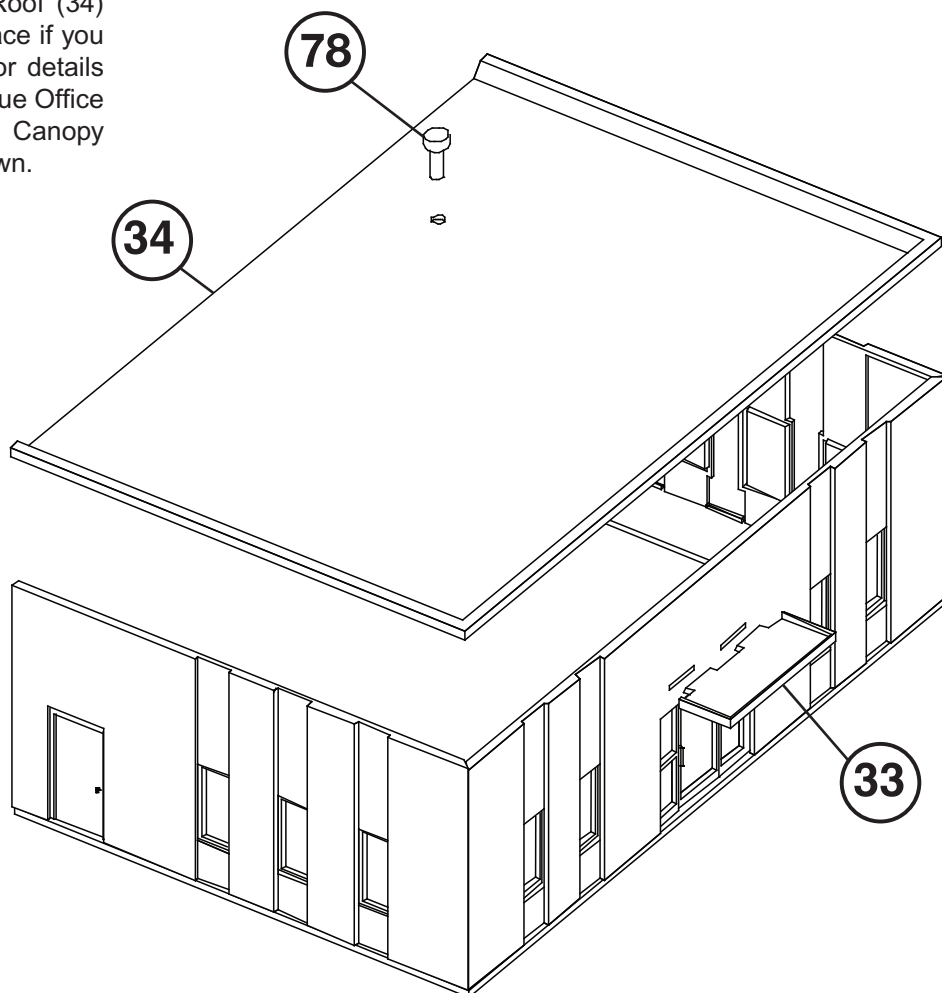

REFRIGERATION/AIR CONDITIONING UNITS

Parts are included to construct seven different types of air condition/roof-mounted refrigeration units. Larger units can be installed as desired on the Warehouse Roof (23), and smaller units on the Office Roof (34). All units consist of six parts: Front Panel, Rear Panel, Left and Right Sides, Base and Top Panel, which are assembled as shown.

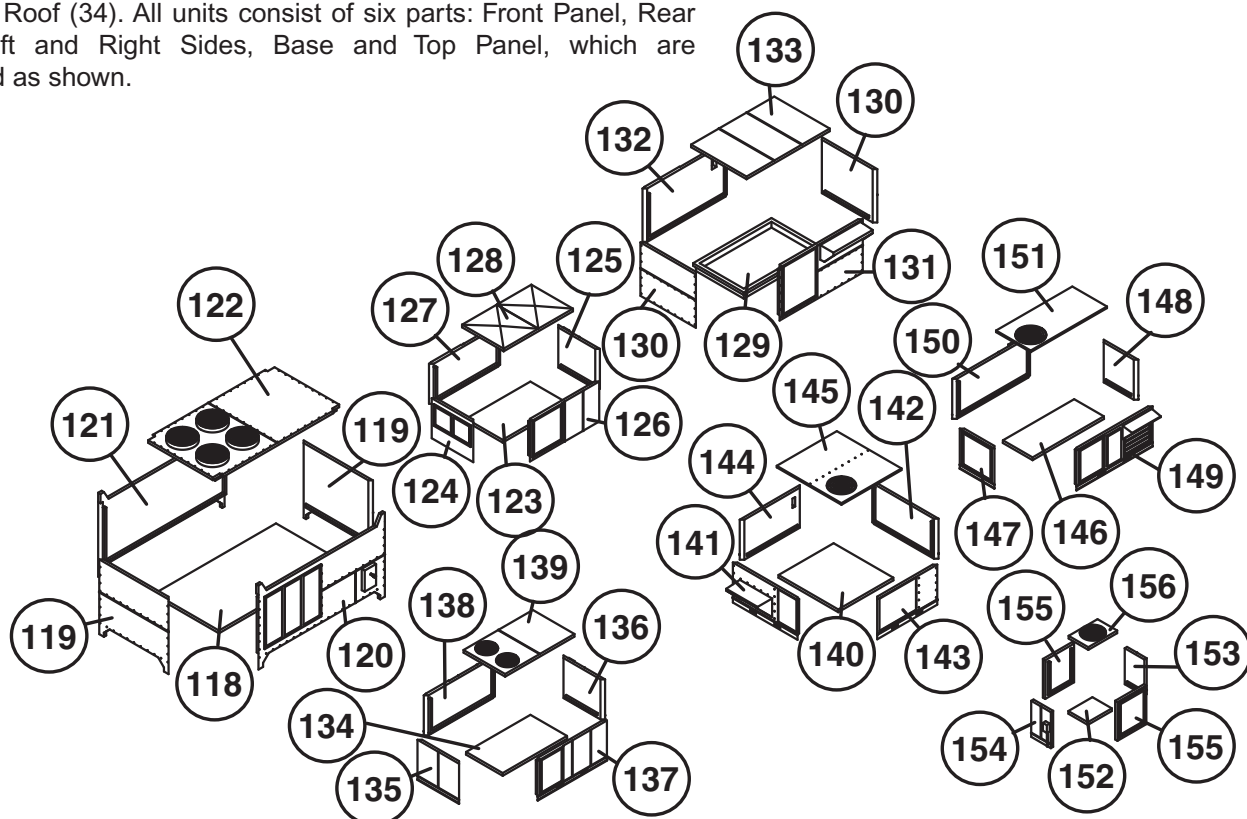

WAREHOUSE

Please Note: Warehouse Walls (101, 103, 104) have molded cut lines on the back so you can easily reposition the truck and railcar docks if desired. With additional modifications to the Roof and Base, you can build a smaller structure if desired. Hold the walls carefully! Keeping your hands clear and cutting away from your self, use a sharp knife and make several light passes down the cut lines to separate the wall sections.

1) Begin construction by gluing Windows and Doors to Walls as shown:

Rail Dock Wall (101): Roll-Up Doors (2x 17) and Glass (4x 17)

Truck Dock Wall (103) Roll-Up Truck Doors (4x 16) and Glass (4x 18), Entry Door (19).

Rear Warehouse Wall (104): Entry Door (19)

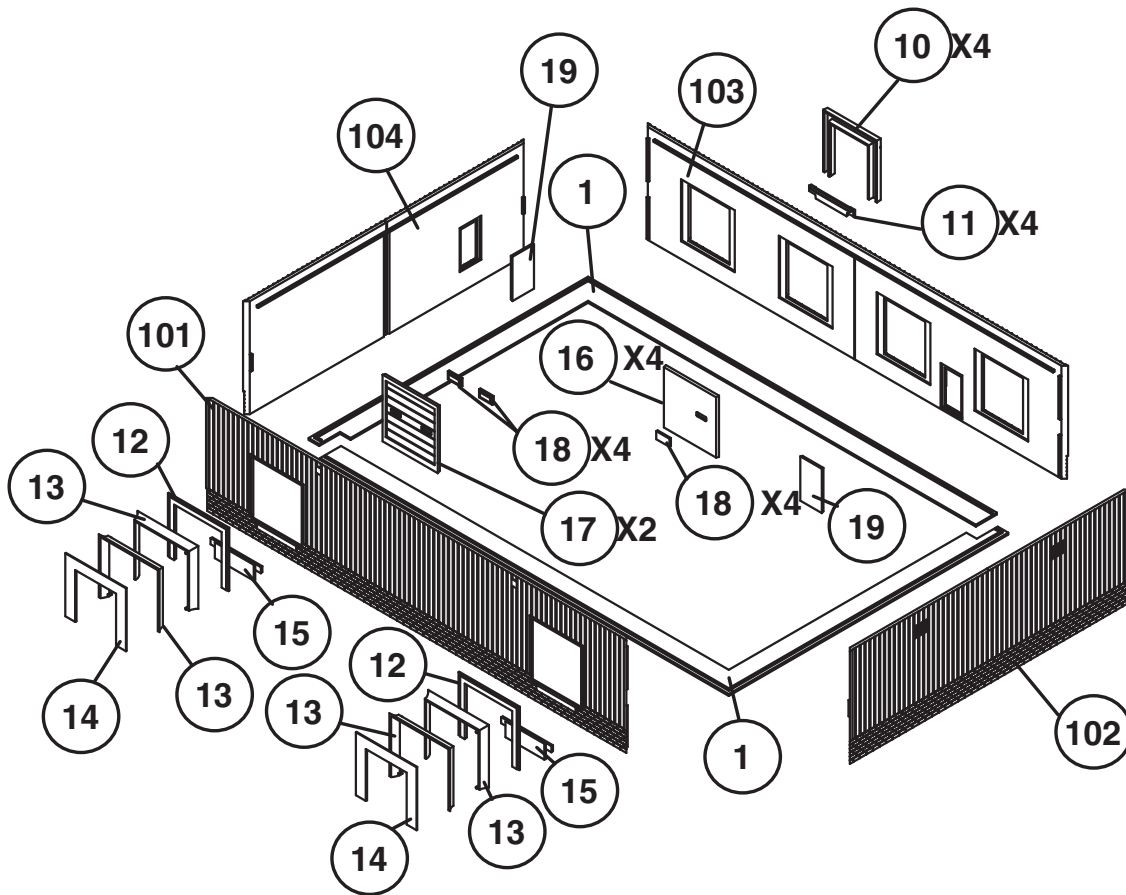

2) Using raised ridges on Base (1) as a guide, glue completed Walls to Base and to each other.

3) Construct two Railcar Dock Seals as follows: Glue Bellows (2x 13) together as shown. Glue Door Frame (15) to inside edge of Bellows and Striker Plate (14) to outside edge. Glue completed seals to Rail Dock Wall (103). Glue Dock Ramp Plate (2x 15) to Dock Wall below each door as shown.

4) Glue Truck Loading Dock Seals (4x 10) to Truck Dock Wall (103). Glue Truck Dock Bumpers (4x 11) to Dock Wall below each door as shown.

5) Glue Warehouse Roof (23) to completed Walls. Glue Corner Wall Caps (4x 21) and Wall Caps (6x 20) as shown. Glue Angled Exhaust/Intake Halves (116, 117) together. Glue Motorized Vent Base (112) to Motorized Vent (113). Glue refrigeration units, air conditioners, completed vents and "T" Style Exhaust Stacks (114, 115) to Roof as desired.

6) Glue a Scupper & Downspout (4x 108) to openings in sidewalls as shown. Three different styles of nonworking Security Lights (109, 110, and 111) are included that can be installed wherever you wish. Drill a #60 mounting hole (bit sold separately) in the appropriate location, and glue lamps in place.

7) Glue Completed Office to Front (plain) Walls of Warehouse.

8) Glue Side Handrail (107) and End Handrail (106) to Stairs (105). Glue Completed Stair way below Entry Door on Rear Warehouse Wall.

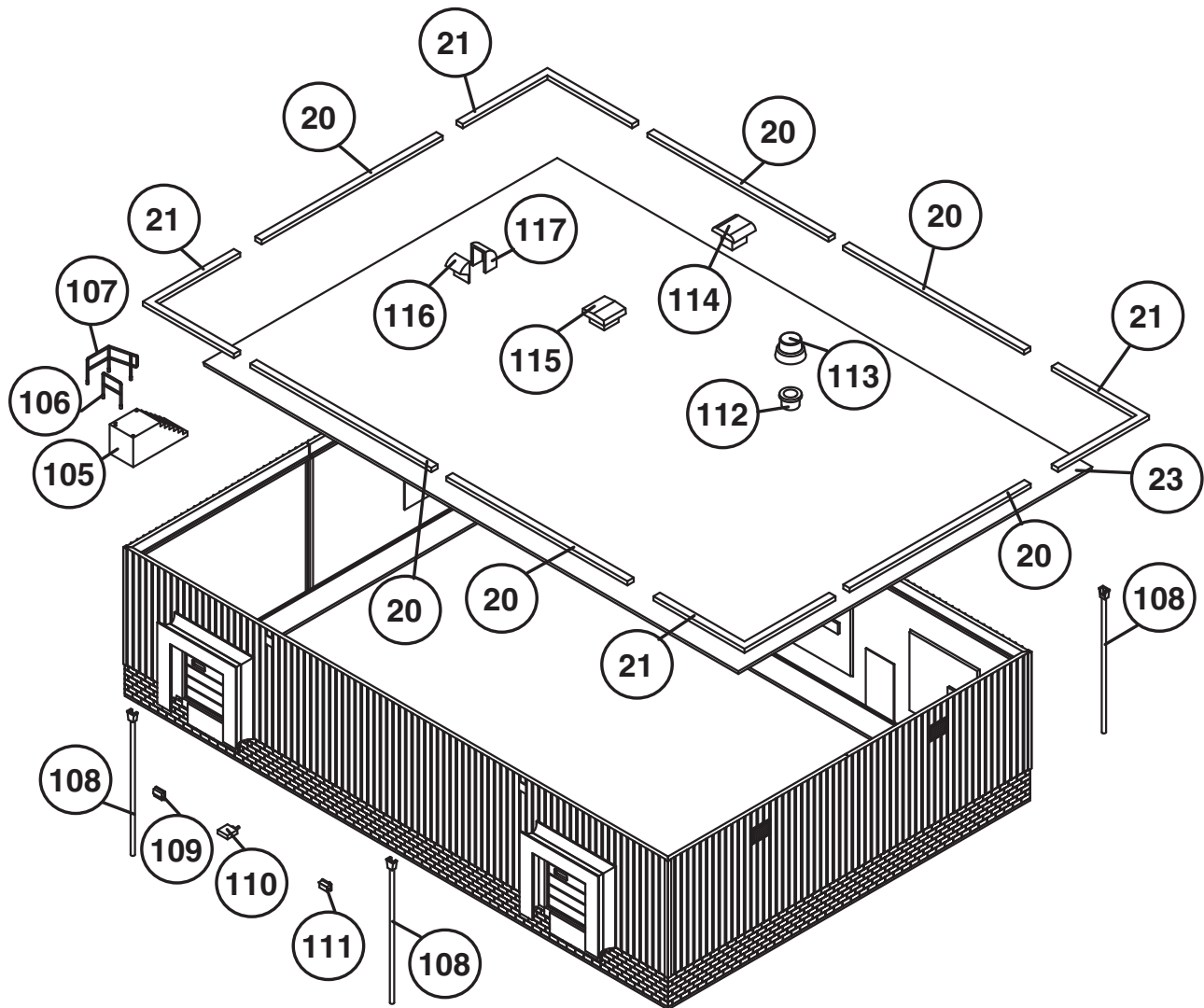

Applying Decals

1. Cut out the decal and dip in water for 10 seconds. Remove decal from water and let stand for 1 minute. Slide decal onto surface and into position. Blot off any excess water.
2. Lightly brush Micro Sol® on top of the decal. This will soften the decal allowing it to conform to any irregular surfaces. DO NOT TOUCH DECAL while wet!
3. When the decal is thoroughly dry, check for any trapped air bubbles. Prick them with the point of a small pin or hobby knife blade and apply more Micro Sol®.