



HO Scale Structure Kit

SIMMONS' FIVE AND DIME

933-3464

Thanks for purchasing this Cornerstone Series® kit. Please read all instructions and study the drawings before starting — directions for the interior graphics are printed directly on that sheet. All parts are styrene plastic, so use compatible glue. If you wish to decorate your model, use paints for plastic models. With appropriate details and signs, your finished model fits almost any era.

For generations of Americans, the local five-and-ten-cent store was the best shopping bargain in town. With a style and selection all their own and nothing that cost more than 10 cents, “dime stores” were found in big cities and small towns from coast to coast. For kids, they were the best place to be on a Saturday afternoon, checking out the penny candy, pets, toys, model kits and hundreds of other items. For anyone on a limited budget, they offered affordable household items and sundries to stretch every dollar as far as possible. Many eventually added lunch counters or soda fountains, and stopping there for a treat added to the fun. Rising prices and increasing competition from malls and mega-mart discount stores have made most a thing of the past, but a few are still in operation.

For more Cornerstone Series® kits as well as additional details to complete your scene, see your hobby shop, check out the latest Walther's HO Model Railroad Reference Book and our Website at walthers.com.

1. Glue Window Glass (12, 10) to Door Frames (11, 9). Glue Block Window Glass (13) to Back Wall. Glue Door Assemblies (11, 9) to Back Wall.
2. Glue the Front Wall Window Frame (16) to Front Wall (15). Glue Left Entry Window (19) Door Frame (20) Right Entry Window (18) and Entry Roof (22) together. Glue to Front Window/Front Wall Assembly (15, 16)
3. Glue Front Window Glass (17) in place to the Front Window Frame Assembly (16, 18, 19, 20, 22).

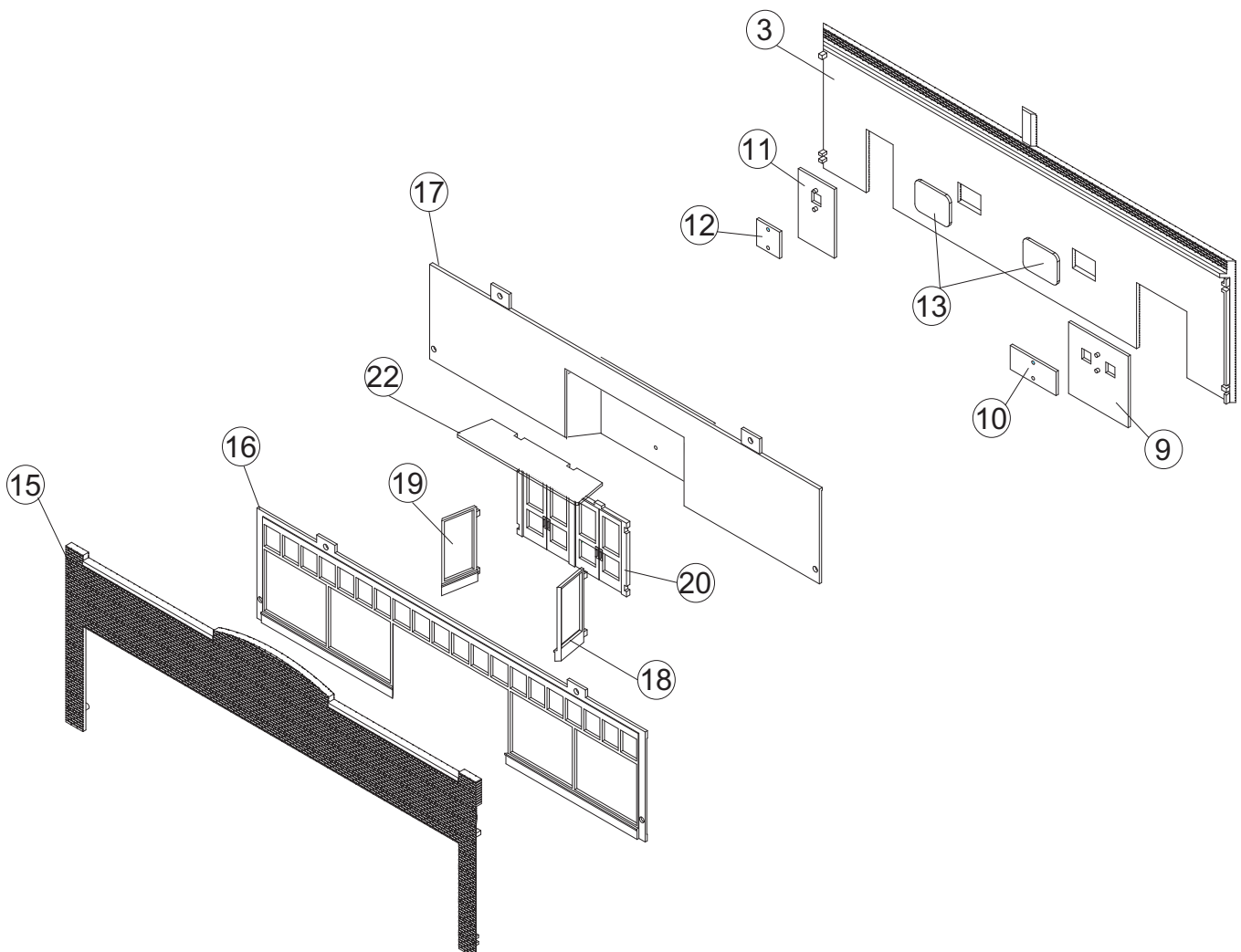

4. Glue the 4 Wall Assemblies (15, 2, 3, 4) to the Roof (14).
5. Glue three Chimney Sides (5, 6, 7) together. Then glue Chimney Assembly to Back Wall (3) to complete the four sides of the Chimney.
6. Glue the Chimney Cap (8) to top of Chimney Assembly.
7. The finished structure can be set on the Base (1) if you wish to add interior details at a later time or, glued in place to complete construction.

