



HO Structure Kit
VINTAGE DAIRY QUEEN® STORE
933-3484

Thanks for purchasing this Cornerstone® kit. All parts are made of styrene, so use compatible glue and paint to assemble and finish your model. Please take a few minutes to read the instructions and study the drawings before starting. Early structures were painted solid white, but some later had aluminum window frames and blue roof eaves. After 1961 new logos and corporate colors were adopted, and many stores were touched-up with bright red trim and/or lower wall panels.

From a first date to a first job, celebrating a softball win, or just being with friends and family, the local Dairy Queen® Store has been a key part of America's summers for almost eight decades. The story really began in 1938 when Illinois dairy operators John "Grandpa" and Alex McCullough, along with ice cream parlor owner Sherwood Noble, successfully taste-tested a new product they called "soft ice cream." Largely a summer treat, ice cream had to be frozen rock hard to survive the trip from the factory to local ice cream parlors and soda fountains. By 1940, they had perfected the special freezer and the formula to make a smooth, creamy and tasty treat they named "Dairy Queen Soft Serve."

The world's first Dairy Queen® Store opened in Joliet, Illinois, in the summer of 1940. The following April, the McCulloughs opened a second store on a busy route in Moline, Illinois. Compact and convenient, the stand-alone walk-up became the standard for new Dairy Queen® stores for the next 20 years. Painted solid white and topped by a colorful sign, the big plate glass windows let in plenty of light by day and gleamed brightly after dark.

Open only during warmer weather (northern drive-ins closed in fall and winter), no inside seating was provided. Customers simply pulled in and parked, waited in the shade of the extended front roof, ordered at one of two walk-up windows then returned to the car to enjoy their cone or sundae.

With demand for ice cream skyrocketing after WWII, so did the number of Dairy Queen® Stores. Unlike many drive-in chains, the Dairy Queen® Brands stayed true to its roots, with the majority of its stores in small towns, many of which were rapidly growing into suburbs of bigger nearby communities. By the late 1960s as once busy highways were downgraded to business routes or bypassed altogether, some owners opted to build new Dairy Queen® Stores closer to freeways and adjacent commercial areas. But many were such an integral part of their local neighborhood and community that closing, let alone moving was simply out of the question.

Today, a fair number of these 1950s-vintage buildings sport modern DQ® logos and color schemes, where the third- or fourth-generation of the founding family still serve the same great treats. Perfect for detailing vintage or modern highways, see your dealer, check out the current Walthers HO Model Railroad Reference Book, or visit us online at walthers.com for figures, vehicles and more to bring your new model to life.

"DQ®, Dairy Queen®, and the ellipse shaped logo, are trademarks owned or licensed by American Dairy Queen Corp. Manufactured under license from American Dairy Queen Corp."

WALLS & WINDOWS

1) To avoid damage to the "glass," you may wish to glue all clear parts in place with a water-based adhesive, sold separately.

2) Small locator ribs are molded on the inside of each wall to help align "glass." With the walls lying flat, set each window in the mounting area, apply a tiny bit of glue at the edges where the "glass" meets the wall and allow to dry.

Front Wall (2): NOTE: Angled edges on Front Window (8) must face inward.

Back Wall (21): Small Window (10).

PLEASE NOTE: Be sure both Large Side Windows (9) are aligned correctly with the angled edge at the front facing inward.

Right Side Wall (3): Large Side Window (9).

Left Side Wall (5): Large Side Window (9), Small Windows (2x 10).

MAIN STRUCTURE

4) Note the raised ridges on the floor of Base (1). With the open side facing the back, glue Preparation Counter (15) to center, and Freezers (2x 16) at left and right as shown.

5) Note the small pins and receivers on the inside corners of the Front (2) and Side Walls (3, 5). Carefully align each Wall, and glue to raised ridges on Base and inside corners where walls meet. Glue Back Wall (21) to Base and inside rear corners of both Side Walls. Glue Interior Wall (12) ahead of raised ridges on Side Walls and Floor as shown. With braces on the underside, glue Front Walk-Up Counters (2x7) to openings in Front Wall.

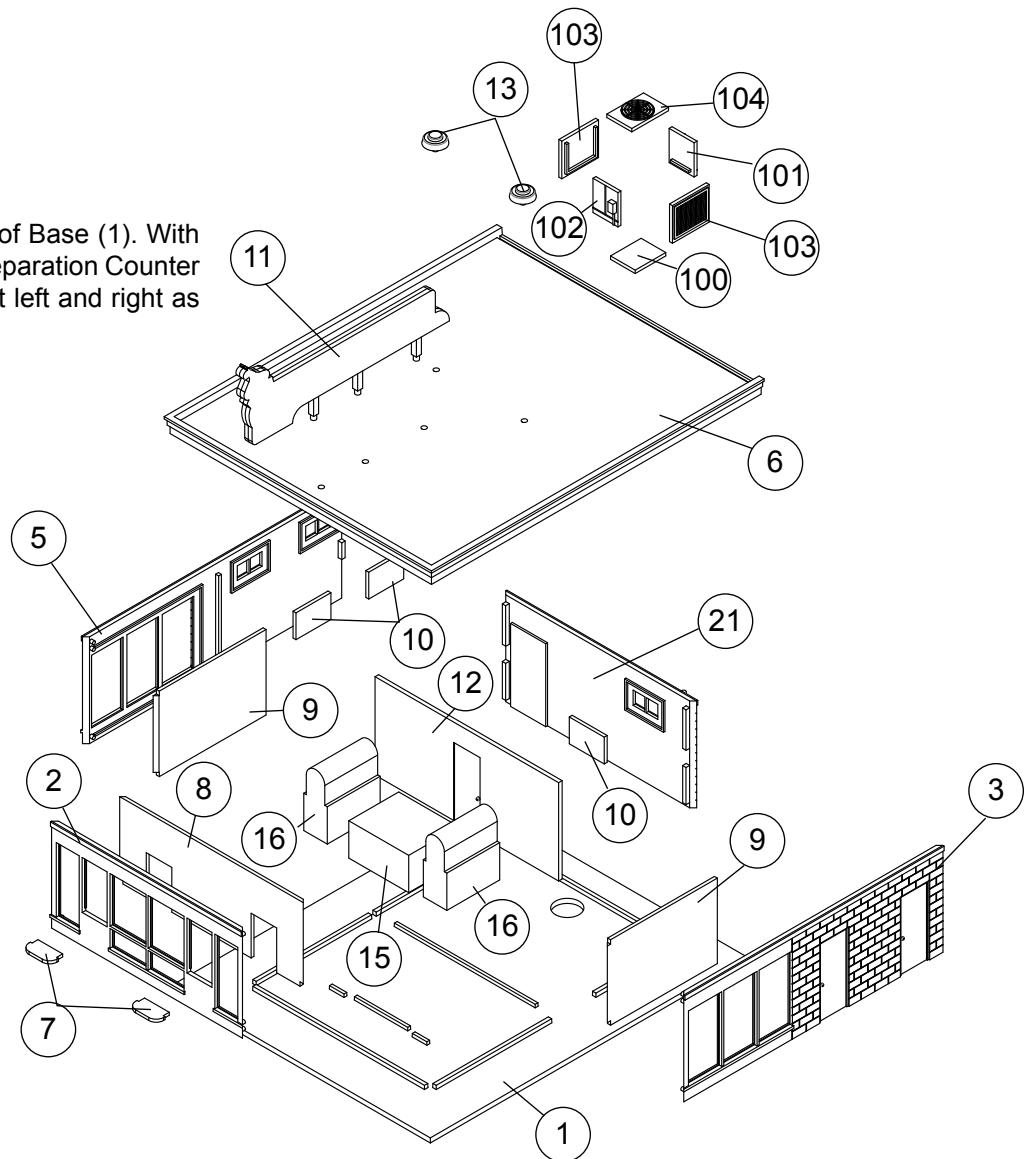

ROOF:

6) Glue Sign (11) to three front mounting points on Roof (6) as shown.

7) Glue Vents (2x 13) to Roof mounting points.

8) Note the raised ridges on the inside of the Front (102) and Rear (101) Air Conditioning Unit Walls are the bottom. Glue the Front and Rear Walls to the Air Conditioning Unit Base (100). Glue the Sides (2x 103) to the Base and inside corners where walls meet. Glue the Fan (104) to the top of the completed assembly. The finished Air Conditioning Unit can be glued anywhere along the rear of the Roof.

8) The Roof can be set in place to add lights (use the opening in the base to clear feeder wires) as well as figures or additional-details (all sold separately), or glued in position as desired.