



HO Structure Kit  
**WAYNE BROS. FORD**  
933-3483

Thanks for purchasing this Cornerstone® kit. Please read the instructions and study the drawings before starting. All plastic parts are styrene, so use compatible glue and paint to finish your model.

Drive down a busy street and you'll pass many auto dealerships, but buying a new car wasn't always so easy. In the earliest days authorized sales agents special-ordered every car direct from the builder. These operations gradually began resembling modern dealerships, selling gasoline and parts, and offering repair work. America's first true auto dealership opened in 1898, and within a few years, banks were offering loans and installment plans that made car ownership possible for more and more people. To keep sales rolling, automakers introduced annual styling changes creating a market for used cars as well. By the 1920s, the central business district of towns big and small could boast of an auto dealership, where the sales floor served as lavish showcase, complete with bright interior lighting, colorful signs and enormous display windows. Demand for new cars exploded in the late 1940s, fueled in part by folks moving to suburbs. Now that dad was driving to work and mom was miles from the nearest store, many families needed a second car. Realizing that much of their business was coming from these areas, many dealerships left their cramped downtown quarters for roomier lots and new facilities with both inside and outside sales areas, as well as a service garage. Many would remain in operation for years to come, receiving an occasional facelift or new signs, and others were replaced by newer facilities in better locations, with the existing operation converted to a used car or import sales facility. Typical of dealerships from the 1950s to the present, your new model will look great along any busy street.

For additional details and accessories to add the finishing touch to your model, visit your local hobby shop, see the current HO Model Railroad Reference Book or visit us online at [walthers.com](http://walthers.com).

## GARAGE

1) Glue Doorframes (2x 39) into Walls (13,15). Overhead Doors (2x 40) can be left off or glued in place. If used, glue Overhead Door Glass (2x 41) to back of Overhead Doors.

2) Glue Entry Door (42) to Wall (15). Glue Door Glass (43) to back. Glue Double Entry Door (44) to Wall (16).

3) NOTE: Align doorways on walls with open areas as on Garage Base (1). Using raised ridges on Base as a guide, glue walls (13, 14, 15, 16) to outside edge of raised ridges, and at all inside corners.

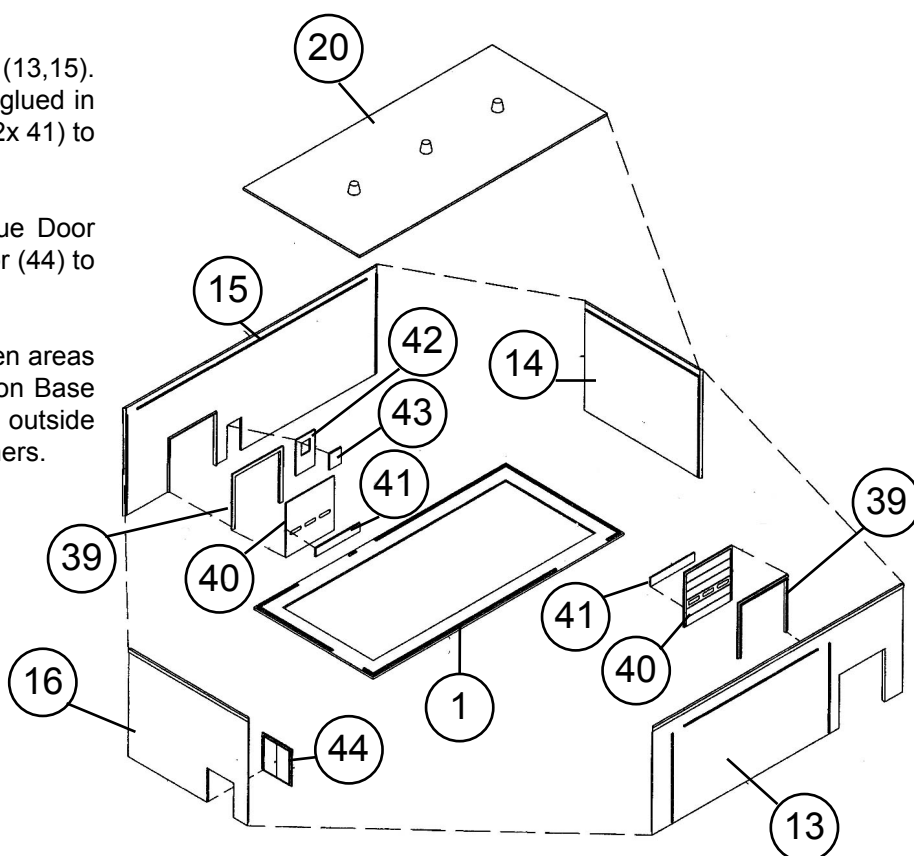

## GARAGE (CON'T)

4) Assemble three security lights as follows: glue Light Bracket (3x 47) to Light Housing (3x 45), and glue Lens (3x 46) to Housing. When dry, insert into wall mounting points as shown and glue from inside.

5) Glue Vents (53, 54) to Garage Roof (20). Roof may be set in place to access the interior or glued down.

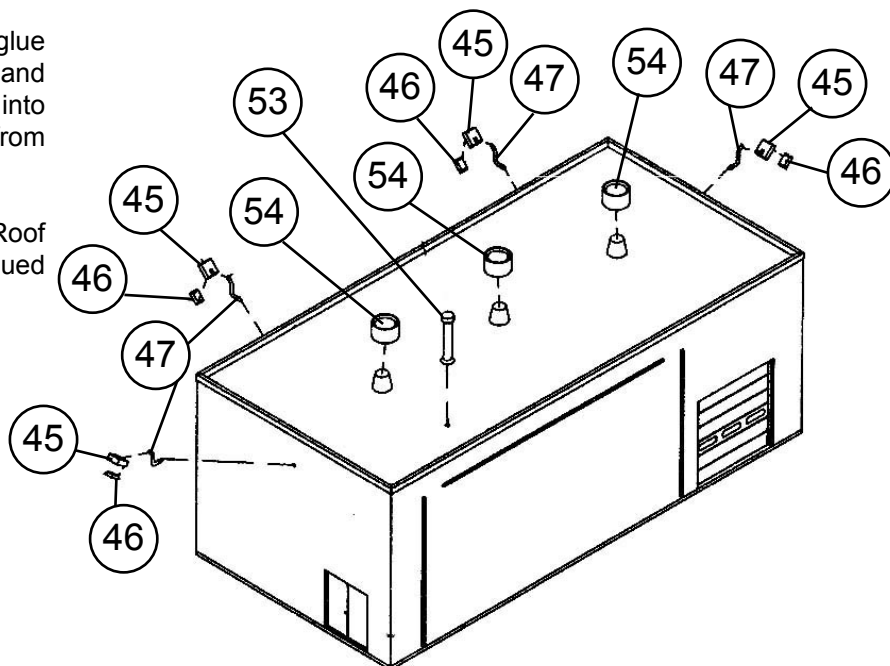

## SHOWROOM, OFFICE & SERVICE BAY

- 6) Glue Office Windows (8x 37) to Office Walls (3, 4, 12, 18). Glue Office Window Glass (8x 38) to back of Windows.
- 7) Glue Doorframes (2x 39) into Walls (12,17). Overhead Doors (2x 40) can be left off or glued in place. If used, glue Overhead Door Glass (2x 41) to back of Overhead Doors.
- 8) Glue Entry Door (42) to Wall (12). Glue Door Glass (43) to back.
- 9) NOTE: Align doorways on walls with open areas on Showroom Base (2). Using raised ridges at center of Base as a guide, glue walls (3, 4, 15, 18) to outside edge of raised ridges, and at all inside corners as shown.

10) Glue Service Bay Walls (17, 12) to outside edge of raised ridges at rear of Base, and inside corners against Office Wall as shown.

11) Glue Front Showroom Window (31) to bottom of Front Showroom Wall (9). Glue Trim (2x 7) to lower edges of Window as shown. Use pins to align Glass (32) with back of Window and carefully glue in place.

12) Glue Left Showroom Window (29) to back of Left Showroom Wall (6). Use pins to align Glass (30) with back of Window and carefully glue in place.

13) Glue Right Showroom Window (33) to back of Right Showroom Wall (10). Use pins to align Glass (34) with back of Window and carefully glue in place.

14) NOTE: Align doorway on Front Wall with open area on Showroom Base (2). Using raised ridges at front of Base as a guide, glue completed Walls to outside edge of raised ridges, and at all inside corners as shown.

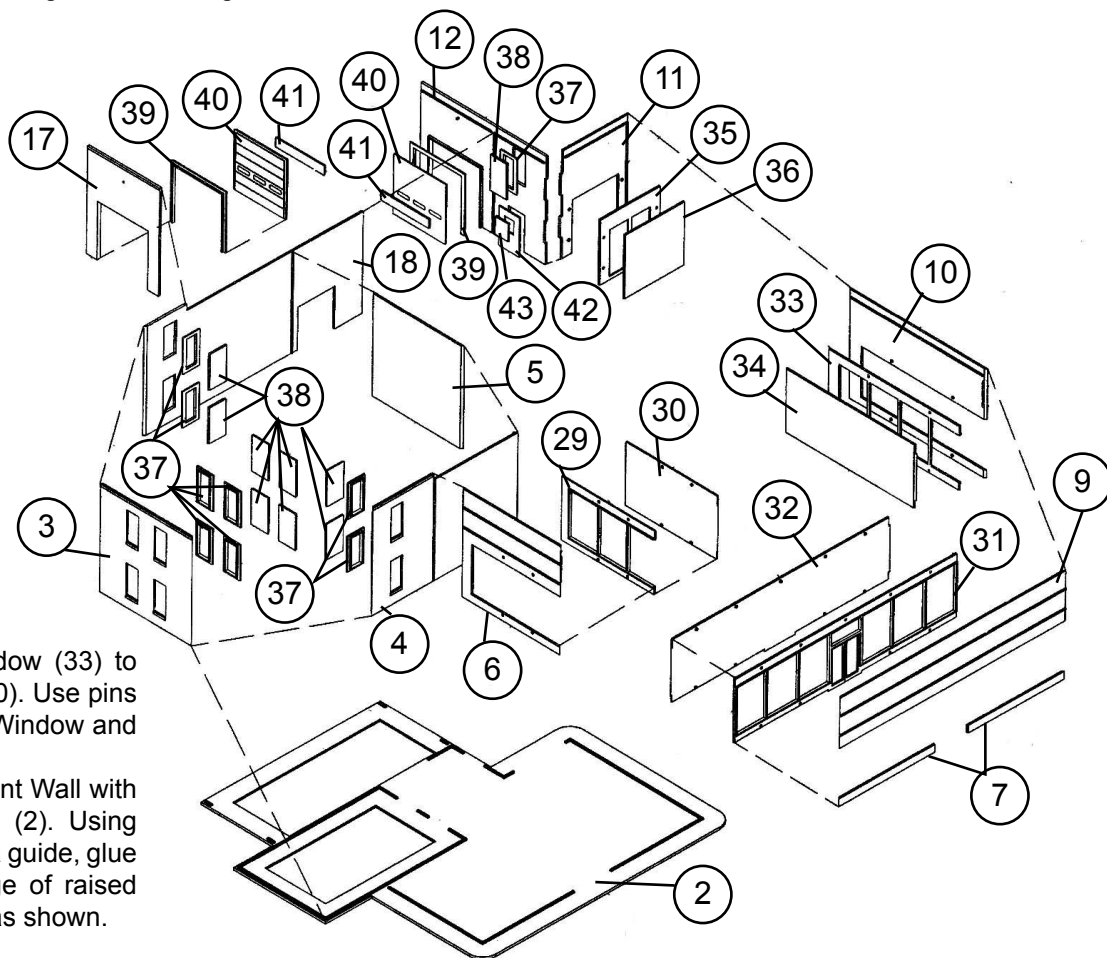

## SHOWROOM, OFFICE & SERVICE BAY (Con't)

15. NOTE: Begin assembly of the trim on Left Wall #6. Glue Left Overhang (21) above the upper ridge on the wall and in the blank area on Wall #4. Glue Left Overhang Bottom (22) against the lower ridge on the wall and inside the Left Overhang.

16) Align Front Overhang (23) with Left Overhang, and glue to Front Wall (9). Glue Front Overhang Bottom (24) against the lower ridge on the wall and inside the Front Overhang.

17. Align Right Overhang (25) with Front Overhang, and glue to Right Wall (10). Glue Right Overhang Bottom (26) against the lower ridge on the wall and inside the Right Overhang.

18) Align curved end of Rear Overhang (27) with Right Overhang as shown, and glue above the upper ridge and in the blank area on Wall #11. Glue Rear Overhang Bottom (28) against the lower ridge on the wall and inside the Rear Overhang.

19) Glue Roof Vents 53, 54 to Roof (19). Completed Roof may be set in place to add interior details or lighting (sold separately) or glued in place.

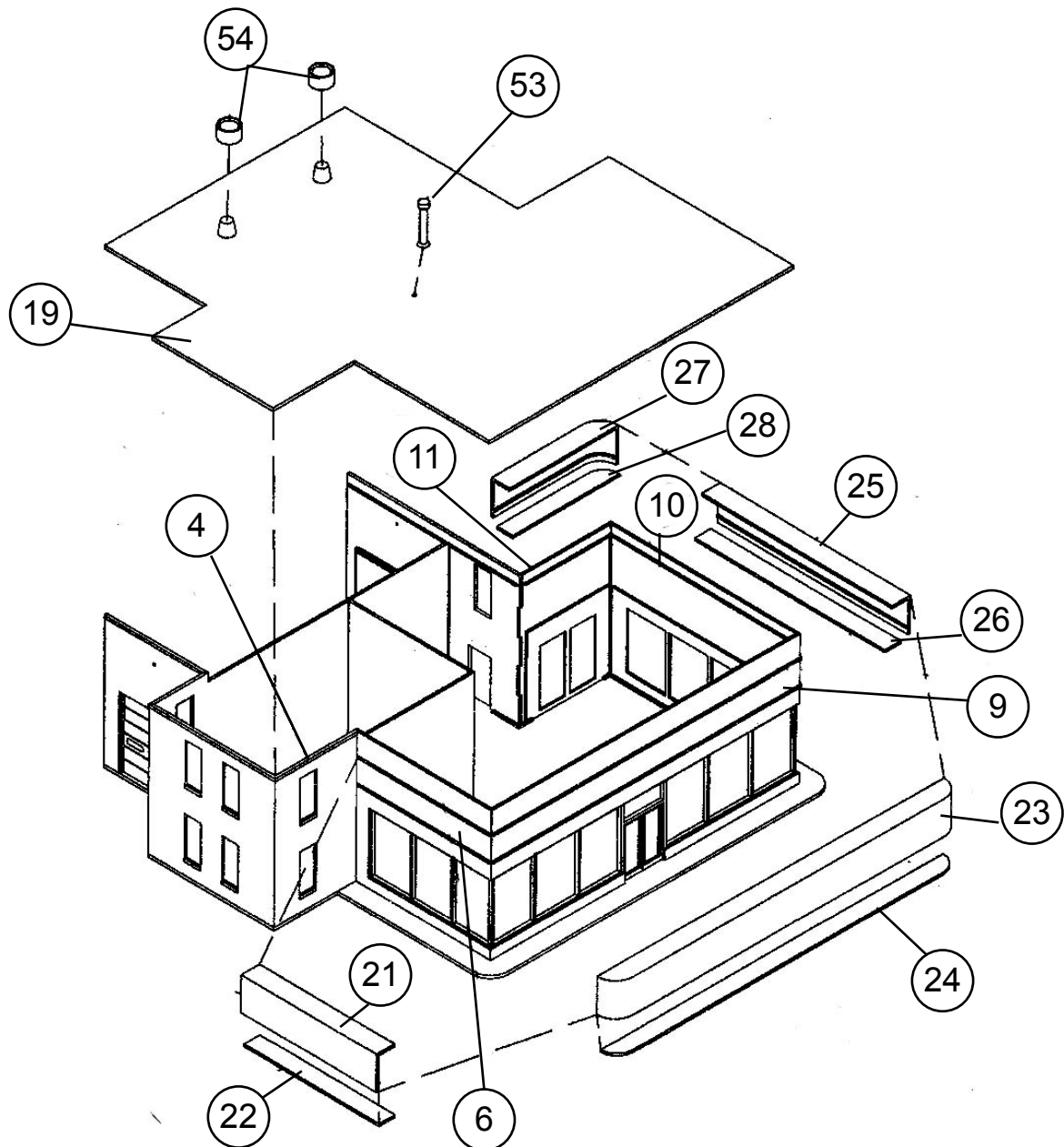

## DECALING

1. After cutting out the decal, dip in water for 10 seconds, remove and let stand for 1 minute. Slide decal onto surface, position and then blot off any excess water.
2. Lightly brush Micro Sol® on top. This will soften the decal allowing it to conform to irregular surfaces. DO NOT TOUCH DECAL while wet!
3. When the decal is thoroughly dry, check for any trapped air bubbles. Prick them with the point of a small pin or hobby knife blade and apply more Micro Sol®.

20) Align the Service Bay Walls (12, 17) with the raised ridges on Garage Wall (13); glue Walls and Bases (1, 2) together.

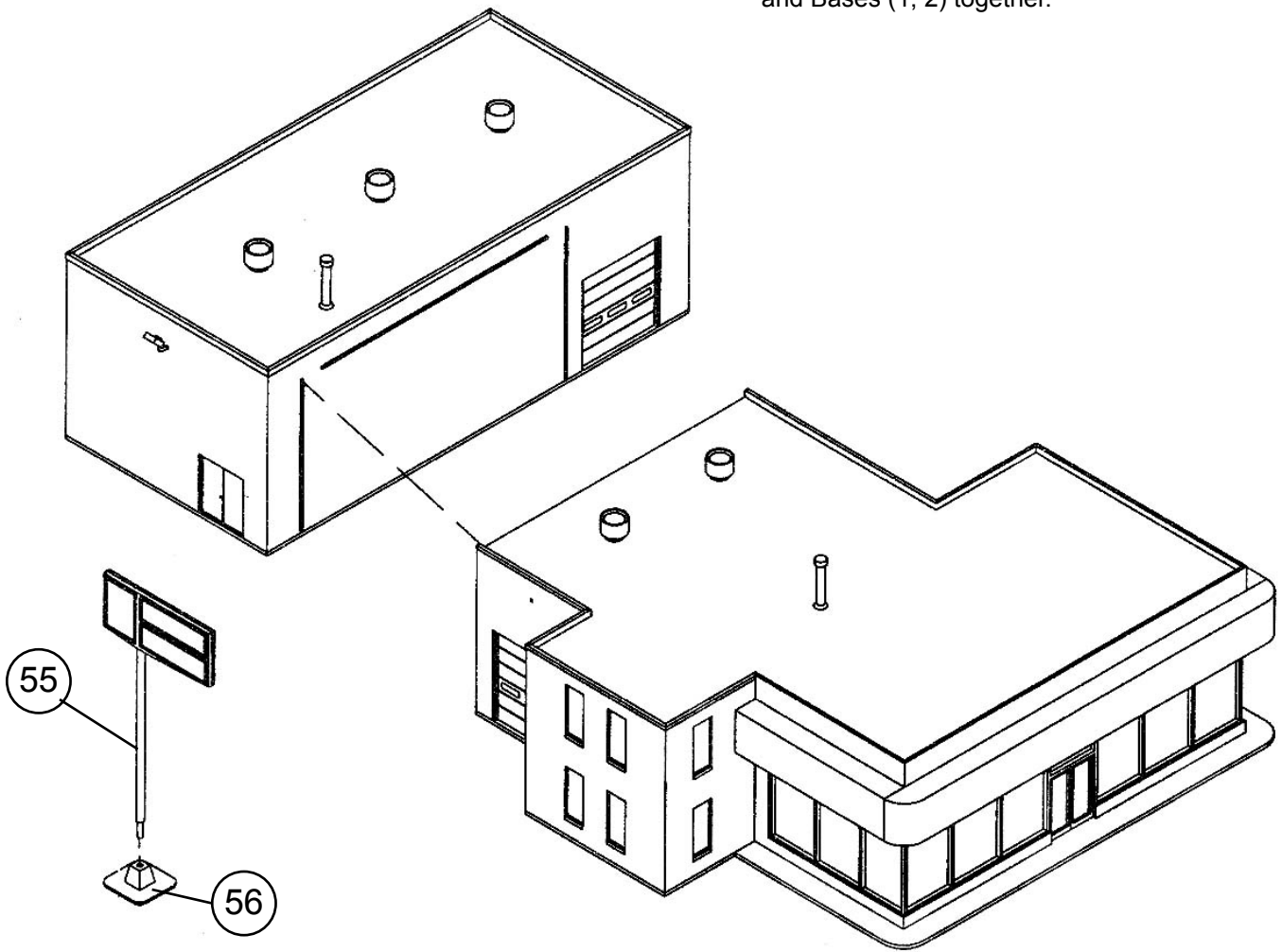

## SIGNS

21) Parts for Older- and Modern-style signs are provided. Glue Older Sign (55) to Base (56), or glue Modern Sign Halves (60, 61) together and to Modern Base (62). The Modern Wall Sign (63) has small mounting pins at one end. Drill two #60 (1mm) holes in any wall and glue in place.

Refer to instructions for applying graphics.

