

2) Glue Walls (2, 3, 4, 5, 6 & 7) to Base (1). Roofs (14, 15) may be set in place or glued to completed wall assembly. Glue Downspouts (13, 38) to locating holes in Rear Wall (4). Glue Chimney (8, 9, 10, 11 & 12) together then to raised rib on Roof (15). Glue Vent (39) to mounting hole in Roof (14). Air Pump (40) may be glued to any wall.

DETAIL ASSEMBLY

WINNER CIRCLE SIGN: Glue Base (42) to bottom of Sign (41).

SIGNS: Select the style you wish to use and glue Base (37) to bottom of Sign (34, 35)

GAS PUMPS: Select the style you wish to use. Glue Pump Front & Rear (29 A/B, 30 A/B or 31 A/B) together, and to Island (28)

SANDWICH BOARD: Glue Supports (33) to lower sides of Small Sign (32).

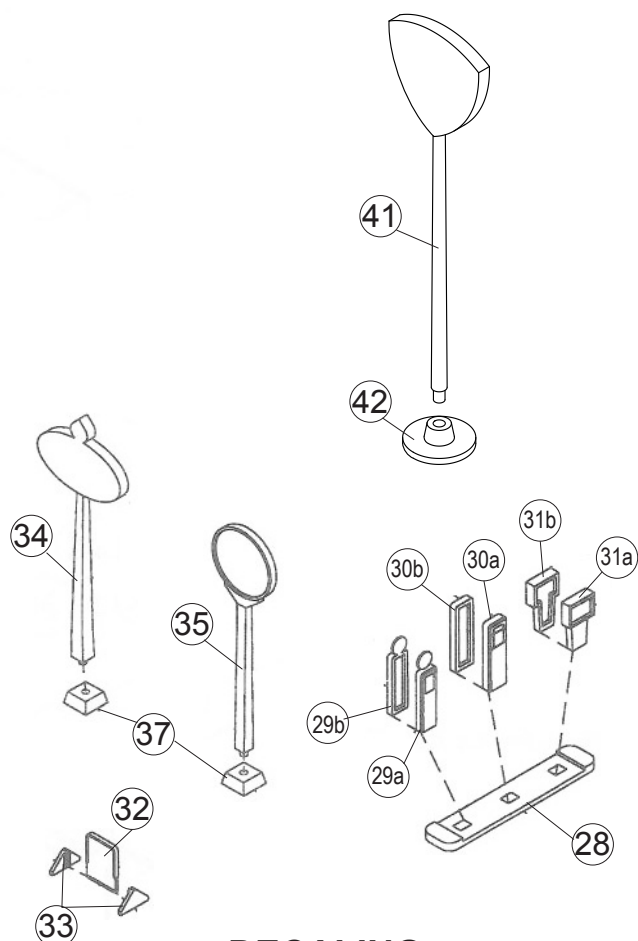

DECALING

1. After cutting out the decal, dip in water for 10 seconds, remove and let stand for 1 minute. Slide decal onto surface, position and then blot off any excess water.
2. Lightly brush Micro Sol® on top. This will soften the decal allowing it to conform to irregular surfaces. DO NOT TOUCH DECAL while wet!
3. When the decal is thoroughly dry, check for any trapped air bubbles. Prick them with the point of a small pin or hobby knife blade and apply more Micro Sol®.