



N Structure Kit

STATE LINE FARM SUPPLY

933-3808

Thanks for purchasing this Cornerstone kit. Please read these instructions and study the drawings before starting. All parts are styrene, so use compatible glue and paint to assemble your model. NOTE: Two different rear walls are included, and the large windows and doors for the front wall are interchangeable so they can be installed as desired.

America's industrial revolution and westward migration brought sweeping changes to farming methods and technology by the 1860s. Manufacturing companies were turning out a wider range of products and the growing network of railroads made it possible to ship machines over longer distances than ever before. General stores, hardware stores and similar businesses eagerly handled sales of new machinery as well as repair parts.

But as horsepower took over early in the 20th century, bigger and even more complex machines appeared. Borrowing a page from the new automobile dealerships, many older sales agencies made the switch to full-time implement dealers. New facilities patterned after, but larger than auto showrooms were built. These provided display areas and offices for sales in the front, a parts department and garage space in the rear to handle repairs. Many dealerships used the same building for decades, but the small facilities were seldom able to handle larger and more sophisticated machines that arrived in later years. And as once rural areas grew into suburbs, the structures often found new uses as body shops or used car lots and many still serve in those roles today.

Typical of implement dealerships still found all over North America, your new State Line Farm Supply fits an era from the 1920s on with numerous overhead doors and an elaborate front wall making the building more attractive along a busy street or highway. Many dealerships also had a loading ramp to receive new equipment by rail or road, and parts are included to model this important detail. For more ideas to detail your scene, see your dealer, visit walthers.com or see the latest Walthers N&Z Scale Model Railroad Reference Book.

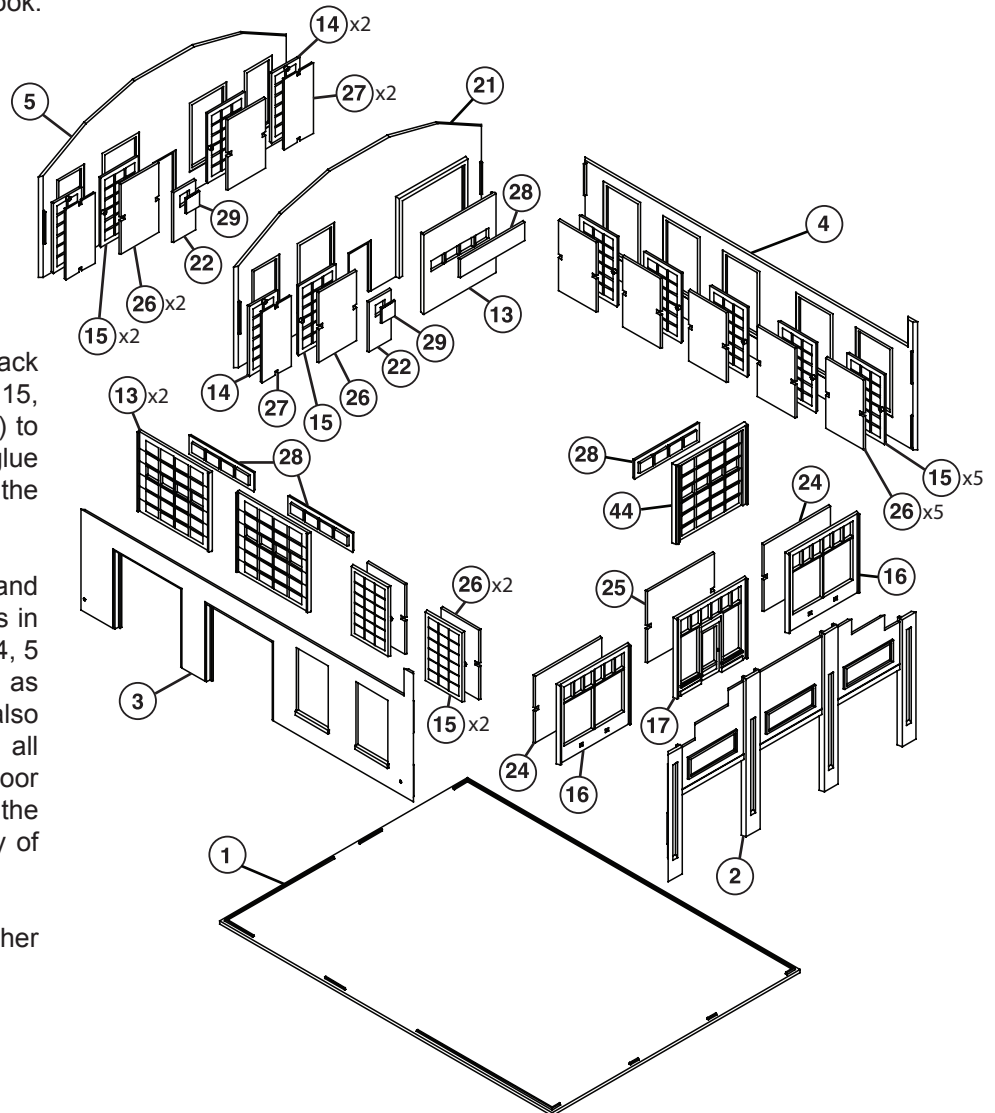

1. Glue "glass" (24, 25, 26, 27) to the back of the respective window frames (16, 17, 15, 14). Glue the overhead door "glass" (28) to the backs of the doors (13, 44). Then glue the small door "glass" (29) to the back of the door (22).

2. Glue the doors (22, 13 or 44) and windows (14, 15, 16, 17) to the openings in the backs of the appropriate walls (2, 3, 4, 5 or 21). Note #1: Choose either #5 or #21 as your back wall. Note #2: You can also customize front wall #2 either install all windows (16 and 17), or one overhead door (44) and two windows (16 or 17) in the openings. The overhead door will fit any of the three openings.

3. Glue the walls (2, 3, 4, 5 or 21) together and to the base (1).

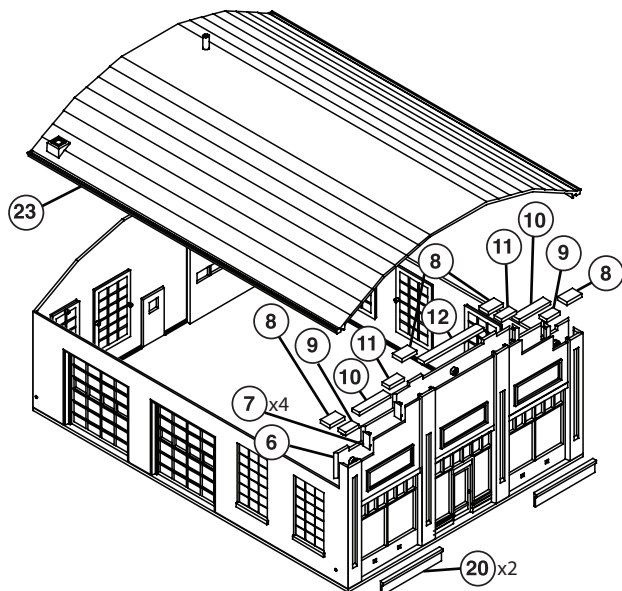

4. Glue the brick insert(s) (20) into the window(s) (16) on the front-wall (2). Glue the front wall back(6) in place. Then glue the four wall corners (7) on. Next glue the wall caps (8, 9, 10, 11, 12) on as illustrated.

5. Glue the roof (23) on.

6. Glue the downspouts (43) into the holes at the bottom of the roof gutters and in the side of the walls.

7. Glue the electric box (42) and electric feed (41) where desired on the back wall.

8. Glue the chimney (18, 19) together and on the roof (23).

9. Place the oil tank (35) along a wall. Note: The opening in the back should go towards the wall.

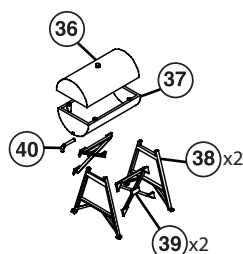
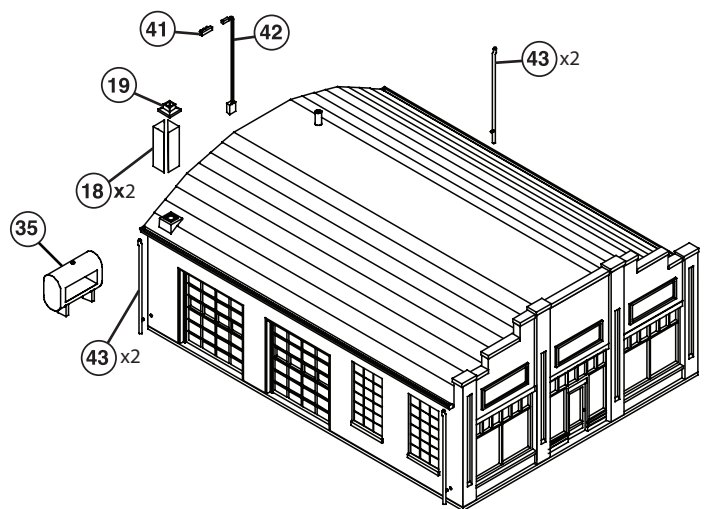

10. Glue the fuel tank (36, 37, 38, 39, 40) together.

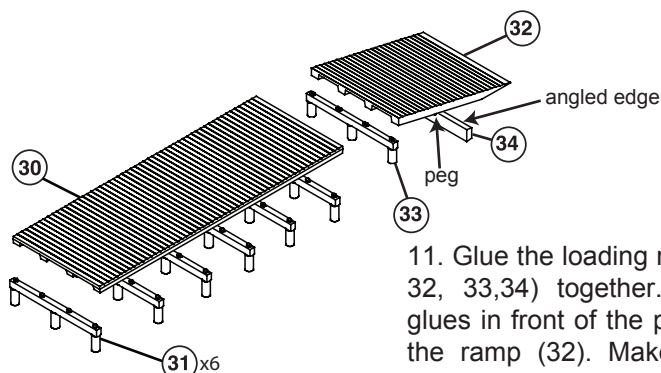

11. Glue the loading ramp/platform (30, 31, 32, 33, 34) together. Note: Support #34 glues in front of the pegs on the bottom of the ramp (32). Make sure that it is the angled edge that is glued to the bottom of the ramp.

DECALING

1. After cutting out the decal, dip in water for 10 seconds, remove and let stand for 1 minute. Slide decal onto surface, position and then blot off any excess water.

2. Lightly brush Micro Sol® on top. This will soften the decal, allowing it to conform to irregular surfaces. DO NOT TOUCH DECAL while wet!

3. When the decal is thoroughly dry, check for any trapped air bubbles. Prick them with the point of a small pin or hobby knife blade and apply more Micro Sol®.